

## **NOTICE OF PUBLIC HEARINGS**

**NOTICE IS HEREBY GIVEN** that the City Council of the City of Reno will hold the below listed public hearing in the Council Chambers of the Reno City Hall, One East First Street, First Floor, on **May 7, 2025**, commencing at the time indicated.

10:00 a.m. – LDC25-00037 (Rancharra Planned Unit Development Master Plan Amendment & Handbook Amendment)

A request has been made for: 1) a Master Plan amendment from Parks, Greenways, and Open Space (PGOS) to Single-Family Neighborhood (SF); and, 2) an amendment to the Rancharra Planned Unit Development (PUD) Handbook to: a) change a  $\pm 7.2$  acre portion of the land use plan from Equestrian Center to Single-Family in order to create Village 8; b) reduce the total number of units from 722 to 469 units; c) modify the objectives of the PUD by removing all references to “equestrian” and “riding facilities”; and d) update the Flexibility section to reflect current RMC processes and other miscellaneous updates to reflect current RMC references. The  $\pm 6.0$  acre Master Plan Amendment site is located west of the intersection of Falabella Way and Silver Charm Way, east of Bartley Ranch Regional Park. The  $\pm 140$  acre PUD is generally located on the northwest corner of Kietzke Lane and Del Monte Lane. The PUD has Master Plan land use designations of PGOS, Single-Family Neighborhood (SF), Large-Lot Neighborhood (LL), and Suburban Mixed-Use (SMU).

Those who wish to submit public comment relative to the above, may do so by submitting public comment through the online public comment form found at [Reno.Gov/PublicComment](http://Reno.Gov/PublicComment) or by email to [PublicComment@reno.gov](mailto:PublicComment@reno.gov). Comments received prior to 4:00 p.m. on the day preceding the meeting will be transcribed, provided to the City Council for review, and entered into the record. Comments received after 4:00 pm on the day preceding the meeting will be provided to the City Council for review prior to adjournment and entered into the record.

**All interested persons are invited to present testimony.**

MIKKI HUNTSMAN, CLERK AND CLERK OF THE RENO CITY COUNCIL



## Order Confirmation

Not an Invoice

|                   |   |
|-------------------|---|
| Account Number:   | 1118454   |
| Customer Name:    | City of Reno - Legals   |
| Customer Address: | City of Reno - Legals<br>1 E 1ST Street FL 2<br>Reno NV 89501 |
| Contact Name:     | Lauren Morris   |
| Contact Phone:    |   |
| Contact Email:    | MorrisL@reno.gov  |
| PO Number:        | LDC25-00037   |

|                    |            |
|--------------------|------------|
| Date:              | 04/17/2025 |
| Order Number:      | 11239669   |
| Prepayment Amount: | \$ 0.00    |

|                   |         |
|-------------------|---------|
| Column Count:     | 1.0000  |
| Line Count:       | 86.0000 |
| Height in Inches: | 8.9000  |

Print

| Product                  | #Insertions | Start - End             | Category            |
|--------------------------|-------------|-------------------------|---------------------|
| RGJ Reno Gazette-Journal | 1           | 04/25/2025 - 04/25/2025 | Govt Public Notices |
| RGJ rgi.com              | 1           | 04/25/2025 - 04/25/2025 | Govt Public Notices |

As an incentive for customers, we provide a discount off the total order cost equal to the 3.99% service fee if you pay with Cash/Check/ACH. Pay by Cash/Check/ACH and save!

|  |          |
|--|----------|
| Total Cash Order Confirmation Amount Due | \$211.08 |
| Tax Amount                               | \$0.00   |
| Service Fee 3.99%                        | \$8.42   |
| Cash/Check/ACH Discount                  | -\$8.42  |
| Payment Amount by Cash/Check/ACH         | \$211.08 |
| Payment Amount by Credit Card            | \$219.50 |

Order Confirmation Amount

\$211.08

Ad Preview

NOTICE OF PUBLIC

HEARINGS

NOTICE IS HEREBY GIVEN that the City Council of the City of Reno will hold the below listed public hearing in the Council Chambers of the Reno City Hall, One East Street, 5th Floor, on May 7, 2025, commencing at the time indicated.

10:00 a.m. - 1:00 p.m. - Ranchorch Planned Unit Development Master Plan Amendment & Handbook

A request has been made for: 1) a Master Plan amendment from Parks, Greenways, and Open Space (PGOS) to Single-Family Neighborhood (SF); and, 2) on amendment to the Ranchorch Planned Unit Development (PUD) Handbook to: a) change a ±72 acre portion of the land use plan from Equestrian Center to Single-Family in order to create Village 8; b) reduce the total number of units from 172 to 69 units; c) modify the existing PUD by removing all references to "equestrian" and "riding facilities"; and d) update the Flexibility section to reflect current RMC processes and other miscellaneous updates to reflect current RMC references. The Amendment site is located west of the intersection of Faldabella Way and Silver Charm Way, east of Bartley Ranch Regional Park. The ±140 acre PUD is generally located on the northwest corner of the intersection of Kaskadee Lane and Del Monte Lane. The PUD has Master Plan land use designations of PGOS, Single-Family Neighborhood (SF), Large-Lot Neighborhood (LL), and Suburban Mixed-Use (SMU). To submit public comment relative to the above, may do so by submitting public comment through the online public comment form found at [Reno.gov/PublicComment](mailto:Reno.gov/PublicComment) or by email to [PublicComment@reno.gov](mailto:PublicComment@reno.gov). Comments received after 4:00 pm on the day preceding the meeting will be provided to the City Council for review prior to adjournment and entered into the record. Comments received after 4:00 pm on the day preceding the meeting will be provided to the City Council for review prior to adjournment and entered into the record. All interested persons are invited to present testimony.

HUNTSMAN, CLERK AND CLERK OF THE RENO CITY COUNCIL  
No. 123669 April 25, 2025



City of Reno - Legals  
1 E 1ST Street FL 2  
Reno, NV 89501  
USA

| Receipt                  |           |
|--------------------------|-----------|
| Account No.:             | 1118454   |
| Receipt No.:             | 5681098   |
| Receipt Date:            | 4/17/2025 |
| Total Cash Amt:          | \$ 211.08 |
| Service Fee 3.99%:       | \$ 8.42   |
| Cash/Check/ACH Discount: | \$ 0.00   |
| Paid Amount:             | \$ 219.50 |

| Date      | Doc Type   | Doc No.  | Customer              | Allocation type | Allocated |
|-----------|------------|----------|-----------------------|-----------------|-----------|
| 4/17/2025 | Order      | 11239669 | City of Reno - Legals | Opp             | 211.08    |
|           | Mastercard |          | 8219                  |                 |           |

| Abbreviation | Document type                         |
|--------------|---------------------------------------|
| Ip           | Invoice Payment                       |
| Pa, Opp      | Payment allocation, Order Pre-payment |

***Thank you for your payment!***

*Thank you for your planning application submittal. The following information is to be populated into the interactive form for public notice as required by Reno Municipal Code. The form will produce a PDF version of the Public Notice sign for you to print and post at the project proposal location. If you have any questions concerning this process, please contact (775) 334-2030.*

To get started go to:

<https://www.reno.gov/government/departments/development-services/planning-and-engineering-applications>

Select the “**Other Resources**” dropdown and select the applicable form for **Public Hearing Notice – City Council**

***Your case is scheduled for the May 7, 2025, City Council Meeting at 10:00 AM.***

***Please enter the meeting date and time, case number, case name and planner’s name into the corresponding fields. Also, you must input the Applicant’s name as listed on the application.***

**CASE NO: LDC25-00037**

**CASE NAME: RANCHARRAH PUD HANDBOOK AMENDMENT & MPA**

**PLANNER: LEAH PICCOTTI**

*Please copy and paste the below project description into the DESCRIPTION field:*

---

**A request has been made for: 1) a Master Plan amendment from Parks, Greenways, and Open Space (PGOS) to Single-Family Neighborhood (SF); and, 2) an amendment to the RancharraH Planned Unit Development (PUD) Handbook to: a) change a ±7.2 acre portion of the land use plan from Equestrian Center to Single-Family in order to create Village 8; b) reduce the total number of units from 722 to 469 units; c) modify the objectives of the PUD by removing all references to “equestrian” and “riding facilities”; and d) update the Flexibility section to reflect current RMC processes and other miscellaneous updates to reflect current RMC references. The ±6.0 acre Master Plan Amendment site is located west of the intersection of Falabella Way and Silver Charm Way, east of Bartley Ranch Regional Park. The ±140 acre PUD is generally located on the northwest corner of Kietzke Lane and Del Monte Lane. The PUD has Master Plan land use designations of PGOS, Single-Family Neighborhood (SF), Large-Lot Neighborhood (LL), and Suburban Mixed-Use (SMU).**

Those who wish to submit public comment relative to the above, may do so by submitting public comment through the online public comment form found at [Reno.Gov/PublicComment](https://www.reno.gov/PublicComment) or by email to [PublicComment@reno.gov](mailto:PublicComment@reno.gov). Comments received prior to 4:00 p.m. on the day preceding the meeting will be transcribed, provided to City Council for review, and entered into the record. Comments received after 4:00 pm on the day preceding the meeting will be provided to the City Council for review prior to adjournment, and entered into the record.

---

*Once you have populated all required fields, please download the form and review it to ensure the posting notice information is complete and correct. This may be printed at a sign shop or copy center of your choosing. Please note that the format is **36 inches wide by 48 inches tall** and must be printed on astrobright yellow paper.*

***Maps of number of postings and posting locations have been provided via email.***

*The public notice sign(s) must be on-site no later than **Friday, April 25, 2025, at 5:00 p.m.***

***Please submit legible photographic proof of posting to our office at 1 East First Street, 2<sup>nd</sup> Floor or via email to [cityclerk@reno.gov](mailto:cityclerk@reno.gov). Signs must be clear and legible.***



RECEIVED

APR 25 2025

CITY CLERK

# PUBLIC NOTICE

A PUBLIC HEARING WILL BE HELD BY THE RENO CITY COUNCIL  
IN THE CITY COUNCIL CHAMBERS AT RENO CITY HALL, 1 EAST  
FIRST STREET, RENO, NEVADA.

HEARING DATE & TIME: WEDNESDAY May 7, 2025 at 10:00 AM

APPLICANT: Wood Rodgers, Inc.

CASE NUMBER: LDC25-00037

PROJECT NAME: RANCHARRAH PUD HANDBOOK AMENDMENT & MPA

**DESCRIPTION:** A request has been made for: 1) a Master Plan amendment from Parks, Greenways, and Open Space (PGOS) to Single-Family Neighborhood (SF); and, 2) an amendment to the Rancharrah Planned Unit Development (PUD) Handbook to: a) change a 27.2 acre portion of the land use plan from Equestrian Center to Single-Family in order to create Village B; b) reduce the total number of units from 722 to 469 units; c) modify the objectives of the PUD by removing all references to "equestrian" and "riding facilities"; and d) update the Flexibility section to reflect current RMC processes and other miscellaneous updates to reflect current RMC references. The 16.0 acre Master Plan Amendment site is located west of the intersection of Falabella Way and Silver Charm Way, east of Bartley Ranch Regional Park. The 140 acre PUD is generally located on the northwest corner of Kietzke Lane and Del Monte Lane. The PUD has Master Plan land use designations of PGOS, Single-Family Neighborhood (SF), Large-Lot Neighborhood (LL), and Suburban Mixed-Use (SMU).

Those who wish to submit public comment relative to the above, may do so by submitting public comment through the online public comment form found at [Reno.Gov/PublicComment](http://Reno.Gov/PublicComment) or by email to [PublicComments@reno.gov](mailto:PublicComments@reno.gov). Comments received prior to 4:00 p.m. on the day preceding the meeting will be transcribed, provided to City Council for review, and entered into the record. Comments received after 4:00 p.m. on the day preceding the meeting will be provided to the City Council for review prior to adjournment, and entered into the record.

Leah Piccotti - 334-2178  
CITY OF RENO  
Development Services Department  
P.O. Box 1950  
Reno, NV 89505

The applicant shall receive this notice 5 days  
after the approval period for the public hearing has expired.





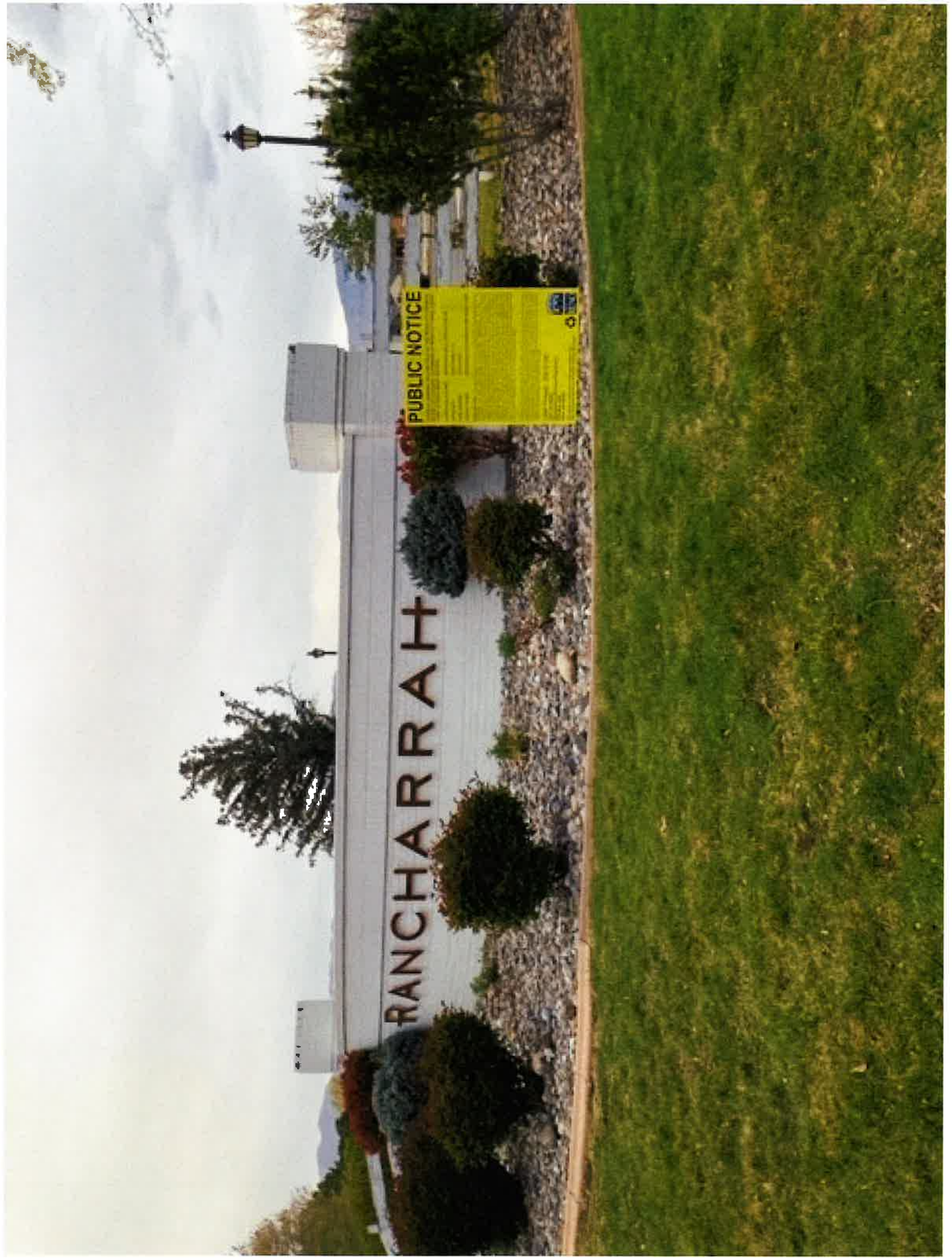



# PUBLIC NOTICE

A PUBLIC HEARING WILL BE HELD BY THE RENO CITY COUNCIL  
IN THE CITY COUNCIL CHAMBERS AT RENO CITY HALL, 1 EAST  
FIRST STREET, RENO, NEVADA.

HEARING DATE & TIME: WEDNESDAY May 7, 2025 at 10:00 AM

APPLICANT: Wood Rodgers, Inc.

CASE NUMBER: LDC25-00037

PROJECT NAME: RANCHARRAH PUD HANDBOOK AMENDMENT & MPA

**DESCRIPTION:** A request has been made for: 1) a Master Plan amendment from Parks, Greenways, and Open Space (PGOS) to Single-Family Neighborhood (SF); and, 2) an amendment to the Rancharrah Planned Unit Development (PUD) Handbook to: a) change a 17.2 acre portion of the land use plan from Equestrian Center to Single-Family in order to create Village 8; b) reduce the total number of units from 722 to 469 units; c) modify the objectives of the PUD by removing all references to "equestrian" and "riding facilities"; and d) update the Flexibility section to reflect current RMC processes and other miscellaneous updates to reflect current RMC references. The 16.0 acre Master Plan Amendment site is located west of the intersection of Felabella Way and Silver Charm Way, east of Bartley Ranch Regional Park. The 146 acre PUD is generally located on the northwest corner of Kietzke Lane and Del Monte Lane. The PUD has Master Plan land use designations of PGOS, Single-Family Neighborhood (SF), Large-Lot Neighborhood (LL), and Suburban Mixed-Use (SMU).

Those who wish to submit public comment relative to the above, may do so by submitting public comment through the online public comment form found at [Reno.Gov/PublicComment](http://Reno.Gov/PublicComment) or by email to [PublicComment@reno.gov](mailto:PublicComment@reno.gov). Comments received prior to 4:00 p.m. on the day preceding the meeting will be transcribed, provided to City Council for review, and entered into the record. Comments received after 4:00 pm on the day preceding the meeting will be provided to the City Council for review prior to adjournment, and entered into the record.

Leah Piccotti - 334-2178

CITY OF RENO  
Development Services Department  
P.O. Box 1900  
Reno, NV 89505

The applicant shall remove this sign within 5 days  
after the appeal period for the public hearing has ended.





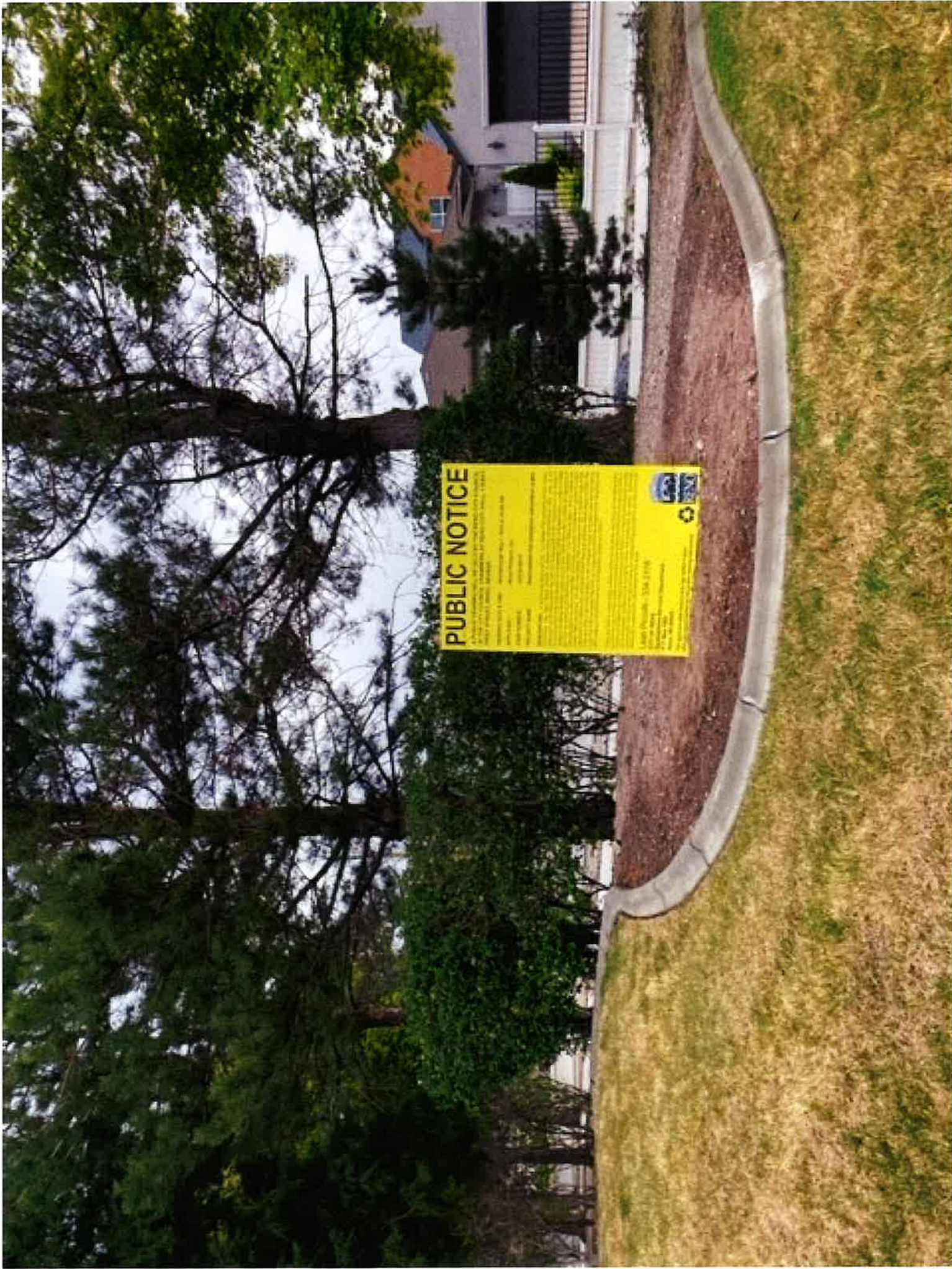



# PUBLIC NOTICE

A PUBLIC HEARING WILL BE HELD BY THE RENO CITY COUNCIL  
IN THE CITY COUNCIL CHAMBERS AT RENO CITY HALL, 1 EAST  
FIRST STREET, RENO, NEVADA.

HEARING DATE & TIME: WEDNESDAY May 7, 2025 at 10:00 AM

APPLICANT: Wood Rodgers, Inc.

CASE NUMBER: LDC25-00037

PROJECT NAME: RANCHARRAH PUD HANDBOOK AMENDMENT & MPA

**DESCRIPTION:** A request has been made for: 1) a Master Plan amendment from Parks, Greenways, and Open Space (PGOS) to Single-Family Neighborhood (SF); and, 2) an amendment to the Rancharrah Planned Unit Development (PUD) Handbook to: a) change a 17.2 acre portion of the land use plan from Equestrian Center to Single-Family in order to create Village 8; b) reduce the total number of units from 722 to 469 units; c) modify the objectives of the PUD by removing all references to "equestrian" and "riding facilities"; and d) update the Flexibility section to reflect current RMC processes and other miscellaneous updates to reflect current RMC references. The 26.0 acre Master Plan Amendment site is located west of the intersection of Faliobella Way and Silver Charm Way, east of Bartley Ranch Regional Park. The ±140 acre PUD is generally located on the northwest corner of Kietzke Lane and Del Monte Lane. The PUD has Master Plan land use designations of PGOS, Single-Family Neighborhood (SF), Large-Lot Neighborhood (LL), and Suburban Mixed-Use (SMU).

Those who wish to submit public comment relative to the above, may do so by submitting public comment through the online public comment form found at [Reno.gov/PublicComment](https://Reno.gov/PublicComment) or by email to [PublicComment@reno.gov](mailto:PublicComment@reno.gov). Comments received prior to 4:00 p.m. on the day preceding the meeting will be transcribed, provided to City Council for review, and entered into the record. Comments received after 4:00 p.m. on the day preceding the meeting will be provided to the City Council for review prior to adjournment, and entered into the record.

Leah Piccotti - 334-2178

CITY OF RENO  
Development Services Department  
P.O. Box 1900  
Reno, NV 89505

The applicant shall remove this sign within 5 days  
after the appeal period for the public hearing has expired.





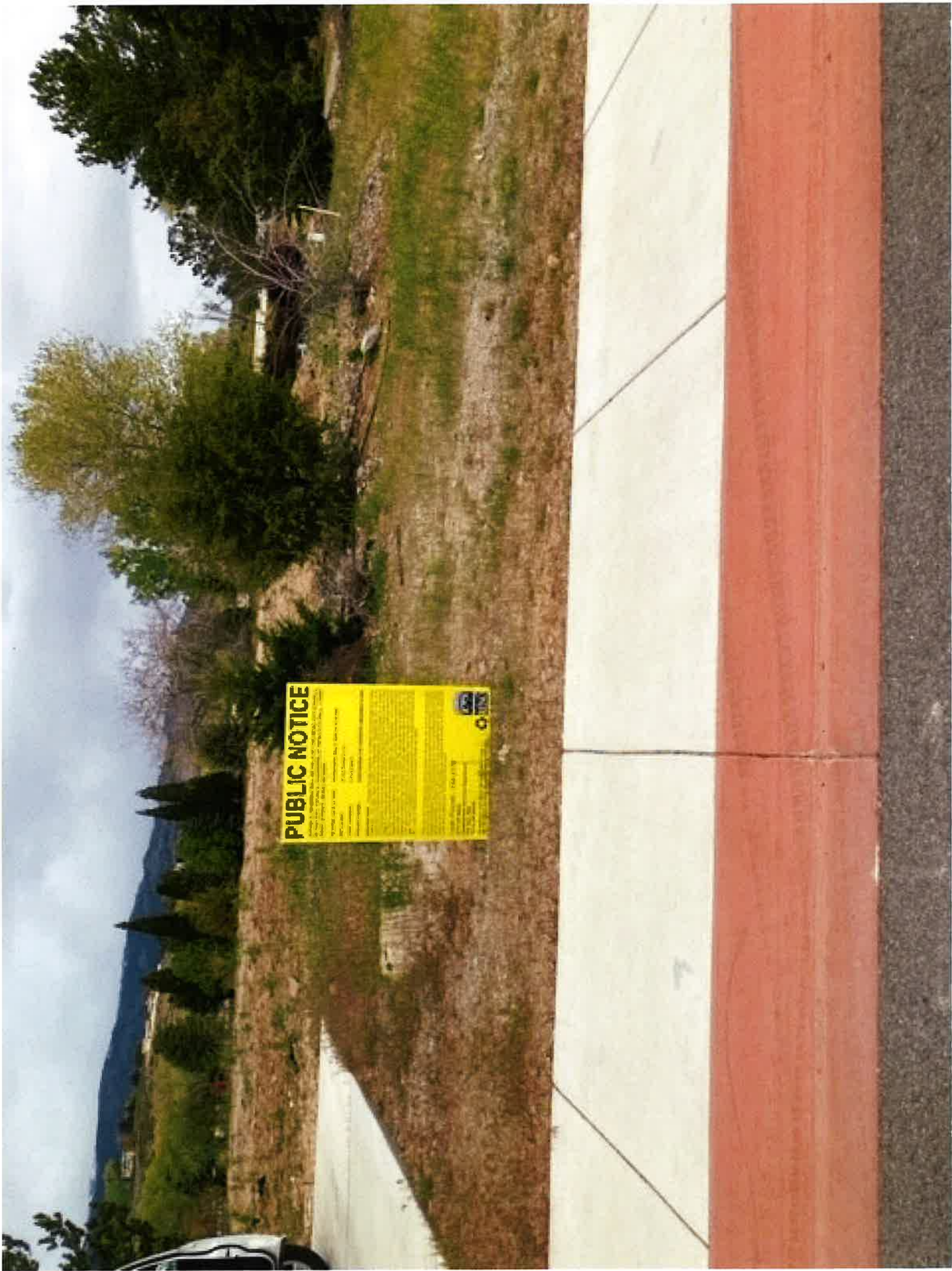

# **PUBLIC NOTICE**

Notice is hereby given that the Board of Directors of the City of [City Name] will hold a public hearing on the [Date] at [Time] in the [Location] to consider the [Project Name] located at [Address]. The project is described as follows: [Project Description]. The project is located on [Property Address]. The project is owned by [Owner Name]. The project is being proposed by [Proposer Name]. The project is being proposed for [Purpose]. The project is being proposed for [Duration]. The project is being proposed for [Location]. The project is being proposed for [Contact Information].





# Site Posting Location

## Rancharrah PUD Amendment & Master Plan Amendment



**AFFIDAVIT OF MAILING**

STATE OF NEVADA     )

:ss.

COUNTY OF WASHOE   )

Mikki Huntsman, being first duly sworn, deposes and says: That at all times hereinafter mentioned she was, and now is, the duly appointed City Clerk of the City of Reno, Washoe County, Nevada; that on the 25<sup>th</sup> day of April, 2025, she deposited in the United States Post Office at Reno, Nevada, copies of the attached postcard "Notice of Public Hearing" on which postage was fully prepaid, addressed to the property owners shown opposite their names, said noticing being marked "Exhibit A" and made a part hereof; that there is a regular communication by mail between the place of mailing and the place addressed; that said attached list contains the names and addresses of all owners of land in Case No. LDC25-00037 (Ranchosah PUD Handbook Amendment & MPA) who are required to be notified by law.

  
CITY CLERK

SUBSCRIBED and SWORN to before me this

25<sup>th</sup> day of APRIL, 2025.

  
Notary Public in and for the County of Washoe,  
State of Nevada

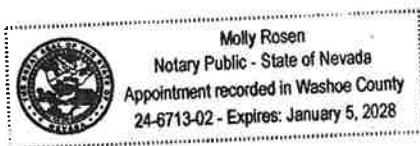





CITY OF RENO  
City Clerk  
PO Box 7  
Reno, Nevada 89504  
RETURN SERVICE REQUESTED

**IMPORTANT NOTICE ABOUT A  
PROJECT NEAR YOUR PROPERTY**

Your Parcel: 040-081-62

**Project Site Map**



RENO CITY OF  
C/O PROPERTY MANAGEMENT  
PO BOX 1900  
RENO, NV 89505



CITY OF RENO  
City Clerk  
PO Box 7  
Reno, Nevada 89504  
RETURN SERVICE REQUESTED

**IMPORTANT NOTICE ABOUT A  
PROJECT NEAR YOUR PROPERTY**

Your Parcel: 040-081-50

**Project Site Map**



WASHOE COUNTY SCHOOL DISTRICT BOARD  
ATTN BUSINESS/CFO  
PO BOX 30425  
RENO, NV 89520

**NOTICE OF PUBLIC HEARING**

**Dear Property Owner:**

**YOU ARE HEREBY NOTIFIED** that the Reno City Council will hold a public hearing on **May 7, 2025, at 10:00 a.m.** in the Council Chambers of City Hall, One East First Street, First Floor, Reno, Nevada, to consider testimony for **LDC25-00037 (Rancharrah Planned Unit Development Master Plan Amendment & Handbook Amendment)**

**A request has been made for: 1) a Master Plan amendment from Parks, Greenways, and Open Space (PGOS) to Single-Family Neighborhood (SF); and, 2) an amendment to the Rancharrah Planned Unit Development (PUD) Handbook to: a) change a ±7.2 acre portion of the land use plan from Equestrian Center to Single-Family in order to create Village 8; b) reduce the total number of units from 722 to 469 units; c) modify the objectives of the PUD by removing all references to “equestrian” and “riding facilities”; and d) update the Flexibility section to reflect current RMC processes and other miscellaneous updates to reflect current RMC references. The ±6.0 acre Master Plan Amendment site is located west of the intersection of Falabella Way and Silver Charm Way, east of Bartley Ranch Regional Park. The ±140 acre PUD is generally located on the northwest corner of Kietzke Lane and Del Monte Lane. The PUD has Master Plan land use designations of PGOS, Single-Family Neighborhood (SF), Large-Lot Neighborhood (LL), and Suburban Mixed-Use (SMU).**

As a property owner within **750 feet**, you are invited to present written or oral testimony relative to the above. If you have any questions, please call **Leah Piccotti, Associate Planner, at (775) 334-2178.**

Those who wish to submit public comment relative to the above, may do so by submitting public comment through the online public comment form found at [Reno.Gov/PublicComment](http://Reno.Gov/PublicComment) or by email to [PublicComment@reno.gov](mailto:PublicComment@reno.gov). Comments received prior to 4:00 p.m. on the day preceding the meeting will be transcribed, provided to City Council for review, and entered into the record. Comments received after 4:00 pm on the day preceding the meeting will be provided to the City Council for review prior to adjournment and entered into the record.

**MIKKI HUNTSMAN, CITY CLERK AND CLERK OF THE CITY COUNCIL OF THE CITY OF RENO**

**NOTICE OF PUBLIC HEARING**

**Dear Property Owner:**

**YOU ARE HEREBY NOTIFIED** that the Reno City Council will hold a public hearing on **May 7, 2025, at 10:00 a.m.** in the Council Chambers of City Hall, One East First Street, First Floor, Reno, Nevada, to consider testimony for **LDC25-00037 (Rancharrah Planned Unit Development Master Plan Amendment & Handbook Amendment)**

**A request has been made for: 1) a Master Plan amendment from Parks, Greenways, and Open Space (PGOS) to Single-Family Neighborhood (SF); and, 2) an amendment to the Rancharrah Planned Unit Development (PUD) Handbook to: a) change a ±7.2 acre portion of the land use plan from Equestrian Center to Single-Family in order to create Village 8; b) reduce the total number of units from 722 to 469 units; c) modify the objectives of the PUD by removing all references to “equestrian” and “riding facilities”; and d) update the Flexibility section to reflect current RMC processes and other miscellaneous updates to reflect current RMC references. The ±6.0 acre Master Plan Amendment site is located west of the intersection of Falabella Way and Silver Charm Way, east of Bartley Ranch Regional Park. The ±140 acre PUD is generally located on the northwest corner of Kietzke Lane and Del Monte Lane. The PUD has Master Plan land use designations of PGOS, Single-Family Neighborhood (SF), Large-Lot Neighborhood (LL), and Suburban Mixed-Use (SMU).**

As a property owner within **750 feet**, you are invited to present written or oral testimony relative to the above. If you have any questions, please call **Leah Piccotti, Associate Planner, at (775) 334-2178.**

Those who wish to submit public comment relative to the above, may do so by submitting public comment through the online public comment form found at [Reno.Gov/PublicComment](http://Reno.Gov/PublicComment) or by email to [PublicComment@reno.gov](mailto:PublicComment@reno.gov). Comments received prior to 4:00 p.m. on the day preceding the meeting will be transcribed, provided to City Council for review, and entered into the record. Comments received after 4:00 pm on the day preceding the meeting will be provided to the City Council for review prior to adjournment and entered into the record.

**MIKKI HUNTSMAN, CITY CLERK AND CLERK OF THE CITY COUNCIL OF THE CITY OF RENO**

# LDC25-00037 Final List

| APN        | First Name           | Last Name                              | Mailing 1                 | Mailing 2                        | City          | State | Zip     |
|------------|----------------------|--|---------------------------|----------------------------------|---------------|-------|---------|
| 040-081-50 |                      | WASHOE COUNTY SCHOOL DISTRICT BOARD    | PO BOX 30425              | ATTN BUSINESS/CFO                | RENO          | NV    | 89520   |
| 040-081-62 |                      | RENO CITY OF                           | PO BOX 1900               | C/O PROPERTY MANAGEMENT          | RENO          | NV    | 89505   |
| 040-134-02 |                      | STATE OF NEVADA                        | 515 E MUSSER ST STE 102   | ATTN BUILDINGS & GROUNDS SECTION | CARSON CITY   | NV    | 89701   |
| 040-134-03 | STEPHEN D & LOUISE M | HALL LIVING TRUST et al                | 14457 BIG BASIN WAY       |                                  | SARATOGA      | CA    | 95070   |
| 040-135-01 | PARVIZ & SHAHLA      | BANAFSHE et al                         | 3652 S VIRGINIA ST STE C7 |                                  | RENO          | NV    | 89502   |
| 040-135-06 |                      | 555 HAMMILL LLC                        | 1333 SECOND ST STE 650    |                                  | SANTA MONICA  | CA    | 90401   |
| 040-135-08 |                      | RJ & CS LLC                            | 501 HAMMILL LN            |                                  | RENO          | NV    | 89511   |
| 040-135-09 |                      | O'GARA PARTNERS                        | 18124 WEDGE PKWY # 1009   |                                  | RENO          | NV    | 89511-8 |
| 040-135-10 | FRANK S & PATRICIA K | ULCH                                   | 2137 CIELO VISTA DR       |                                  | SPARKS        | NV    | 89441   |
| 040-135-12 |                      | MARANATHA WAY LLC                      | 3283 MARANATHA RD         | 513 HAMMILL LN SERIES            | WASHOE VALLEY | NV    | 89704   |
| 040-135-13 |                      | BAR W LLC                              | 4150 LONGKNIFE RD         |                                  | RENO          | NV    | 89519   |
| 040-135-14 |                      | GM LLC                                 | 525 HAMMILL LN            |                                  | RENO          | NV    | 89511   |
| 040-135-15 | JAMES W & EARLENE    | FORSYTHE TRUST                         | 2660 LAKERIDGE SHORES W   |                                  | RENO          | NV    | 89519   |
| 040-142-06 |                      | NEVDEX OFFICE PARK LLC                 | 5310 KIETZKE LN STE 205   |                                  | RENO          | NV    | 89511   |
| 040-142-07 |                      | NEVDEX OFFICE PARK 5340 LLC            | 5310 KIETZKE LN STE 205   |                                  | RENO          | NV    | 89511-2 |
| 040-142-08 |                      | NEVDEX OFFICE PARK 5370 LLC            | 5310 KIETZKE LN STE 205   |                                  | RENO          | NV    | 89511   |
| 040-142-09 |                      | NEVDEX OFFICE PARK 5390 LLC            | 5310 KIETZKE LN STE 205   |                                  | RENO          | NV    | 89511   |
| 040-151-02 | BRUCE & LANDESS      | WITMER FAMILY TRUST                    | 1605 DEL MONTE LN         |                                  | RENO          | NV    | 89511   |
| 040-151-03 |                      | PREMIER TRUST INC FBO BRUCE WITMER IRA | 1605 DEL MONTE LN         |                                  | RENO          | NV    | 89511   |
| 040-151-04 |                      | WASHOE COUNTY                          | 1605 DEL MONTE LN         |                                  | RENO          | NV    | 89512   |
| 040-152-05 | MICHAEL & ANNE M     | MCHARGUE                               | 1250 DEL MONTE LN         | ATTN PARKS & UTILITIES           | RENO          | NV    | 89511   |

LDC25-00037 (Ranchman PUD Handbook Amendment E, MPA)



| APN        | First Name                | Last Name                                     | Mailing 1               | Mailing 2 | City            | State | Zip     |
|------------|---------------------------|---|-------------------------|-----------|-----------------|-------|---------|
| 040-152-06 |                           | DEMAREST II FAMILY TRUST                      | PO BOX 6177             |           | INCLINE VILLAGE | NV    | 89450   |
| 040-152-07 |                           | TERAMO FAMILY TRUST                           | 6460 BROOKVIEW CIR      |           | RENO            | NV    | 89519-7 |
| 040-152-09 | KEAN K                    | CHIN et al                                    | 114 BRIDLEMOOR CT       |           | RENO            | NV    | 89511   |
| 040-152-10 |                           | MYER FAMILY TRUST                             | PO BOX 70247            |           | RENO            | NV    | 89570   |
|            | JOHN W & SUSAN A          |   | 1350 DEL MONTE LN       |           | RENO            | NV    | 89511   |
| 040-152-13 |                           | HARGROVE FAMILY TRUST                         |                         |           |                 |       |         |
| 040-152-17 |                           | OLIVER FAMILY TRUST                           | 1550 DEL MONTE LN       |           | RENO            | NV    | 89511   |
| 040-152-22 | C B                       | MADDOX FAMILY TRUST                           | PO BOX 70577            |           | RENO            | NV    | 89570   |
| 040-152-24 |                           | MILLER FAMILY TRUST                           | 1580 DEL MONTE LN       |           | RENO            | NV    | 89511   |
| 040-152-26 | BRIAN D & DAWN L          | NORMAN  | 880 DEL MONTE LN        |           | RENO            | NV    | 89511   |
| 040-162-31 |                           | UNITARIAN UNIVERSALIST FELLOWSHIP NORTHERN NV | 780 DEL MONTE LN        |           | RENO            | NV    | 89511   |
| 040-162-64 |                           | 5411 KIETZKE LLC                              | 5310 KIETZKE LN # 205   |           | RENO            | NV    | 89511   |
| 040-162-79 |                           | KIETZKE 5420 LLC                              | 1475 TERMINAL WAY STE A | C/O NCS   | RENO            | NV    | 89502   |
|            | ANDREW M & MARY C         | VESCO   | 943 LEAH CIR            |           | RENO            | NV    | 89511   |
| 040-181-01 |                           |   |                         |           |                 |       |         |
| 040-181-02 |                           | MGK PROPERTIES LLC SERIES I                   | 480 GENOVESE LN         |           | RENO            | NV    | 89511   |
| 040-181-03 | CAROL M                   | VOLLMER-JOHNSON                               | 947 LEAH CIR            |           | RENO            | NV    | 89511   |
| 040-181-04 | JAMES M                   | SOLAEGUI                                      | 949 LEAH CIR            |           | RENO            | NV    | 89511   |
| 040-181-05 | STEPHEN & LAUREN          | GIBBS   | 951 LEAH CIR            |           | RENO            | NV    | 89511   |
| 040-181-06 | AINA K                    | TRODDEN                                       | 953 LEAH CIR            |           | RENO            | NV    | 89511   |
| 040-181-07 |                           | PERSON WALSH FAMILY 2019 TRUST                | 955 LEAH CIR            |           | RENO            | NV    | 89511   |
|            | STEVEN II & MARIE-THERESE | KISH  | 957 LEAH CIR            |           | RENO            | NV    | 89511   |
| 040-181-08 |                           |   |                         |           |                 |       |         |
| 040-181-12 | ADAM M & ERIN E           | SUMMERS                                       | 965 LEAH CIR            |           | RENO            | NV    | 89511   |
| 040-181-13 | EDWIN R                   | PERALTA et al                                 | 967 LEAH CIR            |           | RENO            | NV    | 89511   |
| 040-181-14 | ALLEN & HEATHER           | TRYON 2008 LIVING TRUST                       | 969 LEAH CIR            |           | RENO            | NV    | 89511   |
| 040-181-15 | HELEN C                   | TEZAK TRUST                                   | 971 LEAH CIR            |           | RENO            | NV    | 89511   |
| 040-181-31 | RICHARD & JUDITH          | MAUS LIVING TRUST                             | 961 LEAH CIR            |           | RENO            | NV    | 89511   |
| 040-181-32 | LOIS L                    | HUMPHREY et al                                | 963 LEAH CIR            |           | RENO            | NV    | 89511   |
| 040-181-33 | ELIZABETH                 | SPENCER 2015 LIVING TRUST                     | 2340 BLUE CANYON CT     |           | RENO            | NV    | 89523   |
| 040-181-34 |                           | CURATOLO-CHAUVEL TRUST                        | 6123 TORRINGTON DR      |           | RENO            | NV    | 89511   |
| 040-181-35 | PETER & JUSTINE           | ANDERSON                                      | 6125 TORRINGTON DR      |           | RENO            | NV    | 89511   |

| APN        | First Name                | Last Name                         | Mailing 1                        | Mailing 2         | City | State | Zip   |
|------------|---------------------------|-----------------------------------|----------------------------------|-------------------|------|-------|-------|
| 040-181-36 | RENEE P                   | MILLER et al                      | 6127 TORRINGTON DR               |                   | RENO | NV    | 89511 |
| 040-181-37 | CHARLES T &<br>ROBIN S    | BRATLAND 2013 LIVING TRUST        | 6129 TORRINGTON DR               |                   | RENO | NV    | 89511 |
| 040-181-38 |                           | CLIFFORD FAMILY TRUST             | 6131 TORRINGTON DR               |                   | RENO | NV    | 89511 |
| 040-181-39 |                           | FOSNAUGH LIVING TRUST             | 6133 TORRINGTON DR               |                   | RENO | NV    | 89511 |
| 040-181-40 | JEFFREY R                 | GRANT                             | 6135 TORRINGTON DR               |                   | RENO | NV    | 89511 |
| 040-181-41 | AMBER L                   | MOLINO et al                      | 6137 TORRINGTON DR               |                   | RENO | NV    | 89511 |
| 040-181-42 | JOSEPH A &<br>COLLEEN R   | SAIZ                              | 6139 TORRINGTON DR               |                   | RENO | NV    | 89511 |
| 040-182-10 | TERESA L W &<br>STEPHEN C |                                   | 6085 SUNRISE MEADOWS<br>LOOP     |                   | RENO | NV    | 89519 |
| 040-182-11 | BRUCE D & KATHY<br>L      | MAPLES<br>RECTOR                  | 968 LEAH CIR                     |                   | RENO | NV    | 89511 |
| 040-182-12 | NATALIE N                 | YANG                              | 966 LEAH CIR                     |                   | RENO | NV    | 89511 |
| 040-182-13 | JILLIAN L                 | MOLETTIERE                        | 1467 MANHATTAN BEACH BLVD<br># 5 | ANHATTAN<br>BEACH | CA   | 90266 |       |
| 040-182-14 | JOHN & VIRGINIA           | JUETT                             | 960 LEAH CIR                     |                   | RENO | NV    | 89511 |
| 040-182-15 | ANNETTE M                 | WILLIAMS LIVING TRUST             | 956 LEAH CIR                     |                   | RENO | NV    | 89511 |
| 040-182-17 | THEODORE                  | REVIGLIO SEPARATE PROP<br>TRUST   | 4825 ROCK WREN CIR               |                   | RENO | NV    | 89509 |
| 040-182-18 | ALLISON D                 | GEISE et al                       | 948 LEAH CIR                     |                   | RENO | NV    | 89511 |
| 040-182-19 | VALERIE M                 | KILGORE                           | 946 LEAH CIR                     |                   | RENO | NV    | 89511 |
| 040-182-20 | ERIC K                    | KRONAWETTER                       | 944 LEAH CIR                     |                   | RENO | NV    | 89511 |
| 040-182-21 | MAUREEN L                 | MCKISSICK                         | 945 WHEATLAND CT                 |                   | RENO | NV    | 89511 |
| 040-182-22 | RICHMOND                  | BREEN SEPARATE PROP TRUST         | 947 WHEATLAND CT                 |                   | RENO | NV    | 89511 |
| 040-182-23 |                           | KLU PROPERTIES LLC                | 2595 SHARON WAY                  |                   | RENO | NV    | 89509 |
| 040-182-24 | DANIEL                    | STEWART                           | 953 WHEATLAND CT                 |                   | RENO | NV    | 89511 |
| 040-182-25 | JAMES                     | RALEIGH                           | 959 WHEATLAND CT                 |                   | RENO | NV    | 89511 |
| 040-182-26 | JOSEPH G                  | ALFERS et al                      | 961 WHEATLAND CT                 |                   | RENO | NV    | 89511 |
| 040-182-27 | CHRIS R                   | BURKE                             | 969 WHEATLAND CT                 |                   | RENO | NV    | 89511 |
| 040-182-34 |                           | TOMKAT PROPERTIES LLC<br>SERIES 1 | 12635 SILVER WOLF RD             |                   | RENO | NV    | 89511 |
| 040-183-01 |                           | OTT FAMILY TRUST                  | 6142 TORRINGTON DR               |                   | RENO | NV    | 89511 |
| 040-183-02 | DIANE L                   | MACDONALD-COULSON et al           | 3170 COVENT GARDEN DR            |                   | RENO | NV    | 89509 |
| 040-183-03 | NOLAN & ALEXA             | YOUNG                             | 6136 TORRINGTON DR               |                   | RENO | NV    | 89511 |

| APN        | First Name                | Last Name                         | Mailing 1                | Mailing 2                    | City | State | Zip   |
|------------|---------------------------|-----------------------------------|--------------------------|------------------------------|------|-------|-------|
| 040-183-04 |                           | LHN COUGAR LLC                    | 1410 GREG ST STE 403     | C/O LEWIS MANAGEMENT<br>CORP |      | NV    | 89431 |
| 040-183-05 | THOMAS E                  | ORR                               | 6132 TORRINGTON DR       | SPARKS                       |      | NV    | 89511 |
| 040-183-06 | SARAH & STEVEN<br>M       | HOWARD                            | 6130 TORRINGTON DR       | RENO                         | NV   | 89511 |       |
| 040-183-07 | JAMES C                   | GIUDICI                           | 6128 TORRINGTON DR       | RENO                         | NV   | 89511 |       |
| 040-183-08 | NANCY L                   | TOY                               | 6126 TORRINGTON DR       | RENO                         | NV   | 89511 |       |
| 040-183-09 | KEITH D                   | HANSON                            | 6124 TORRINGTON DR       | RENO                         | NV   | 89511 |       |
| 040-421-06 | JANET B                   | LAZARUS                           | 986 RIDGEVIEW DR         | RENO                         | NV   | 89511 |       |
| 040-421-07 | KRISTINA E                | MCCABE                            | 984 RIDGEVIEW DR         | RENO                         | NV   | 89511 |       |
| 040-421-08 |                           | RAGSDALE FAMILY TRUST             | 1015 COUNTRY ESTATES CIR | RENO                         | NV   | 89511 |       |
| 040-421-09 | THOMAS E &<br>MARINA M    | YOUNG                             | 980 RIDGEVIEW DR         | RENO                         | NV   | 89511 |       |
| 040-421-10 | NICHOLAS C                | BELANGER                          | 978 RIDGEVIEW DR         | RENO                         | NV   | 89511 |       |
| 040-421-11 | JIA                       | JINGXIAN                          | 1106 IVY CT              | RENO                         | NV   | 89511 |       |
| 040-421-14 | WILLIAM E &<br>MICHELLE L | MCANDREWS FAMILY TRUST            | 974 RIDGEVIEW DR         | RENO                         | NV   | 89511 |       |
| 040-421-15 | DAVID &<br>PRISCILLA      | DOUCET LIVING TRUST               | 972 RIDGEVIEW DR         | RENO                         | NV   | 89511 |       |
| 040-421-18 | HALEY                     | CLARK et al                       | 968 RIDGEVIEW DR         | RENO                         | NV   | 89511 |       |
| 040-421-19 | MICHELLE                  | RICHARDS LIVING TRUST             | 964 RIDGEVIEW DR         | RENO                         | NV   | 89511 |       |
| 040-421-20 | ANTHONY T                 | ZIMMERMAN                         | 960 RIDGEVIEW DR         | RENO                         | NV   | 89511 |       |
| 040-422-01 | SHAWN                     | STODDARD et al                    | 971 RIDGEVIEW DR         | RENO                         | NV   | 89511 |       |
| 040-422-02 |                           | MORT LIVING TRUST                 | 973 MIRROR LAKE DR       | RENO                         | NV   | 89511 |       |
| 040-422-03 |                           | GILMAN FAMILY TRUST               | 974 MIRROR LAKE DR       | RENO                         | NV   | 89511 |       |
| 040-422-04 | CORA                      | ROBEY LIVING TRUST                | 977 MIRROR LAKE DR       | RENO                         | NV   | 89511 |       |
| 040-422-05 | CHARLES                   | GRUBER et al                      | 979 MIRROR LAKE DR       | RENO                         | NV   | 89511 |       |
| 040-422-06 |                           | JJG PROPERTIES LLC                | 4873 RAMCREEK TRL        | RENO                         | NV   | 89519 |       |
| 040-422-07 |                           | DERBY LIVING TRUST                | 983 MIRROR LAKE DR       | RENO                         | NV   | 89511 |       |
| 040-422-08 | JOSEPH &<br>CAROLYN       | DOYCICH LIVING TRUST              | 985 MIRROR LAKE DR       | RENO                         | NV   | 89511 |       |
| 040-422-09 | JAMES E & KAREN<br>S      | BENNETT FAMILY TRUST              | 987 MIRROR LAKE DR       | RENO                         | NV   | 89511 |       |
| 040-422-10 | BARBARA K                 | SPRING                            | 989 MIRROR LAKE DR       | RENO                         | NV   | 89511 |       |
| 040-422-11 | MARK A                    | ROBERTSON et al                   | 991 MIRROR LAKE DR       | RENO                         | NV   | 89511 |       |
| 040-422-12 | PAUL S                    | CURTIS SEPARATE PROPERTY<br>TRUST | 2191 SANTA YNEZ AVE      | SAN LUIS<br>OBISPO           | CA   | 93405 |       |

| APN        | First Name              | Last Name                  | Mailing 1            | Mailing 2 | City      | State | Zip   |
|------------|-------------------------|----------------------------|----------------------|-----------|-----------|-------|-------|
| 040-422-13 | DONALD E & PATRICIA A   | WEIR et al                 | PO BOX 10840         |           | RENO      | NV    | 89510 |
| 040-422-14 | JUSTIN                  | SMITH                      | 6066 STONECREEK DR   |           | RENO      | NV    | 89511 |
| 040-423-01 | DARIO O                 | DELGADO                    | 996 MIRROR LAKE CT   |           | RENO      | NV    | 89511 |
| 040-423-02 |                         | JUSSEN LIVING TRUST        | 2197 TIVOLI LN       |           | SPARKS    | NV    | 89434 |
| 040-423-03 |                         | MILLER LIVING TRUST        | 992 MIRROR LAKE CT   |           | RENO      | NV    | 89511 |
| 040-423-04 |                         | BRENDLE-BROWN FAMILY TRUST |                      |           | RENO      | NV    | 89511 |
| 040-423-05 |                         | WONG 1999 FAMILY TRUST     | 990 MIRROR LAKE CT   |           | RENO      | NV    | 89511 |
| 040-423-06 | KATHRYN M & KENDALL     | MARSH                      | 988 MIRROR LAKE CT   |           | RENO      | NV    | 89511 |
| 040-423-07 | THOMAS III & CATHERINE  | DUTTON                     | 981 QUAIL HOLLOW DR  |           | RENO      | NV    | 89511 |
| 040-423-08 | CYNTHIA A               | ZAKREVSKY TRUST            | 983 QUAIL HOLLOW DR  |           | RENO      | NV    | 89511 |
| 040-423-09 | D JOSEPH & LOUISE M     | DOUCET 1989 TRUST          | 985 QUAIL HOLLOW DR  |           | RENO      | NV    | 89511 |
| 040-423-10 | GORDON Y C              | CHING TRUST et al          | 6124 GREENBROOK DR   |           | RENO      | NV    | 89511 |
| 040-423-17 | JOHN C & SHAWN B        | ERICKSON                   | 7 LAIMI RD           |           | HONOLULU  | HI    | 96817 |
| 040-424-15 |                         | KIRKHAM FAMILY TRUST       | 6070 STONECREEK DR   |           | RENO      | NV    | 89511 |
| 040-424-16 |                         | BUDHECHA FAMILY TRUST      | 6600 TWIN CITIES RD  |           | ELK GROVE | CA    | 95757 |
| 040-424-17 | JOSEPH M JR             | STUART et al               | 988 QUAIL HOLLOW DR  |           | RENO      | NV    | 89511 |
| 040-424-18 | DAVID A & DEBBIE M      | YOUNGBERG                  | 986 QUAIL HOLLOW DR  |           | RENO      | NV    | 89511 |
| 040-424-19 | JACQUELINE L G          | MCINTIRE                   | 984 QUAIL HOLLOW DR  |           | RENO      | NV    | 89511 |
| 040-424-20 | JESSICA E               | THOMPSON                   | 982 QUAIL HOLLOW DR  |           | RENO      | NV    | 89511 |
| 040-424-22 | DAVID                   | RAMIREZ et al              | 976 MIRROR LAKE DR   |           | RENO      | NV    | 89511 |
| 040-424-23 |                         | D&G LIVING TRUST           | 970 MIRROR LAKE DR   |           | RENO      | NV    | 89511 |
| 040-424-24 | JEREMY & HARMONY        | STEINGREBE                 | 979 RIDGEVIEW DR     |           | RENO      | NV    | 89511 |
| 040-424-25 | MATTHEW A               | JEANOS et al               | 981 RIDGEVIEW DR     |           | RENO      | NV    | 89511 |
| 040-424-26 | ME THI                  | JAMES 2010 TRUST           | 983 RIDGEVIEW DR     |           | RENO      | NV    | 89511 |
| 040-424-27 | SHITA G                 | YENENH                     | 8000 MEADOW VISTA DR |           | RENO      | NV    | 89511 |
| 040-432-03 | A MICHAEL & DOMINIQUE B | KINSLEY                    | 987 RIDGEVIEW DR     |           | RENO      | NV    | 89511 |
| 040-433-02 |                         | BUST YOUR BUTTS TRUST      | 6120 TORRINGTON DR   |           | RENO      | NV    | 89511 |
| 040-433-03 | FRANK K                 | HARNAGEL LIVING TRUST      | 6090 TORRINGTON DR   |           | RENO      | NV    | 89511 |
|            |                         |                            | PO BOX 71268         |           | RENO      | NV    | 89570 |



| APN        | First Name              | Last Name               | Mailing 1           | Mailing 2 | City     | State | Zip   |
|------------|-------------------------|-------------------------|---------------------|-----------|----------|-------|-------|
| 040-433-04 |                         | HUFFMAN LIVING TRUST    | 6086 TORRINGTON DR  |           | RENO     | NV    | 89511 |
| 040-433-05 | DAVID                   | MOORE                   | 6084 TORRINGTON DR  |           | RENO     | NV    | 89511 |
| 040-433-06 | TT                      | ESPERANZA LIVING TRUST  | 6082 TORRINGTON DR  |           | RENO     | NV    | 89511 |
| 040-433-07 |                         | DEPUTY LIVING TRUST     | 6080 TORRINGTON DR  |           | RENO     | NV    | 89511 |
| 040-433-08 | DAWSON &<br>AUDREY      | HECK TRUST              | 6078 TORRINGTON DR  |           | RENO     | NV    | 89511 |
| 040-433-09 | MICHAEL J &<br>EDYTHE L | MELVIN                  | 6076 TORRINGTON DR  |           | RENO     | NV    | 89511 |
| 040-433-10 | ROBERT D & GIGI<br>H    | CHISEL                  | 6074 TORRINGTON DR  |           | RENO     | NV    | 89511 |
| 040-433-11 | MERI K                  | WEST TRUST              | 6072 TORRINGTON DR  |           | RENO     | NV    | 89511 |
| 040-433-12 | GAYLENE &<br>TIMOTHY E  | BALL                    | 6070 TORRINGTON DR  |           | RENO     | NV    | 89511 |
| 040-433-13 |                         | ASR 2024 TRUST          | 3301 S VIRGINIA ST  |           | RENO     | NV    | 89502 |
| 040-433-14 |                         | RAITS FAMILY TRUST      | 6066 TORRINGTON DR  |           | RENO     | NV    | 89511 |
| 040-433-15 | KATHRYN G               | BAKER                   | 6064 TORRINGTON DR  |           | RENO     | NV    | 89511 |
| 040-433-16 | CHAD & SHANNON<br>K     | HARTLEY                 | 6062 TORRINGTON DR  |           | RENO     | NV    | 89511 |
| 040-433-17 | REBEKAH                 | MENES                   | 6060 TORRINGTON DR  |           | RENO     | NV    | 89511 |
| 040-433-18 |                         | ZUCCO FAMILY 2021 TRUST | 6058 TORRINGTON DR  |           | RENO     | NV    | 89511 |
| 040-433-19 | JOEL D & SARAH A        | BATES                   | 6056 TORRINGTON DR  |           | RENO     | NV    | 89511 |
| 040-433-27 | SYDNEY S                | CALDERON                | 6096 TORRINGTON DR  |           | RENO     | NV    | 89511 |
| 040-434-01 | DON                     | HILTON                  | 6062 STONECREEK DR  |           | RENO     | NV    | 89511 |
| 040-434-02 | CARYN L                 | RUBIN TRUST             | 6060 STONECREEK DR  |           | RENO     | NV    | 89511 |
| 040-434-03 |                         | CISAR FAMILY TRUST      | 6057 TORRINGTON DR  |           | RENO     | NV    | 89511 |
| 040-434-04 | PETER A & DEBRA<br>L A  | SAVAGE et al            | 6059 TORRINGTON DR  |           | RENO     | NV    | 89511 |
| 040-434-05 |                         | GARDNER FAMILY TRUST    | 6061 TORRINGTON DR  |           | RENO     | NV    | 89511 |
| 040-434-06 |                         | MALMED II LLC           | 2209 WHITE SANDS DR |           | RENO     | NV    | 89511 |
| 040-434-07 |                         | JUNELL LIVING TRUST     | 6067 TORRINGTON DR  |           | RENO     | NV    | 89511 |
| 040-434-08 | JOSEPH R                | LAWRENCE et al          | 6069 TORRINGTON DR  |           | RENO     | NV    | 89511 |
| 040-434-09 | CINDY L &<br>EDWARD M   | THOMAS                  | 6071 TORRINGTON DR  |           | RENO     | NV    | 89511 |
| 040-434-10 | MINH D                  | NGUYEN                  | 221 EL DORADO DR    |           | PACIFICA | CA    | 94044 |
| 040-434-11 | OLIVIA M                | SWANER TRUST            | 6075 TORRINGTON DR  |           | RENO     | NV    | 89511 |

| APN        | First Name              | Last Name  | Mailing 1                           | Mailing 2              | City             | State | Zip   |
|------------|-------------------------|--|-------------------------------------|------------------------|------------------|-------|-------|
| 040-434-12 | MARK S                  | NOVACEK et al  | 6079 TORRINGTON DR                  |                        | RENO             | NV    | 89511 |
| 040-434-13 | JOSEPH R &<br>CLAUDIA S | ROBERTS  | 6081 TORRINGTON DR                  |                        | RENO             | NV    | 89511 |
| 040-434-14 | MARTIN L JR             | MURRAY   | 6083 TORRINGTON DR                  |                        | RENO             | NV    | 89511 |
| 040-434-15 |                         | STUMPF FAMILY TRUST  | 6085 TORRINGTON DR                  |                        | RENO             | NV    | 89511 |
| 040-434-16 |                         | LYONS FAMILY TRUST   | 6087 TORRINGTON DR                  |                        | RENO             | NV    | 89511 |
| 040-434-17 | NIGEL F & EMILY C       | TEEKASINGH   | 6089 TORRINGTON DR                  |                        | RENO             | NV    | 89511 |
| 040-434-18 | ROBERT A &<br>WHITNEY K | MAIDENS  | 963 RIDGEVIEW DR                    |                        | RENO             | NV    | 89511 |
| 040-434-19 | TYRONE J                | COFFEY   | 969 RIDGEVIEW DR                    |                        | RENO             | NV    | 89511 |
| 040-880-01 |                         | 6630-C MCCARRAN LLC  | 6590 S MCCARRAN BLVD STE A          | C/O AVISON YOUNG       | RENO             | NV    | 89509 |
| 040-880-02 |                         | 6630-B MCCARRAN LLC  | 6590 S MCCARRAN BLVD STE A          | C/O AVISON YOUNG       | RENO             | NV    | 89509 |
| 040-880-05 |                         | LUZON INVESTORS LLC  | 6590 S MCCARRAN BLVD STE A          | C/O AVISON YOUNG       | RENO             | NV    | 89509 |
| 040-880-06 |                         | SINDLINGER CAPITAL LLC   | 8975 DOUBLE DIAMOND PKWY<br>STE A13 |                        | RENO             | NV    | 89521 |
| 040-880-07 |                         | JEFFREY'S PROPERTIES   | 6850 S MCCARRAN BLVD STE 1          |                        | RENO             | NV    | 89509 |
| 040-880-08 |                         | TS MANAGEMENT GROUP INC  | 6800 S MCCARRAN BLVD                |                        | RENO             | NV    | 89509 |
| 040-880-13 |                         | 6630-A MCCARRAN LLC  | 6590 S MCCARRAN BLVD STE A          | C/O AVISON YOUNG       | RENO             | NV    | 89509 |
| 040-880-14 | LEO W                   | KNUF FAMILY TRUST  | 1047 MANOR DR                       |                        | RENO             | NV    | 89509 |
| 040-880-15 |                         | MOJO PROPERTIES LLC  | 6800 S MCCARRAN BLVD                |                        | RENO             | NV    | 89509 |
| 040-880-16 |                         | SOUTH RENO BAPTIST<br>CHURCH TRUST   | 6780 S MCCARRAN BLVD                |                        | RENO             | NV    | 89509 |
| 040-880-20 |                         | CN REALTY GROUP LLC  | 6770 S MCCARRAN BLVD                |                        | RENO             | NV    | 89509 |
| 040-880-21 |                         | MOJO PROPERTIES LLC SERIES<br>D  | 6800 S MCCARRAN BLVD                |                        | RENO             | NV    | 89509 |
| 040-880-22 |                         | MOJO PROPERTIES LLC  | 6790 CHESTERFIELD                   |                        | RENO             | NV    | 89523 |
| 040-880-24 |                         | RENO LAKERIDGE LLC   | 940 EMMETT AVE STE 200              | C/O VILLAGE PROPERTIES | BELMONT          | CA    | 94002 |
| 040-880-25 |                         |  |                                     |                        | RENO             | NV    | 89509 |
| 040-890-04 |                         | QUAIL COURT BUSINESS PARK 6490 S MCCARRAN BLVD BLDG<br>E<br>MAINTENANCE ASSO |                                     |                        | RENO             | NV    | 89511 |
| 040-900-23 |                         | ROSSER FAMILY TRUST  | 1175 DEL MONTE LN                   |                        | NEWPORT<br>BEACH | CA    | 92660 |
| 040-900-24 |                         | SHP VI RANCHARRAH JV LLC   | 5000 BIRCH ST STE 400               |                        | RENO             | NV    | 89509 |
| 040-900-25 |                         | DRAGON I LLC   | 1000 DARTMOUTH DR                   |                        | COTTSDAL         | AZ    | 85251 |
| 040-900-25 |                         | RANCHARRAH SR<br>DEVELOPMENT LLC   | 6710 E CAMELBACK RD STE<br>100      |                        |                  |       |       |

| APN        | First Name          | Last Name                          | Mailing 1                    | Mailing 2                   | City      | State | Zip     |
|------------|---------------------|------------------------------------|------------------------------|-----------------------------|-----------|-------|---------|
| 040-910-01 | LAIF E & CARA       | MEIDELL TRUST                      | 570 HAMMILL LN               |                             | RENO      | NV    | 89511   |
| 040-910-02 |                     | KIENER FAMILY 2005 TRUST           | 530 HAMMILL LN               |                             | RENO      | NV    | 89511   |
| 040-910-03 |                     | TRONDHEIM MANAGEMENT II LLC        | 570 HAMILL LN                |                             | RENO      | NV    | 89511   |
| 040-910-04 |                     | QUAIL VILLAGE II MAINT ASSOC       | 570 HAMMILL LN               | C/O CARA MEIDELL            | RENO      | NV    | 89511   |
| 040-910-05 |                     | TRONDHEIM MANAGEMENT LLC           | 570 HAMMILL LN               |                             | RENO      | NV    | 89511   |
| 040-910-06 |                     | MEIDELL FAMILY TRUST               | 14220 POWDER RIVER CT        |                             | RENO      | NV    | 89511   |
| 040-910-07 |                     | STANDERFER & GRIFFIN LLC           | 590 HAMMILL LN               |                             | RENO      | NV    | 89511   |
| 040-910-08 |                     | QUAIL VILLAGE II MAINT ASSOC       | 5285 COGNAC CT               | C/O ROBERT L DELETT         | RENO      | NV    | 89511   |
| 040-920-01 |                     |                                    | 6490 S MCCARRAN BLVD BLDG E  |                             | RENO      | NV    | 89509   |
| 040-920-02 |                     | QUAIL CORNERS I LLC WFP1 LLC       | 13300 ARROWSPRINGS DR        | C/O RIBEIRO CORP            | RENO      | NV    | 89511   |
| 040-920-06 |                     | MOLLATH FAMILY TRUST               | 2420 MOUNTAIN SPIRIT TRL     |                             | RENO      | NV    | 89523   |
| 040-920-07 | STEPHEN C           | MOLLATH TRUST                      | 6560 S MCCARRAN BLVD STE A   |                             | RENO      | NV    | 89509-6 |
| 040-920-08 |                     |                                    | 6490 S MCCARRAN BLVD BLDG E  | C/O RIBEIRO COMPANY         | RENO      | NV    | 89509   |
| 040-920-10 |                     | LANE HEALTHCARE LLC                | 8095 MEADOW VISTA DR         |                             | RENO      | NV    | 89511   |
| 040-920-11 |                     | GAROL FAMILY TRUST                 | 2435 TRAILS END LN           |                             | RENO      | NV    | 89511   |
| 040-920-12 |                     | POLESELLI 2000 FAMILY TRUST RJ LLC | 6566 S MCCARRAN BLVD STE A   |                             | RENO      | NV    | 89509   |
| 040-920-14 |                     | ALEXIS RAE LLC                     | PO BOX 5247                  |                             | RENO      | NV    | 89513   |
| 040-920-18 |                     | SANDHILL INVESTMENT PROPERTIES LLC | 925 MAPLE CREEK CT           |                             | RENO      | NV    | 89511   |
| 040-920-19 | MICHAEL & PAM       | DOBROWSKI JOINT TRUST              | PO BOX 17975                 |                             | RENO      | NV    | 89511   |
| 040-920-20 |                     | NEVADA STATE DEVELOPMENT CORP      | 1551 DESERT CROSSING CT      | LAS VEGAS                   | NV        | NV    | 89144   |
| 040-920-22 |                     | QUAIL CORNERS ONE                  | 600 S LAS VEGAS BLVD STE 400 |                             | NV        | NV    | 89101   |
| 040-920-23 |                     | RENOWN HEALTH INC                  | 1155 MILL ST MS Z5           | C/O THORNDAL ARMSTRONG DELK | LAS VEGAS | NV    | 89101   |
| 040-920-24 | JOSEPH F & CHARLENE |                                    | 6580 S MCCARRAN BLVD STE D1  | ATTN ACCOUNTS PAYABLE       | RENO      | NV    | 89502   |
| 040-920-26 |                     | KNEDEGEN                           |                              | C/O SIERRA PODIATRY ASSOC   | RENO      | NV    | 89509-6 |
| 040-920-28 |                     | HUTNUT LLC                         | 1441 PULLMAN DR              |                             | SPARKS    | NV    | 89434   |
|            |                     | QUAIL CORNERS MAINTENANCE ASSN     | 6490 S MCCARRAN BLVD BLDG E  |                             | RENO      | NV    | 89509   |



| APN        | First Name | Last Name                             | Mailing 1                   | Mailing 2                                 | City            | State | Zip   |
|------------|------------|---------------------------------------|-----------------------------|---|-----------------|-------|-------|
| 040-920-29 |            | SALTERN INVESTMENTS                   | 6542 S MCCARRAN BLVD STE A  |   | RENO            | NV    | 89509 |
| 040-920-30 |            | 6542 PAIVA LLC                        | 6542 S MCCARRAN BLVD STE B  | C/O DANIEL P GRUBIC                       | RENO            | NV    | 89509 |
| 040-920-31 |            | GYSEN FAMILY TRUST                    | 1400 STONEGATE CT           |   | RDNERVIL        | NV    | 89410 |
| 040-920-32 |            | BOLTON FAMILY TRUST                   | PO BOX 4199                 |   | INCLINE VILLAGE | NV    | 89450 |
| 040-920-33 |            | TAMARISK INVESTMENTS LLC              | 6580 S MCCARRAN BLVD STE B  | C/O MELISSA AMARAL                        | RENO            | NV    | 89509 |
| 040-920-34 |            | JVG PROPERTIES LLC                    | 2745 SPINNAKER DR           |   | RENO            | NV    | 89519 |
| 040-941-01 |            | ACTERRA LLC                           | PO BOX 6539                 |   | RDNERVIL        | NV    | 89460 |
| 040-941-03 |            | EDWARDS & VON RAVENSBURG PROF LLC     | 695 SIERRA ROSE DR          |   | RENO            | NV    | 89511 |
| 040-941-04 |            | CNM QUAIL INC                         | 1475 TERMINAL WAY STE A     | C/O NEVADA COMMERCIAL SERVICES            | RENO            | NV    | 89502 |
| 040-941-05 |            | 689 SIERRA ROSE LLC                   | 6490 S MCCARRAN BLVD BLDG E |   | RENO            | NV    | 89509 |
| 040-941-07 | AUDREY     | GRIVA FAMILY TRUST                    | 5600 HACIENDA RANCH RD      | C/O FRANCES LANE                          | PALMDALE        | CA    | 93551 |
| 040-941-08 |            | LEE HANCOCK CONSTRUCTION INC          | 610 DISCOVERY BAY BLVD      |   | DISCOVERY BAY   | CA    | 94505 |
| 040-941-11 |            | PENN-HAWK PROPERTIES LLC              | 681 SIERRA ROSE DR          |   | RENO            | NV    | 89511 |
| 040-941-12 |            | CITY CREEK RENO LLC                   | PO BOX 750                  |   | RENO            | NV    | 89504 |
| 040-941-13 |            | LIAL ENTERPRISE LLC                   | 4265 ROSS DR                | C/O ALAIN KOVALTCHOUK                     | RENO            | NV    | 89519 |
| 040-941-15 |            | SOILS ORGANIC SOLUTION INC            | 5750 LONE HORSE DR          |   | RENO            | NV    | 89502 |
| 040-941-17 |            | QUAIL CORNERS SOUTH LLC               | 6490 S MCCARRAN BLVD BLDG E | ATTN ATHA KERR                            | RENO            | NV    | 89509 |
| 040-941-21 |            | JOE DOG DOG FOOD LLC                  | 635 SIERRA ROSE DR STE A    |   | RENO            | NV    | 89511 |
| 040-941-23 | TOMAS G    | DEBRUIN et al                         | 631 SIERRA ROSE DR STE A    |   | RENO            | NV    | 89511 |
| 040-941-25 |            | BUS FAMILY TRUST                      | 4285 MEADOWGATE TRL         |   | RENO            | NV    | 89519 |
| 040-941-28 |            | RCI PROPERTIES LLC                    | 590 EUREKA AVE              | C/O RENO DIAGNOSTIC CENTERS- ACCT PAYABLE | RENO            | NV    | 89512 |
| 040-941-36 |            | 601 SIERRA ROSE LLC                   | 2445 FARETTO LN             |   | RENO            | NV    | 89511 |
| 040-941-38 |            | EISSMANN FAMILY TRUST                 | 13400 FIELDCREEK LN         |   | RENO            | NV    | 89511 |
| 040-941-39 |            | BP PROPERTY LTD                       | 605 SIERRA ROSE DR # 4      |   | RENO            | NV    | 89511 |
| 040-941-41 |            | QUAIL CORNERS SOUTH MAINTENANCE ASSOC | 6490 S MCCARRAN BLVD BLDG E |   | RENO            | NV    | 89509 |
| 040-942-01 |            | YI RANCHES LP                         | PO BOX 707                  |   | REEDLEY         | CA    | 93654 |
| 040-942-06 |            | CONKEY & WILSON LTD                   | 620 SIERRA ROSE DR          |   | RENO            | NV    | 89511 |

| APN        | First Name        | Last Name   | Mailing 1                               | Mailing 2                               | City        | State | Zip     |
|------------|-------------------|---|---|---|-------------|-------|---------|
| 040-942-21 |                   | PROVASI 1986 LIVING FAMILY TRUST                                      | 3325 PRESCOTT WAY                       |   | RENO        | NV    | 89509   |
| 040-942-24 |                   | SHI HOLDING COMPANY LLC   | 22 STATE ROUTE 208                      |   | ERINGTON    | NV    | 89447   |
| 040-942-25 |                   | TEAM RAMAN LLC  | 3865 ASPEN HALLOW                       |   | RENO        | NV    | 89511   |
| 040-942-28 |                   | 660 SIERRA ROSE LLC   | 6490 S MCCARRAN BLVD BLDG E             |   | RENO        | NV    | 89509-6 |
| 040-942-29 |                   | QUAIL CORNERS SOUTH-PHASE 3 MAINT ASSN                                | 6490 S MCCARRAN BLVD BLDG E             |   | RENO        | NV    | 89509   |
| 040-942-31 |                   | NEVADA CENTER FOR DERMATOLOGY LLC                                     | 650 SIERRA ROSE DR STE A                |   | RENO        | NV    | 89511   |
| 040-942-32 |                   | NEVADA CENTRE LLC   | 4827 ELKCREEK TRL                       |   | RENO        | NV    | 89519   |
| 040-942-33 |                   | QUAIL CORNERS SOUTH-PHASE 3 MAINTENANCE ASSN OWNERS OF PM 4454 & 4804 | 6490 S MCCARRAN BLVD BLDG 4 COMMON AREA |   | RENO        | NV    | 89502   |
| 040-943-00 |                   |   |   |   | NONE        | NV    | 00000   |
| 040-943-02 | RUPAL V           | SHAH et al  | 4130 RIDGE DR                           |   | LOOMIS      | CA    | 95650   |
| 040-943-03 |                   | QUAIL CORNERS SOUTH BLDG 6490 S MCCARRAN BLVD BLDG N LLC E            |   |   | RENO        | NV    | 89509   |
| 040-943-04 |                   | SIERRA WEIGHT LOSS SOLUTIONS LLC                                      | 10585 CLAIM JUMPER LN                   |   | RENO        | NV    | 89521   |
| 040-943-05 |                   | ROSE OF THE SIERRA LLC  | 12745 SILVER WOLF RD                    |   | RENO        | NV    | 89511   |
| 040-944-02 | JACK S & JOANNA T | ROSS FAMILY TRUST   | 10329 S PENASQUITOS CT                  |   | SPARKS      | NV    | 89441   |
| 040-944-03 |                   | CHILKUR LLC   | PO BOX 9                                |   | CARSON CITY | NV    | 89702   |
| 040-944-04 |                   | MEADOW CREEK MANAGEMENT LLC   | 645 SIERRA ROSE DR STE 205              |   | RENO        | NV    | 89511   |
| 040-951-05 |                   | 6490 MCCARRAN D1 & D2 LLC   | 6490 S MCCARRAN BLVD BLDG E             |   | RENO        | NV    | 89509   |
| 040-951-06 |                   | MCCARRAN QUAIL PARK BLDG 6490 S MCCARRAN BLVD BLDG A B & C LLC E      |   |   | RENO        | NV    | 89509   |
| 040-951-08 |                   | RS EAGLE FEDERAL WAY LLC et al  | 1000 LOWE'S BLVD                        | C/O LOWE'S COMPANIES INC MAIL CODE ZETA | OORESVILL   | NC    | 28117   |
| 040-952-11 |                   | MIDDLEMAS-MEADOWOOD LLC et al   | 142 S SANTA CRUZ AVE STE A              | C/O PREFERRED COMMUNITY MGT INC/GIBSON  | LOS GATOS   | CA    | 95030-6 |
| 040-961-01 |                   | FIRST INDEPENDENT BANK OF NEVADA                                      | PO BOX 11100                            |   | RENO        | NV    | 89510   |



| APN        | First Name           | Last Name                        | Mailing 1                   | Mailing 2           | City         | State | Zip     |
|------------|----------------------|----------------------------------|-----------------------------|---------------------|--------------|-------|---------|
| 040-961-02 |                      | RENO C P LLC                     | 5345 KIETZKE LN STE 100     | C/O ALLIANCE        | RENO         | NV    | 89511   |
| 040-961-03 |                      | SUNSHINE INDUSTRIAL LLC          | 5371 KIETZKE LN             |                     | RENO         | NV    | 89511   |
| 040-961-05 |                      | FABER STREET PROPERTIES LLC      | 1565 TACOMA                 | C/O FRANK C PARCELL | REDWOOD CITY | CA    | 94063   |
| 040-971-05 |                      | MV II LLC                        | 5421 KIETZKE LN STE 200     |                     | RENO         | NV    | 89511   |
| 040-971-06 |                      | AL-MOR PLATINUM LLC              | 3150 ALMADEN EXPY STE 103   |                     | SAN JOSE     | CA    | 95118   |
| 040-972-07 |                      |                                  |                             |                     | LAS VEGAS    | NV    | 89146-6 |
| 040-972-12 |                      | MOUNTAINVIEW CORP CTR OWN ASSC   | 3311 S RAINBOW BLVD STE 225 |                     |              |       |         |
| 226-051-01 |                      | RENO HOSPITALITY LLC             | PO BOX 847                  |                     | CARLSBAD     | CA    | 92018   |
| 226-051-04 |                      | BONDE FARMS HOA                  | 1675 ROBB DR # 5            |                     | RENO         | NV    | 89523   |
| 226-051-05 |                      | HSU FAMILY TRUST                 | 6412 BONDE FARMS LN         |                     | RENO         | NV    | 89511   |
| 226-051-12 |                      | ENDRES FAMILY TRUST              | 6418 BONDE FARMS LN         |                     | RENO         | NV    | 89511   |
| 226-051-15 | ANDREA               | NOLAN                            | 6409 BONDE FARMS LN         |                     | RENO         | NV    | 89511   |
| 226-051-16 |                      | FISHER FAMILY TRUST              | 6400 BONDE FARMS LN         |                     | RENO         | NV    | 89511   |
| 226-061-06 | TRYGVE               | LOKEN FAMILY TRUST               | 6406 BONDE FARMS LN         |                     | RENO         | NV    | 89511   |
| 226-061-16 |                      | RANCHARRAH COMMUNITY ASSOCIATION | 6001 TALBOT LN              |                     | RENO         | NV    | 89509   |
| 226-061-21 |                      | RANCHARRAH HOLDINGS LLC          | 6001 TALBOT LN              |                     | RENO         | NV    | 89509   |
| 226-061-22 | HAKELA L             | FELTON 1997 IRREVOCABLE TRUST    | 3470 GS RICHARDS BLVD       |                     | CARSON CITY  | NV    | 89703   |
| 226-071-02 | JUDITH A             | CLUB AT RANCHARRAH LLC           | 6100 RANCHARRAH PKWY        |                     | RENO         | NV    | 89511   |
| 226-071-03 |                      | BUCKINGHAM TRUST                 | 6124 S PLEASANT OAK TRL     |                     | RENO         | NV    | 89511   |
| 226-071-04 |                      | WULF DAUGHERTY TRUST             | 6122 S PLEASANT OAK TRL     |                     | RENO         | NV    | 89511   |
| 226-071-05 | DONALD G             | PARSONS                          | 6120 S PLEASANT OAK TRL     |                     | RENO         | NV    | 89511   |
| 226-071-06 |                      | RESNIK FAMILY TRUST              | 6118 S PLEASANT OAK TRL     |                     | RENO         | NV    | 89511   |
| 226-071-07 | GEORGE K             | BABA et al                       | 6116 S PLEASANT OAK TRL     |                     | RENO         | NV    | 89511   |
| 226-071-08 |                      | HADDAD FAMILY TRUST              | 6114 S PLEASANT OAK TRL     |                     | RENO         | NV    | 89511   |
| 226-071-09 | PRESTON & PAMELA     | THISTLE LIVING TRUST             | 6112 S PLEASANT OAK TRL     |                     | RENO         | NV    | 89511   |
| 226-071-10 | MARSHALL E & ANGIE   | TOLBERT                          | 6110 S PLEASANT OAK TRL     |                     | RENO         | NV    | 89509   |
| 226-071-11 | CONNIE M             | BAUTER FAMILY TRUST              | 6108 S PLEASANT OAK TRL     |                     | RENO         | NV    | 89511   |
| 226-071-12 | THOMAS W & BARBARA B | KLING TRUST                      | 6106 S PLEASANT OAK TRL     |                     | RENO         | NV    | 89511   |
|            |                      | SMITH TRUST                      | 6104 S PLEASANT OAK TRL     |                     | RENO         | NV    | 89511   |

| APN        | First Name                        | Last Name                                  | Mailing 1               | Mailing 2 | City               | State | Zip     |
|------------|-----------------------------------|--|-------------------------|-----------|--------------------|-------|---------|
| 226-071-13 | DOUGLAS M &<br>CATHERINE E        | PAYNE                                      | 31 SOUTHAMPTON CT       |           | NEWPORT<br>BEACH   | CA    | 92660-4 |
| 226-071-14 |                                   | REED FAMILY TRUST                          | 6100 S PLEASANT OAK TRL |           | RENO               | NV    | 89511   |
| 226-071-16 | ALVIR                             | NAVIN et al                                | 774 MAYS BLVD # 10-680  |           | INCLINE<br>VILLAGE | NV    | 89451   |
| 226-071-17 | HENRY A & ARDIS J                 | MOHRSCHLADT                                | 6501 E EL MARO CIR      |           | PARADISE<br>VALLEY | AZ    | 85253   |
| 226-071-18 |                                   | SIERRA INVESTMENTS I LLC                   | 2710 ALASTOR WAY        |           | RENO               | NV    | 89521   |
| 226-071-19 |                                   | VIJAI SINHA & TAI-PENG LEE<br>LIVING TRUST | 401 ROSEMONT DR         |           | SANTA<br>CLARA     | CA    | 95051   |
| 226-071-20 | KEVIN P                           | MORGAN TRUST                               | 709 W PLEASANT OAK TRL  |           | RENO               | NV    | 89511   |
| 226-071-21 | GIOVANNI                          | COGLITORE et al                            | 9601 LANE GARRETT DR    |           | RENO               | NV    | 89511   |
| 226-071-22 | ANTHONY &<br>TAKESHA              | COOPER                                     | 713 W PLEASANT OAK TRL  |           | RENO               | NV    | 89511   |
| 226-071-23 | DAVE & HOPE                       | JENSEN 1997 TRUST                          | 715 W PLEASANT OAK TRL  |           | RENO               | NV    | 89511   |
| 226-071-24 | JEFFREY F                         | SPRINGMAN et al                            | 717 W PLEASANT OAK TRL  |           | RENO               | NV    | 89511   |
| 226-071-25 | BRITNI & KEVIN                    | JOHNSON                                    | 5925 LAKE GENEVA CT     |           | RENO               | NV    | 89511   |
| 226-071-26 | MARK &<br>CATHERINE               | MAYNARD                                    | 721 W PLEASANT OAK TRL  |           | RENO               | NV    | 89511   |
| 226-071-27 | EDWIN JAN-JIN &<br>JENNIFER CHANG | HSU  | 723 W PLEASANT OAK TRL  |           | RENO               | NV    | 89511   |
| 226-071-28 |                                   | ROBERTS FAMILY EXEMPTION<br>TRUST          | 725 W PLEASANT OAK TRL  |           | RENO               | NV    | 89511   |
| 226-071-29 | BRADLEY                           | LONE WOLVES FAMILY 2020<br>TRUST           | 727 W PLEASANT OAK TRL  |           | RENO               | NV    | 89511   |
| 226-072-01 |                                   | ONELOA LLC SERIES IV                       | 65 BEAR MOUNTAIN PL     |           | RENO               | NV    | 89519   |
| 226-072-02 |                                   | CHRISTENSEN FAMILY TRUST                   | 722 W PLEASANT OAK TRL  |           | RENO               | NV    | 89511   |
| 226-072-03 | JONATHAN &<br>TRICIA              | CHINN TRUST                                | 9681 GISLER DR          |           | UNTINGTO<br>BEACH  | CA    | 92646   |
| 226-072-04 | ROBERT W &<br>LINDSAY R           | PETRICCA                                   | 76121 VIA SATURNIA      |           | INDIAN<br>WELLS    | CA    | 92210-7 |
| 226-072-05 |                                   | GOVIND FAMILY TRUST                        | 716 W PLEASANT OAK TRL  |           | RENO               | NV    | 89511   |
| 226-072-06 | JAMES S & BRENDA<br>L             | GIBSON                                     | 5096 BORDEAUX CT        |           | RENO               | NV    | 89511   |
| 226-072-07 | CAROLYN S                         | KELLY TRUST                                | PO BOX 6294             |           | INCLINE<br>VILLAGE | NV    | 89450   |
| 226-072-08 | RYAN D                            | MILKEN                                     | 105 BRIDLEMOOR CT       |           | RENO               | NV    | 89511   |
| 226-072-09 | THOMAS S                          | DEREGT TRUST                               | 107 BRIDLEMOOR CT       |           | RENO               | NV    | 89511   |
| 226-072-10 |                                   | YOSHIMURA LIVING TRUST                     | 109 BRIDLEMOOR CT       |           | RENO               | NV    | 89511   |

| APN        | First Name             | Last Name                   | Mailing 1            | Mailing 2 | City          | State | Zip     |
|------------|------------------------|-----------------------------|----------------------|-----------|---------------|-------|---------|
| 226-072-11 |                        | JOHNSTON FAMILY TRUST       | 111 BRIDLEMOOR CT    |           | RENO          | NV    | 89511   |
|            | RICHARD & LOU ANN      | CARLSTROM                   | 11 MOMROW TERR       |           | MENANDS       | NV    | 12204   |
| 226-072-12 |                        |                             |                      |           | RENO          | NV    | 89511   |
| 226-072-13 | PETA & JAMES           | ROSS FAMILY TRUST           | 115 BRIDLEMOOR CT    |           | RENO          | NV    | 89511   |
| 226-072-14 | BEJAL & JUSMIN         | PATEL                       | 117 BRIDLEMOOR CT    |           | RENO          | NV    | 89511   |
| 226-073-01 | YU J                   | MIAO et al                  | 114 BRIDLEMOOR CT    |           | RENO          | NV    | 89511   |
| 226-073-02 |                        | WELLS TRUST                 | 110 BRIDLEMOOR CT    |           | RENO          | NV    | 89511   |
| 226-073-03 | PATRICK K F            | LAM et al                   | 16500 SANBORN RD     |           | SARATOGA      | CA    | 95070   |
| 226-073-04 | LILLIAN                | WONG                        | 106 BRIDLEMOOR CT    |           | RENO          | NV    | 89511   |
|            |                        |                             | 2614 MATRINO CIR     |           | ENDERSON      | NV    | 89052   |
| 226-073-05 | KENNETH R & CELESE M   | BELL 2009 TRUST             |                      |           | RENO          | NV    | 89511   |
| 226-073-06 | THOMAS M               | DOBRY LIVING TRUST et al    | 205 CRIOLLO CT       |           | RENO          | NV    | 89511   |
| 226-073-07 |                        | PETERSEN TRUST              | 207 CRIOLLO CT       |           | RENO          | NV    | 89511   |
| 226-073-08 | ANDREW B               | GADDIS                      | 16735 ROUGE CT       |           | RENO          | NV    | 89511   |
| 226-073-09 |                        | MACDONALD FAMILY 1998 TRUST | 213 CRIOLLO CT       |           | RENO          | NV    | 89511   |
| 226-073-10 | DANIEL & ALEXIA        | PORTILLO 2016 TRUST         | 210 CRIOLLO CT       |           | RENO          | NV    | 89511   |
| 226-073-11 |                        | DWC TRUST                   | 208 CRIOLLO CT       |           | RENO          | NV    | 89511   |
| 226-073-12 | CHRIS & KRISTINA       | CARDEN                      | 206 CRIOLLO CT       |           | RENO          | NV    | 89511   |
| 226-073-13 | JOHN & KATHRYN         | MADDALON FAMILY TRUST       | 200 CRIOLLO CT       |           | RENO          | NV    | 89511   |
| 226-073-14 |                        | DBB HOLDINGS INC            | PO BOX 18087         |           | RENO          | NV    | 89511   |
| 226-073-15 |                        | SHACKNV LLC                 | 3653 SPIRIT BLIFF CT |           | RENO          | NV    | 89511   |
| 226-073-16 |                        | MALIBU55 INC                | 309 MAREWOOD CT      |           | RENO          | NV    | 89511   |
| 226-074-01 |                        | STOLLMAYER FAMILY TRUST     | 9106 WILD SKIES WAY  |           | RENO          | NV    | 89523-9 |
|            |                        |                             | 725 MAREWOOD TRL     |           | RENO          | NV    | 89511   |
| 226-074-02 | WALTER C & STEPHANIE J | RUNDIN 2018 LIVING TRUST    | 6122 TRIPLE CROWN DR |           | RENO          | NV    | 89511   |
| 226-074-03 | COLIN J                | BURNS                       | 13042 FLINT DR       |           | SANTA ANA     | CA    | 92705   |
| 226-074-04 |                        | DLKC INVESTMENTS LLC        |                      |           | RENO          | NV    | 89511   |
| 226-074-05 | SHANE                  | GRAHN                       | 6118 TRIPLE CROWN DR |           | SAFETY HARBOR | FL    | 34695   |
| 226-074-06 | JACK & KERRY           | MOORE                       | 506 CREEKSIDE CT     |           | RENO          | NV    | 89511   |
| 226-074-07 | LORI J & FREDERICK H   | SAVIDGE                     | 6114 TRIPLE CROWN DR |           | RENO          | NV    | 89511   |
| 226-074-08 |                        | WHITTAKER FAMILY TRUST      | 6112 TRIPLE CROWN DR |           | RENO          | NV    | 89511   |
| 226-074-09 | ERIC W                 | SNYDER                      | 6110 TRIPLE CROWN DR |           | RENO          | NV    | 89511   |
| 226-074-10 |                        | RCH TRIPLE C LLC            | 2928 FOREST AVE      |           | BERKELEY      | CA    | 94705   |



| APN        | First Name           | Last Name                                   | Mailing 1               | Mailing 2                            | City            | State | Zip   |
|------------|----------------------|---|-------------------------|--------------------------------------|-----------------|-------|-------|
| 226-074-11 |                      | SVITENKO FAMILY TRUST                       | 6106 TRIPLE CROWN DR    |                                      | RENO            | NV    | 89511 |
| 226-074-12 | LINDSAY              | GAMBIT                                      | 54 EVVIE CT             |                                      | ENDERSON        | NV    | 89012 |
| 226-074-13 |                      | MRPS HOLDINGS II LLC                        | 1250 4TH ST FL 5        |                                      | SANTA MONICA    | CA    | 90401 |
| 226-074-14 |                      | LATIGO MT LLC                               | 9101 ALTA DR STE 107    |                                      | LAS VEGAS       | NV    | 89145 |
| 226-074-15 |                      | RAS FAMILY TRUST                            | 5513 WESTERN RIDER TRL  |                                      | RENO            | NV    | 89511 |
| 226-074-16 | MANI                 | SALAMAT et al                               | 17197 STILLWOOD LN      |                                      | FAIRHOPE        | AL    | 36532 |
| 226-074-17 |                      | OLECHOWSKI FAMILY TRUST                     | 6107 S PLEASANT OAK TRL |                                      | RENO            | NV    | 89511 |
| 226-074-18 | CHRISTINE C H        | DUEKER                                      | 1226 OAKVIEW CT         |                                      | ANOKA           | MIN   | 55303 |
| 226-074-19 |                      | BURT FAMILY TRUST                           | 6111 S PLEASANT OAK TRL |                                      | RENO            | NV    | 89511 |
| 226-074-20 |                      | HOWARD K H LEUNG & ELLEN W Y LIU 1999 TRUST |                         |                                      | RENO            | NV    | 89511 |
| 226-074-21 | LUKE & CHRISTINE     | BRAUD                                       | 6113 S PLEASANT OAK TRL |                                      | RENO            | NV    | 89511 |
| 226-074-22 |                      | DECOTA FAMILY TRUST                         | 6115 S PLEASANT OAK TRL |                                      | RENO            | NV    | 89511 |
| 226-074-23 | DENISE               | MCLAUGHLAN LIVING TRUST                     | 6117 S PLEASANT OAK TRL |                                      | INCLINE VILLAGE | NV    | 89450 |
|            |                      |   | PO BOX 4724             |                                      |                 |       |       |
| 226-074-24 | DAVID & JULIE        | WONG TRUST                                  | 6121 S PLEASANT OAK TRL |                                      | RENO            | NV    | 89511 |
| 226-074-25 | CATHERINE E          | KAUFER 2023 TRUST                           | 721 MAREWOOD TRL        |                                      | RENO            | NV    | 89511 |
| 226-081-01 |                      | MARKHAM FAMILY 2022 TRUST                   | 306 MAREWOOD CT         |                                      | RENO            | NV    | 89511 |
| 226-081-02 |                      | MORAN TRUST                                 | 300 MAREWOOD CT         |                                      | RENO            | NV    | 89511 |
|            |                      |   | PO BOX 18127            |                                      | RENO            | NV    | 89511 |
| 226-081-03 | GERALD W & FABIOLO A | BAUGHMAN                                    |                         |                                      |                 |       |       |
| 226-081-04 | ROGER R              | REINKE TRUST                                | 6145 TRIPLE CROWN DR    |                                      | RENO            | NV    | 89511 |
| 226-081-05 |                      | DESIMONI TRUST                              | 31527 SUNNY BANKS CT    |                                      | FULSHEAR        | TX    | 77441 |
|            |                      |   | 348 JAMES MCIVER        |                                      | TRUCKEE         | CA    | 96161 |
| 226-081-06 | TERRANCE & BEVERLY   | RUST FAMILY TRUST                           |                         |                                      |                 |       |       |
| 226-081-07 |                      | KROMER FAMILY TRUST                         | 6157 TRIPLE CROWN DR    |                                      | RENO            | NV    | 89511 |
| 226-081-08 | LYNN W & TAMARA      | KENDELL                                     | 3690 SUMMIT DR          |                                      | POCATELLO       | ID    | 83201 |
| 226-081-09 | JAMES R              | COLGAN FAMILY TRUST                         | 6165 TRIPLE CROWN DR    |                                      | RENO            | NV    | 89511 |
| 226-081-10 |                      | RENO CANTER WAY LLC                         | 730 CANTER WAY          |                                      | RENO            | NV    | 89511 |
| 226-081-11 |                      | SKOW/MILLER TRUST                           | 728 CANTER WAY          |                                      | RENO            | NV    | 89511 |
| 226-081-12 |                      | VCH NEVADA LLC                              | 855 MAESTRO DR STE C    |                                      | RENO            | NV    | 89511 |
| 226-081-13 | GUILA D              | TURVILLE LIVING TRUST                       | PO BOX 7097             | C/O JOHN DERMODY VENTURES ATTN: TONI | RENO            | NV    | 89510 |
| 226-082-01 |                      | JELINEK FAMILY TRUST                        | 6131 FALABELLA WAY      |                                      | RENO            | NV    | 89511 |
| 226-082-02 |                      | IACONIS CAGE TRUST                          | 6135 FALABELLA WAY      |                                      | RENO            | NV    | 89511 |

| APN        | First Name                | Last Name                           | Mailing 1                                  | Mailing 2 | City                                     | State          | Zip     |
|------------|---------------------------|-------------------------------------|--|-----------|--|----------------|---------|
| 226-082-04 |                           | TOMAC FAMILY TRUST                  | 4445 JUNIPER TRL                           |           | RENO                                     | NV             | 89519   |
| 226-082-05 | RAJEEV                    | DEWAN LIVING TRUST                  | 3064 GARIBALDI DR                          |           | ROSEVILLE                                | CA             | 95747   |
| 226-082-06 | DAVID & JENNIFER          | LEE                                 | 6147 FALABELLA WAY                         |           | RENO                                     | NV             | 89511-8 |
| 226-082-07 |                           | LARIAT BUILDERS LLC                 | 11575 VERAZE DR                            |           | RENO                                     | NV             | 89521   |
|            |                           |                                     | 6155 FALABELLA WAY                         |           | RENO                                     | NV             | 89511   |
| 226-082-08 | ROBERT C &<br>CHRISTINE M | KAHN LIVING TRUST                   |  |           |  |                |         |
| 226-082-09 | DEAN & STACEY             | RICHARDS                            | 2153 JARROD CT                             |           | SIMI<br>VALLEY                           | CA             | 93063   |
| 226-082-10 |                           | BERNARD FAMILY TRUST                | 2500 E LAKERIDGE SHORES                    |           | RENO                                     | NV             | 89519   |
|            |                           |                                     | 7150 SUNRIVER CT                           |           | RENO                                     | NV             | 89523   |
| 226-082-12 | MICHAEL K &<br>ALICE E    | MCQUONE                             |  |           | RENO                                     | NV             | 89511   |
| 226-082-13 |                           | GAGNE TRUST                         | 6144 TRIPLE CROWN DR                       |           | RENO                                     | NV             | 89519   |
| 226-082-14 | MICHAEL C                 | DERMODY TRUST                       | 4795 CAUGLIN PKWY STE 100                  |           | RENO                                     | NV             | 89511   |
| 226-082-15 | LESLIE A                  | DUNN LIVING TRUST                   | 726 MAREWOOD TRL                           |           | RENO                                     | NV             | 89511   |
| 226-082-16 | YUJIE                     | MIAO                                | 114 BRIDLEMOOR CT                          |           | RENO                                     | NV             | 89511   |
| 226-082-17 | KEAN                      | CHIN et al                          | 114 BRIDLEMOOR CT                          |           | RENO                                     | NV             | 89511   |
| 226-082-18 |                           |                                     | 59 DAMONTE RANCH PKWY #<br>B-215           |           | RENO                                     | NV             | 89511   |
| 226-082-19 |                           | KELLER FAMILY TRUST                 |  |           | RENO                                     | NV             | 89511   |
|            |                           | R & G TRUST                         | 718 MAREWOOD TRL                           |           | RENO                                     | NV             | 89511   |
| 226-091-01 |                           | ALONGI FAMILY TRUST                 | 6136 FALABELLA WAY                         |           | RENO                                     | NV             | 89511   |
| 226-091-02 |                           |                                     | 11100 SANTA MONICA BLVD<br>STE 1150        |           |  | CA             | 90025   |
|            |                           | 14TH GREEN DRIVE LLC                |  |           | C/O ET CONSULTANTS -<br>DEBORAH LUTZ MGR | LOS<br>ANGELES |         |
| 226-091-03 |                           | BEAM FAMILY TRUST                   | 6144 FALABELLA WAY                         |           | RENO                                     | NV             | 89511   |
| 226-091-04 |                           | BROWN FAMILY LIVING TRUST           | 6152 FALABELLA WAY                         |           | RENO                                     | NV             | 89511   |
| 226-091-05 | JON & JOANNE              | THOMAS LIVING TRUST                 | 3148 VISTA FAVOLOSO                        |           | RENO                                     | NV             | 89519   |
| 226-091-06 |                           | AUTUMN IRREVOCABLE TRUST            | 9101 ALTA DR UNIT 107                      |           | LAS VEGAS                                | NV             | 89145   |
| 226-091-07 |                           | BOUTTE MANAGEMENT TRUST             | 575 LAKESHORE BLVD                         |           | INCLINE<br>VILLAGE                       | NV             | 89451   |
| 226-091-09 | PAMELA S                  | DOLAN FAMILY TRUST                  | 617 SILVER CHARM WAY                       |           | RENO                                     | NV             | 89511   |
| 226-091-10 | MICHELE C                 | BROWN 2009 TRUST                    | 340 STOCKTON ST # 1702                     |           | SAN<br>FRANCISCO                         | CA             | 94108   |
| 226-091-11 |                           | RANCHARAH MT LLC                    | 9101 ALTA DR # 107                         |           | LAS VEGAS                                | NV             | 89145   |
| 226-091-13 |                           | LANDAUER SEPARATE<br>PROPERTY TRUST |  |           | RENO                                     | NV             | 89519   |
| 226-091-14 | JEFFREY K<br>SCOTT W      | FITZPATRICK                         | 4843 ELKCREEK TRL                          |           | RENO                                     | NV             | 89511   |
| 226-091-15 |                           | JORDAN TRUST                        | 6113 RANCHARAH PKWY<br>6107 RANCHARAH PKWY |           | RENO                                     | NV             | 89511   |

| APN        | First Name            | Last Name   | Mailing 1                                  | Mailing 2           | City             | State | Zip     |
|------------|-----------------------|---|--|---------------------|------------------|-------|---------|
| 226-091-16 | PATRICK               | NOVAK TRUST   | 5150 MAE ANNE AVE STE 405<br>PMB 3018      |                     | RENO             | NV    | 89523   |
| 226-091-18 |                       | BLAYLOCK FAMILY TRUST                                   | 748 SOUTH MEADOWS PKWY<br>UNIT A9-338      |                     | RENO             | NV    | 89521   |
| 226-091-19 | DAVID B               | CLARK   | 220 AVENUE I                               |                     | REDONDO<br>BEACH | CA    | 90277   |
| 226-091-20 | PATRICK               | NOVAK TRUST   | 5150 MAE ANN AVE                           |                     | RENO             | NV    | 89523   |
| 226-091-22 |                       | RH CUSTOM LLC   | 600 S ARLINGTON AVE STE<br>100             | C/O MICHAEL MARDIAN | RENO             | NV    | 89509   |
| 226-091-23 | MICHAEL J             | ANDERSON et al  | 4282 QUEEN AVE S                           |                     | INNEAPOLI        | MIN   | 55410   |
| 226-101-01 |                       | COX MCELHINNEY FAMILY<br>TRUST                          | 645 BRAIDED ROPE DR<br>641 BRAIDED ROPE DR |                     | RENO             | NV    | 89511   |
| 226-101-02 | LANCE J & JOANNE<br>R | EKLUND FAMILY TRUST<br>WEBSTER & CURRY LIVING<br>TRUST  | 637 BRAIDED ROPE DR                        |                     | RENO             | NV    | 89511-8 |
| 226-101-03 |                       | STEPHEN R SMOLAK & JANET L<br>PARRY-SMOLAK FAMILY TRUST | 633 BRAIDED ROPE DR                        |                     | RENO             | NV    | 89511   |
| 226-101-04 |                       | ALDRICH LIVING TRUST                                    | 629 BRAIDED ROPE DR                        |                     | RENO             | NV    | 89511   |
| 226-101-05 | PHILIP & KIM          | RICH  | 6835 WINDY HILL WAY                        |                     | RENO             | NV    | 89519   |
| 226-101-06 |                       | ADCOCK/LACHTMAN FAMILY<br>TRUST                         | 4790 CAUGHLIN PKWY # 125                   |                     | RENO             | NV    | 89511   |
| 226-101-07 | BRAD & SUSAN          | HOGAN TRUST   | 617 BRAIDED ROPE DR                        |                     | RENO             | NV    | 89511   |
| 226-101-08 | MICHAEL P             | GRATZ et al   | 613 BRAIDED ROPE DR                        |                     | RENO             | NV    | 89511   |
| 226-101-09 |                       | IBANEZ FAMILY TRUST                                     | 8830 CHAMBRAY RD                           |                     | ELK GROVE        | CA    | 95624   |
| 226-101-10 | ALEX & LUDMILA        | POLOVINIKIN   | 1334 QUAIL CREEK CIR                       |                     | SAN JOSE         | CA    | 95120   |
| 226-101-11 |                       | FLYNN FAMILY TRUST                                      | 11224 PASEO DORADO                         |                     | PORTER<br>RANCH  | CA    | 91326   |
| 226-101-12 |                       |   |  |                     | RENO             | NV    | 89511   |
| 226-101-13 | LINDA S               | RUTLEDGE TRUST  | 5533 WESTERN RIDER TRL                     |                     | LENBROOK         | NV    | 89413   |
| 226-101-14 | CLAUDIA & DAVE        | THOMPSON  | PO BOX 382                                 |                     | RENO             | NV    | 89511   |
| 226-101-15 |                       | GISKO FAMILY TRUST                                      | 1155 W HUFFAKER LN                         |                     | RENO             | NV    | 89511   |
| 226-101-16 |                       | ACKER LIVING TRUST                                      | 5521 WESTERN RIDER TRL                     |                     | RENO             | NV    | 89511   |
| 226-101-17 | DONALD C &<br>WANDA   | DUNBAR  | 5517 WESTERN RIDER TRL                     |                     | RENO             | NV    | 89511   |
| 226-101-18 | LYNN A                | MARTIN TRUST  | 2000 BAY HILL DR                           |                     | LAS VEGAS        | NV    | 89117   |
| 226-101-19 | CARYN COE             | SWOBE LIVING TRUST                                      | 5509 WESTERN RIDER TRL                     |                     | RENO             | NV    | 89511   |
| 226-101-20 | CHRISTI               | MATEONI TRUST   | 5505 WESTERN RIDER TRL                     |                     | RENO             | NV    | 89511   |
| 226-101-21 |                       | BROWN SURVIVORS TRUST                                   | 1013 HARRINGTON WAY                        |                     | ARMICHAEL        | CA    | 95608   |



| APN        | First Name            | Last Name                        | Mailing 1   | Mailing 2         | City       | State | Zip   |
|------------|-----------------------|----------------------------------|---|-------------------|------------|-------|-------|
| 226-101-23 |                       |                                  |   |                   |            | NV    | 89521 |
|            |                       | RANCHARRAH COMMUNITY ASSOCIATION | 9190 DOUBLE DIAMOND PKWY C/O THE MANAGEMENT TRUST   | STE 112<br>- RENO | RENO       |       |       |
| 226-102-01 | JOHN M & YVETTE M     | CHRISTENSEN                      | 5500 DAPPLEGRAY WAY                                 |                   | RENO       | NV    | 89511 |
| 226-102-02 | KENT & HIMANI         | WILLIAMS                         | 5506 DAPPLEGRAY WAY                                 |                   | RENO       | NV    | 89511 |
| 226-102-03 | FRANK & JOANNE        | CELECIA                          | 5512 DAPPLEGRAY WAY                                 |                   | RENO       | NV    | 89511 |
| 226-102-04 |                       | SMITH FAMILY TRUST               | 5518 DAPPLEGRAY WAY                                 |                   | RENO       | NV    | 89511 |
| 226-102-05 | AMY                   | SCHOEN et al                     | 5524 DAPPLEGRAY WAY                                 |                   | RENO       | NV    | 89511 |
| 226-102-06 |                       | HECOX/MCKISSON TRUST             | 1155 MERRILL ST # 308                               |                   | MENLO PARK | CA    | 94025 |
| 226-102-07 | CATHERINE A           | CARDWELL et al                   | 5536 DAPPLEGRAY WAY                                 |                   | RENO       | NV    | 89511 |
| 226-102-08 | FRANCIS P & KAREN A S | NOTZ                             | 5542 DAPPLEGRAY WAY                                 |                   | RENO       | NV    | 89511 |
| 226-102-09 | FABIO G               | REGINATO FAMILY TRUST            | 5548 DAPPLEGRAY WAY                                 |                   | RENO       | NV    | 89511 |
| 226-102-10 | S R                   | NEIL LIVING TRUST                | 18124 WEDGE PKWY # 508                              |                   | RENO       | NV    | 89511 |
| 226-102-11 | SUZANNE               | FULLER FAMILY TRUST              | 5560 DAPPLEGRAY WAY                                 |                   | RENO       | NV    | 89511 |
| 226-103-01 | BRENDA                | SCOLARI                          | 5557 DAPPLEGRAY WAY                                 |                   | RENO       | NV    | 89511 |
| 226-103-02 | NINAD                 | BHAMBURDEKAR et al               | 5545 DAPPLEGRAY WAY                                 |                   | RENO       | NV    | 89511 |
| 226-103-03 | DENNIS C & SHIRLEY A  | GRAY                             | 5530 WESTERN RIDER TRL                              |                   | RENO       | NV    | 89511 |
| 226-103-04 | DAVID & DONNA         | HUMPHREYS FAMILY TRUST           | 5526 WESTERN RIDER TRL                              |                   | RENO       | NV    | 89511 |
| 226-103-05 |                       | SELLS FAMILY 2006 TRUST          | 5520 WESTERN RIDER TRL                              |                   | RENO       | NV    | 89511 |
| 226-103-06 |                       |                                  |   |                   | RENO       | NV    | 89521 |
|            |                       | RANCHARRAH COMMUNITY ASSOCIATION | 10509 PROFESSIONAL CIR STE C/O ASSOCIA SIERRA NORTH | 200               |            |       |       |
| 226-103-07 |                       | ELLIOTT FAMILY TRUST             | 624 CAMARGUE TRL                                    |                   | RENO       | NV    | 89511 |
| 226-103-08 | GARY P & ELIZABETH    |                                  | 620 CAMARGUE TRL                                    |                   | RENO       | NV    | 89511 |
| 226-103-09 | EUGENE                | HEMBREE et al                    | 5535 DAPPLEGRAY WAY                                 |                   | RENO       | NV    | 89511 |
| 226-104-01 | LAURA K               | MCCABE TRUST                     | 611 CAMARGUE TRL                                    |                   | RENO       | NV    | 89511 |
| 226-104-02 | TRAVIS & CHRISTINA    | PASEK                            | 13375 ROCK CROSSING DR                              |                   | RENO       | NV    | 89511 |
| 226-104-03 | LESLIE                | BRANDT                           |   |                   | RENO       | NV    | 89511 |
| 226-104-04 | KATHLEEN              | BERGE                            | 619 CAMARGUE TRL                                    |                   | RENO       | NV    | 89511 |
| 226-104-05 | GEORGE                | MILES TRUST                      | 523 S PLYMOUTH CT # 401                             |                   | CHICAGO    | IL    | 60605 |
| 226-104-08 | LORI M                | PHIRIPIDIS et al                 | 627 CAMARGUE TRL                                    |                   | RENO       | NV    | 89511 |
|            |                       | JOHNSON LIVING TRUST             | 622 BRAIDED ROPE DR                                 |                   | RENO       | NV    | 89511 |

| APN        | First Name                    | Last Name               | Mailing 1                     | Mailing 2 | City          | State | Zip     |
|------------|-------------------------------|-------------------------|-------------------------------|-----------|---------------|-------|---------|
| 226-104-09 | KATHARINE &<br>ANTONY         | THOMAS                  | 4660 ABERFELDY RD             |           | RENO          | NV    | 89519-0 |
| 226-104-10 | ANGAD S &<br>CHEENU S         | SANDHU                  | 10350 GREY HAWK TRL           |           | RENO          | NV    | 89511   |
| 226-104-11 | TRANG T                       | NGUYEN                  | 610 BRAIDED ROPE DR           |           | RENO          | NV    | 89511   |
| 226-104-12 |                               | PRESTON FAMILY TRUST    | 606 BRAIDED ROPE DR           |           | RENO          | NV    | 89511   |
| 226-104-13 | CHRISTINE A                   | SPEED TRUST             | 602 BRAIDED ROPE DR           |           | RENO          | NV    | 89511   |
| 226-111-01 | GAIL G                        | KOESTER                 | 5540 WESTERN RIDER TRL        |           | RENO          | NV    | 89511   |
| 226-111-02 | JUAN M                        | TISCARENO               | 5544 WESTERN RIDER TRL        |           | RENO          | NV    | 89511   |
| 226-111-03 | ANIL K &<br>HIMABINDU         | RAYIDI                  | 5548 WESTERN RIDER TRL        |           | RENO          | NV    | 89511   |
| 226-111-04 | JOSHUA                        | BRANCO et al            | 5554 WESTERN RIDER TRL        |           | RENO          | NV    | 89511   |
| 226-111-05 | MAX S & DANA D                | IANTORNO                | 5560 WESTERN RIDER TRL        |           | RENO          | NV    | 89511   |
| 226-111-06 |                               | EVANS 2005 FAMILY TRUST | 5566 WESTERN RIDER TRL        |           | RENO          | NV    | 89511   |
| 226-112-01 | DEBORAH &<br>MICHAEL          | BRIZ                    | 5570 WESTERN RIDER TRL        |           | RENO          | NV    | 89511   |
| 226-112-02 | JAMES B &<br>HEATHER A        | ROBERTSON               | 5574 WESTERN RIDER TRL        |           | RENO          | NV    | 89511   |
| 226-112-03 | DANNY                         | NIKOLAI                 | 11542 COLLETT AVE             |           | GRANADA HILLS | CA    | 91344   |
| 226-112-05 |                               | ST JEOR FAMILY TRUST    | 5401 CREMELLO WAY             |           | RENO          | NV    | 89511   |
| 226-112-07 |                               | ALLISON FAMILY TRUST    | 5410 CREMELLO WAY             |           | RENO          | NV    | 89511   |
| 226-112-10 | RICHARD G III &<br>MARGARET A | WATSON                  | 5424 PHILLIPA DR              |           | RENO          | NV    | 89511   |
| 226-112-11 | MARILYN                       | TURVILLE TRUST          | 5428 PHILLIPA DR              |           | RENO          | NV    | 89511   |
| 226-112-13 | FRANCI                        | FREE 2020 TRUST et al   | 1570 LINDA VISTA DR           |           | RENO          | NV    | 89511   |
| 226-112-14 | RYAN                          | KOCH et al              | 5563 WESTERN RIDER TRL        |           | RENO          | NV    | 89511   |
| 226-112-15 |                               | GREEN TREES TRUST       | 5559 WESTERN RIDER TRL        |           | RENO          | NV    | 89511   |
| 226-112-16 | LAWRENCE W &<br>CATHY         | STEWART TRUST           | 5555 WESTERN RIDER TRL        |           | RENO          | NV    | 89511   |
| 226-112-17 |                               | DODGE LIVING TRUST      | 5549 WESTERN RIDER TRL        |           | RENO          | NV    | 89511   |
| 226-112-18 |                               | MCCLUNG TRUST           | 5545 WESTERN RIDER TRL        |           | RENO          | NV    | 89511   |
| 226-112-19 | JAMES & DONNA J               | DUNSEATH                | 5541 WESTERN RIDER TRL        |           | RENO          | NV    | 89511   |
| 226-112-20 | LANA                          | LITTLE                  | 5404 CREMELLO WAY             |           | RENO          | NV    | 89511   |
| 226-112-23 |                               | SMITH LIVING TRUST      | 15870 EDMUND DR               |           | LOS GATOS     | CA    | 95032   |
| 226-112-24 |                               | TOLL SOUTH RENO LLC     | 1140 N TOWN CENTER DR STE 250 |           | LAS VEGAS     | NV    | 89144-0 |

| APN        | First Name           | Last Name                        | Mailing 1                         | Mailing 2            | City            | State | Zip     |
|------------|----------------------|----------------------------------|-----------------------------------|----------------------|-----------------|-------|---------|
| 226-112-25 | ANAND                | BHEEMAN                          | 5420 PHILLIPA DR                  |                      | RENO            | NV    | 89511   |
| 226-113-01 |                      | ROTH TORGAN FAMILY LIVING TRUST  | 5429 PHILLIPA DR                  |                      | RENO            | NV    | 89511   |
| 226-113-02 | SHERRI L & ANTONIO C | ESCOBAR                          | 5425 PHILLIPA DR                  |                      | RENO            | NV    | 89511   |
| 226-113-03 | JACOB E              | OELSNER et al                    | 115 W SMITH ST                    |                      | SEATTLE         | WA    | 98119-2 |
| 226-113-04 | JAMES & ROBIN        | BERES TRUST                      | 1079 SAWMILL RD                   |                      | INCLINE VILLAGE | NV    | 89451   |
| 226-113-05 | PHYLLIS E            | SASAKI LIVING TRUST              | 5435 PHILLIPA DR                  |                      | RENO            | NV    | 89511   |
| 226-113-06 | NANCY                | PODEWILS-BABA et al              | 6116 S PLEASANT OAK TRL           |                      | RENO            | NV    | 89511   |
| 226-113-07 |                      | DKBK EMPIRE LLC                  | 5485 KIETZKE LN                   |                      | RENO            | NV    | 89511   |
| 226-113-08 |                      | RANCHARRAH COMMUNITY ASSOCIATION | 947 DOUBLE DIAMOND PKWY STE 17    |                      | RENO            | NV    | 89521   |
| 226-121-03 |                      | NSE CROW LLC                     | 1250 4TH ST FL 5                  |                      | SANTA MONICA    | CA    | 90401   |
| 226-121-06 |                      | RENO MAIN LLC                    | 10580 N MCCARRAN BLVD STE 115 399 |                      | RENO            | NV    | 89503   |
| 226-121-09 |                      | RANCHARRAH ESTATES 7 MT LLC      | 9101 ALTA DR UNIT 107             |                      | LAS VEGAS       | NV    | 89145   |
| 226-121-10 |                      | LYON-NCA DEVCO LLC               | 4901 BIRCH ST                     |                      | NEWPORT BEACH   | CA    | 92660   |
| 226-121-11 |                      | TK421 2023 TRUST                 | PO BOX 2670                       |                      | RENO            | NV    | 89505   |
| 226-121-16 | THOMAS S             | DOLAN TRUST                      | PO BOX 10677                      |                      | RENO            | NV    | 89511   |
| 226-121-17 |                      | BAUGHMAN FAMILY TRUST            | PO BOX 18127                      |                      | RENO            | NV    | 89511   |
| 226-121-20 |                      | NSE LARK LLC                     | 1250 4TH ST FL 5                  |                      | SANTA MONICA    | CA    | 90401   |
| 226-131-02 |                      | SAN SEVAINE PROPERTIES LLC       | 2069 PASEO LUCINDA                |                      | SAN DIMAS       | CA    | 91773   |
| 226-131-03 | DANNY & LINDA        | DANELL LIVING TRUST              | 4728 12TH AVE                     |                      | HANFORD         | CA    | 93230   |
| 226-131-06 |                      | TDC VILLAGE LLC                  | 550 W PLUMB LN                    |                      | RENO            | NV    | 89509   |
| 226-131-07 |                      | EG RENO 2 LLC                    | 18124 WEDGE PKWY # 1002           |                      | RENO            | NV    | 89511   |
| 226-141-01 | GERALD & KERRI       | HANSEN FAMILY TRUST              | 740 DEL MONTE LN # 16             |                      | RENO            | NV    | 89511-7 |
| 226-141-04 |                      | ACA INVESTMENTS & MANAGEMENT LLC | PO BOX 19293                      | DEL MONTE #15 SERIES | RENO            | NV    | 89511   |
| 226-151-01 | JUSTIN L & AMY L T   | HORVATH                          | 5400 SIDE SADDLE TRL              |                      | RENO            | NV    | 89511   |
| 226-151-02 | AARON T              | WICKSTROM LIVING TRUST           | 5406 SIDE SADDLE TRL              |                      | RENO            | NV    | 89511   |
| 226-151-03 | DEANNE               | SWARTZ                           | 5412 SIDE SADDLE TRL              |                      | RENO            | NV    | 89511   |



| APN        | First Name          | Last Name                                | Mailing 1   | Mailing 2              | City          | State | Zip     |
|------------|---------------------|--|---|------------------------|---------------|-------|---------|
| 226-151-04 | CARMEL              | ALLEGO-FITHIAN et al                     | 5454 SIDE SADDLE TRL                                    |                        | RENO          | NV    | 89511   |
| 226-151-05 | RAUL & PAOLA        | HERESI                                   | 5424 SIDE SADDLE TRL                                    |                        | RENO          | NV    | 89511   |
| 226-151-06 | JOHN & KELLY        | MANZANARES et al                         | 5430 SIDE SADDLE TRL                                    |                        | RENO          | NV    | 89511   |
| 226-151-07 | JESIKA & DAVID      | HARRELL                                  | 5436 SIDE SADDLE TRL                                    |                        | RENO          | NV    | 89511   |
| 226-151-08 | AMIT & JYOTI        | KATARIA et al                            | 513 CYPRESS POINT DR                                    |                        | DAYTON        | NV    | 89403-8 |
| 226-151-09 |                     | BEEAMAN FAMILY TRUST                     | 5448 SIDE SADDLE TRL                                    |                        | RENO          | NV    | 89511   |
| 226-151-11 |                     | SYNDERESIS TRUST                         | 5460 SIDE SADDLE TRL                                    |                        | RENO          | NV    | 89511   |
| 226-151-12 |                     | CASTELLANO-CHEUNG LIVING TRUST           | 5464 SIDE SADDLE TRL                                    |                        | RENO          | NV    | 89511   |
| 226-152-01 |                     | BOTANICAL BENEFIT TRUST                  | 5469 SIDE SADDLE TRL                                    |                        | RENO          | NV    | 89511   |
| 226-152-02 | KEAN K              | CHIN et al                               | 5465 SIDE SADDLE TRL                                    |                        | RENO          | NV    | 89511   |
| 226-152-03 |                     | LONGYEAR FAMILY 2024 TRUST               | 5461 SIDE SADDLE TRL                                    |                        | RENO          | NV    | 89511   |
| 226-152-04 |                     | MELLOW FAMILY 1993 TRUST                 | 5457 SIDE SADDLE TRL                                    |                        | RENO          | NV    | 89511   |
| 226-152-05 | KEGAN               | PETERSON                                 | 5453 SIDE SADDLE TRL                                    |                        | RENO          | NV    | 89511   |
| 226-152-06 |                     |  |   |                        | LAS VEGAS     | NV    | 89120   |
| 226-152-07 |                     | RANCHARRAH ESTATE 2023 LLC               | 3087 E WARM SPRINGS RD STE 100                          |                        | RENO          | NV    | 89511   |
| 226-152-08 | COLE H              | MARCUS KO & HELEN KO FAMILY LIVING TRUST | 5445 SIDE SADDLE TRL                                    |                        | RENO          | NV    | 89511   |
| 226-152-09 | MADISON L & COREY E | ZANKOWSKI                                | 3945 LAMAY CIR  |                        | RENO          | NV    | 89511   |
| 226-152-10 | RYAN & CATALINA     | COBB FAMILY TRUST                        | 5437 SIDE SADDLE TRL                                    |                        | RENO          | NV    | 89511   |
| 226-152-11 |                     | CARDWELL FAMILY TRUST                    | 5433 SIDE SADDLE TRL                                    |                        | RENO          | NV    | 89511   |
| 226-152-12 | CHEN                | YOUNG et al                              | 5429 SIDE SADDLE TRL                                    | ATTN: TATIANA CARDWELL | RENO          | NV    | 89511   |
| 226-152-13 | MATTHEW             | HALVORSON                                | 5425 SIDE SADDLE TRL                                    |                        | RENO          | NV    | 89511   |
| 226-152-14 | ANDREW              | HALVORSON                                | 5421 SIDE SADDLE TRL                                    |                        | RENO          | NV    | 89511   |
| 226-152-15 | YUJIE               | MIAO et al                               | 5417 SIDE SADDLE TRL                                    |                        | RENO          | NV    | 89511   |
| 226-152-16 | SIMON               | HOSIE et al                              | 114 BRIDLEMOOR CT                                       |                        | RENO          | NV    | 89511   |
| 226-152-17 | BRETT A & LINDA S   | WOLFF FAMILY TRUST                       | 1077 TICONDEROGA DR                                     |                        | UNNVYALE      | CA    | 94087   |
| 226-152-18 |                     | SMITH FAMILY TRUST                       | 5405 SIDE SADDLE TRL                                    |                        | RENO          | NV    | 89511   |
| 226-152-19 |                     |  | 5401 SIDE SADDLE TRL                                    |                        | RENO          | NV    | 89511   |
| 226-160-01 |                     | RANCHARRAH COMMUNITY ASSN                | 10509 PROFESSIONAL CIR STE C/O ASSOCIA SIERRA NORTH 200 |                        | RENO          | NV    | 89521   |
| 226-162-01 |                     | RANCHARRAH-RENO VILLAGE D PARTNERS LLC   | 4901 BIRCH ST   |                        | NEWPORT BEACH | CA    | 92660   |
|            |                     | BREEDING FAMILY TRUST                    | 18 PERSANO ST   |                        | RENO          | NV    | 89511   |

| APN        | First Name              | Last Name                       | Mailing 1                | Mailing 2                                     | City               | State | Zip     |
|------------|-------------------------|---------------------------------|--------------------------|---|--------------------|-------|---------|
| 226-162-02 |                         | LITHGOW FAMILY TRUST            | 20 PERSANO ST            |   | RENO               | NV    | 89511   |
| 226-162-03 | RANDALL &<br>KRISTIN    | ZUCKERMAN                       | 16 PERSANO ST            |   | RENO               | NV    | 89511   |
| 226-162-04 | D WAYNE                 | JAUER et al                     | 14 PERSANO ST            |   | RENO               | NV    | 89511   |
| 226-162-05 | CAREY T &<br>JOHANNES D | SERFONTEIN                      | 10 PERSANO STREET        |   | RENO               | NV    | 89511   |
| 226-162-06 | DENNIS & SALLY          | RAHLVES 1982 FAMILY TRUST       | 634 W 2ND ST             |   | RENO               | NV    | 89503   |
| 226-162-07 | MICHELLE D              | KLING                           | 2109 THOMAS JEFFERSON DR |   | RENO               | NV    | 89509   |
| 226-162-08 | JAMES & MARY P          | HAWKINS 18 FAMILY TRUST         | 6939 N CACTUS WREN CT    |   | PARADISE<br>VALLEY | AZ    | 85253   |
| 226-162-09 |                         | BAUGHMAN LIVING TRUST           | PO BOX 18127             |   | RENO               | NV    | 89511   |
| 226-162-10 |                         | TK421 2023 TRUST                | 100 W LIBERTY ST FL 10   | C/O MCDONALD CARANO<br>ATTN: ROBERT ARMSTRONG | RENO               | NV    | 89501   |
| 226-162-11 | DAVID O &<br>MIRANDA    | ROBERTS FAMILY TRUST            | 67 CABALLADA ST          |   | RENO               | NV    | 89511   |
| 226-162-12 | JAMES W &<br>EARLENE    | FORSTYHE TRUST                  | 65 CABALLADA ST          |   | RENO               | NV    | 89511   |
| 226-162-13 |                         | QTIP TRUST                      | 68 CABALLADA ST          |   | RENO               | NV    | 89511   |
| 226-162-14 |                         | MAKAHIKI HOU TRUST              | 66 CABALLADA ST          |   | RENO               | NV    | 89511   |
| 226-162-15 | JANET B                 | FLYNN et al                     | 70 CABALLADA ST          |   | RENO               | NV    | 89511   |
| 226-162-16 | JORGEN A & DORIS        | ERTING                          | 52 CABALLADA ST          |   | RENO               | NV    | 89511   |
| 226-162-17 |                         | BAUMGARDNER FAMILY TRUST        | 69 CABALLADA ST          |   | RENO               | NV    | 89511   |
| 226-162-18 |                         | LOVAS TRUST                     | 71 CABALLADA ST          |   | RENO               | NV    | 89511   |
| 226-162-19 |                         | FREITAS FAMILY TRUST            | 38 CAMPOLINA ST          |   | RENO               | NV    | 89511   |
| 226-162-20 | INDIA                   | VANNINI                         | 40 CAMPOLINA ST          |   | RENO               | NV    | 89511   |
| 226-162-22 | KATHLEEN A              | ZIMMERMAN LIVING TRUST et<br>al | 41 CAMPOLINA ST          |   | RENO               | NV    | 89511   |
| 226-162-23 |                         | FLOCCCHINI LIVING TRUST         | 36 CAMPOLINA ST          |   | RENO               | NV    | 89509   |
| 226-162-24 |                         | G & M FAMILY TRUST              | 34 CAMPOLINA ST          |   | RENO               | NV    | 89511   |
| 226-162-25 | THEODORE B              | BERNDT FAMILY TRUST             | 37 CAMPOLINA ST          |   | RENO               | NV    | 89511   |
| 226-162-26 |                         | REDFERN FAMILY 2005 TRUST       | 35 CAMPOLINA ST          |   | RENO               | NV    | 89511   |
| 226-162-27 | DANIEL J                | NIKOLAI et al                   | 11542 COLLETT AVE        |   | GRANADA<br>HILLS   | CA    | 91344   |
| 226-162-29 | DANIEL P &<br>SUZANNE S | OSTER                           | 2455 DUBLIN CT           |   | RENO               | NV    | 89509-3 |
| 226-162-30 |                         | SWALL FAMILY TRUST              | 32 CAMPOLINA ST          |   | RENO               | NV    | 89511   |
| 226-163-01 |                         | KERRIGAN FAMILY LIVING<br>TRUST | 75 CABALLADA ST          |   | RENO               | NV    | 89511   |

| APN        | First Name            | Last Name   | Mailing 1                                     | Mailing 2                 | City         | State    | Zip            |
|------------|-----------------------|---|---|---------------------------|--------------|----------|----------------|
| 226-163-02 | H & K                 | MCMURRAY 2000 TRUST   | 73 CABALLADA ST<br>76 CABALLADA ST            |                           | RENO<br>RENO | NV<br>NV | 89511<br>89511 |
| 226-163-03 | KAMA J & MICHAEL<br>A | BEST  |   |                           |              |          |                |
| 226-163-04 | JOHN & CORINNE        | KIEFER JOINT TRUST  | 74 CABALLADA ST                               |                           | RENO         | NV       | 89511          |
| 226-163-29 |                       | PROVIDENCE TRUST  | 200 S VIRGINIA ST STE 400                     | C/O DUNHAM TRUST CO       | RENO         | NV       | 89501          |
| 226-163-31 | BRIAN & NANCY         | KENNEDY LIVING TRUST  | 4790 CAUGHLIN PKWY # 501                      |                           | RENO         | NV       | 89519          |
| 226-171-03 |                       | SIERRA ORAL SURGERY<br>PARTNERS LLC   |   |                           | SPARKS       | NV       | 89431          |
| 226-171-05 |                       | YETIS LLC   | 255 GLENDALE AVE STE 3<br>900 SCHELLBOURNE ST |                           | RENO         | NV       | 89511          |
| Agent      |                       | Wood Rodgers  | 1361 Corporate Blvd                           | ATTN: Andy Durling        | RENO         | NV       | 89502          |
| NV         |                       |   | 901 S. Stewart Street, Ste<br>5003            | Division of Lands         | Carson City  | NV       | 89701          |
| US-01      |                       | State of Nevada<br>United States of America Dept<br>of Housing and Urban<br>Development |   | Attn: Ramiro Delgado      | Santa Ana    | CA       | 92701          |
| US-02      |                       |   |   |                           |              |          |                |
| Ward 2 NAB | Mimi                  | Fuji-Strickler  | 34 Civic Center Plaza<br>5665 Morgan Hill Rd  | Bureau of Land Management | Carson City  | NV       | 89701          |
| Ward 2 NAB | Donna                 | Keats   | 835 Huffaker Estates Cir<br>2265 Sunrise Dr   |                           | RENO         | NV       | 89511          |
| Ward 2 NAB | Stacey                | Shinn   | 4932 Meadow Springs Dr                        |                           | RENO         | NV       | 89509          |
| Ward 2 NAB | Stan                  | Dowdy   | 2700 Plumas St #302                           |                           | RENO         | NV       | 89509          |
| Ward 2 NAB | David                 | Titzel  | 2170 Humboldt St                              |                           | RENO         | NV       | 89509          |
| Ward 2 NAB | Audrey                | Keller  | 720 Marewood Trail                            |                           | RENO         | NV       | 89511          |
| Ward 2 NAB | Hal                   | Taylor  | 2251 W Lakeridge Shores                       |                           | RENO         | NV       | 89519          |
| Ward 2 NAB | Patrick               | Fisher  | 6400 Bonde Farms Lane                         |                           | RENO         | NV       | 89511          |
| Ward 2 NAB | Roman                 | Schomberg   | 660 Caspian Ct                                |                           | RENO         | NV       | 89521          |
| Ward 2 NAB | Sean                  | McCoy   | 1785 Sandpoint Circle                         |                           | RENO         | NV       | 89509          |
| Ward 2 NAB | Kristen               | Montan  | 3095 Lakeside Dr. #302                        |                           | RENO         | NV       | 89509          |
| Ward 2 NAB | James                 | Cashell   | 4847 Lakeridge Terrace W                      |                           | RENO         | NV       | 89509          |
| Ward 2 NAB | Michael               | Ginsburg  | 4690 Sommerville Way                          |                           | RENO         | NV       | 89519          |
| WC-01      |                       | Washoe County Public Works  | 1001 E 9th St                                 |                           | RENO         | NV       | 89520          |
| WC-02      |                       | Washoe County Comm. Dev.  | 1001 E 9th St                                 | c/o Mojra Hauenstein      | RENO         | NV       | 89520          |
| WC-03      |                       | Washoe County Treasurer   | PO Box 30039                                  |                           | RENO         | NV       | 89520          |
| WC-04      |                       | Washoe Co Assessor's  | 1001 E 9th St                                 |                           | RENO         | NV       | 89520          |

## Report Totals



| APN                              | First Name | Last Name | Mailing 1 | Mailing 2 | City | State | Zip |
|----------------------------------|------------|-----------|-----------|-----------|------|-------|-----|
| Count: 598                       |            |           |           |           |      |       |     |
| Date Exported: 4/16/2025 8:14 AM |            |           |           |           |      |       |     |

PIN (Count): 598



# CITY OF RENO PRINT ORDER FORM

Job Name : LDC25-00037 (Rancharra PUD Handbook Amendment & MPA)

## Contact Information (required fields):

Name: LAUREN MORRIS

Date File is Available: 4/17/2025

Dept/Division: CITY CLERKS OFFICE

Date Order Due: 4/22/2025

Contact Phone #: 775-334-2030

Contact Email: CITYCLERK@RENO.GOV

0371-7400-6000-

### PRODUCTION

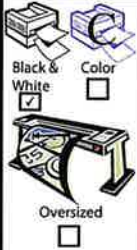

Copies

598

Sides

SS

DS

Page Size

8.5 X 11 ☐ 8.5 X 14 ☒ 11 X 17 ☐

Paper Type & Color:

Paper Color:

Blue

Paper Weight:

| Pastel    | Available Sizes & Weights  | Prights (letter size only) | Available Weights |
|-----------|----------------------------|----------------------------|-------------------|
| Blue      | Letter, Legal, & Cardstock | Cosmic Orange              | 24 lb & cardstock |
| Green     | Letter, Legal, & Cardstock | Gamma Green                | 24 lb             |
| Ivory     | Letter, Legal, & Cardstock | Life-Off Lemon             | 24 lb             |
| Yellow    | Letter, Cardstock          | Lunar Blue                 | 24 lb & cardstock |
| Pink      | Letter, Legal              | Planetary Purple           | 24 lb             |
| Goldenrod | Letter, Legal              | Pulsar Pink                | 24 lb             |
| Buff      | Letter                     | Re-Entry Red               | 24 lb & cardstock |
| Lilac     | Letter                     | Solar Yellow               | 24 lb & cardstock |
| Salmon    | Letter                     | Terra Green                | 24 lb & cardstock |

\* Other paper options are available, please specify in Special Instructions

Collated

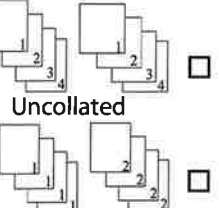

Uncollated

### Binding



Binding:

☐ Comb Bind

☐ Coil Bind

☐ Tape Bind

Binding color (pick one): navy

☐ Front cover:

☐ Clear

☐ Regency

☐ Cardstock

Color: navy

☐ Back cover:

☐ Clear

☐ Regency

☐ Cardstock

Color: navy

☐ 3-ring Binder

Size:

Color: navy

### FINISHING

#### Laminate/ Mount

Laminating



☐ Glossy  
☐ Matte

Pouch Size

8.5 X 11 ☐ 8.5 X 14 ☐ 11 X 17 ☐

Mounting



☐ Foam

Carbonless paper:

☐ 2-part

☐ 3-part

☐ 4-part

☐ Color

☐ BW

### Finish

STAPLING

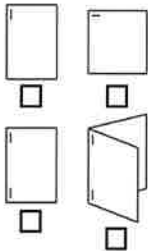

FOLDING

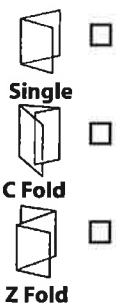

CUTTING

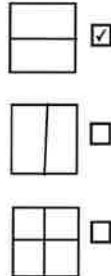

DRILLING

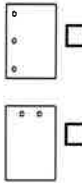

PADS

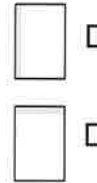

How many pads?

Pages per pad:

SHRINKWRAP



TABS



Tab Font

Tab Text

1. \_\_\_\_\_  
2. \_\_\_\_\_  
3. \_\_\_\_\_  
4. \_\_\_\_\_  
5. \_\_\_\_\_  
6. \_\_\_\_\_  
7. \_\_\_\_\_  
8. \_\_\_\_\_  
9. \_\_\_\_\_  
10. \_\_\_\_\_

## Special Instructions

BLUE POSTCARDS - DELIVERED TO RENO CITY HALL, 2ND FLOOR CLERKS OFFICE BY TUESDAY, APRIL 22, 2025, AT 10 AM.

THANK YOU!