

## **NOTICE OF PUBLIC HEARINGS**

**NOTICE IS HEREBY GIVEN** that the City Council of the City of Reno will hold the below listed public hearing in the Council Chambers of the Reno City Hall, One East First Street, First Floor, on **April 23, 2025**, commencing at the time indicated.

**10:00 a.m. – LDC25-00038 (Arlington Office MPA & ZMA)**

A request has been made for: 1) a Master Plan Amendment from Single-Family Neighborhood (SF) to Suburban Mixed-Use (SMU); and 2) a zoning map amendment from Single-Family Residential - 5 units per acre (SF-5) to Professional Office (PO). The ±0.31 acre parcel is located on the east side of South Arlington Avenue ±260 feet north of its intersection with West Plumb Lane within the Plumas Neighborhood Residential Core Planning Area Overlay (PL).

**10:00 a.m. – LDC25-00043 (Earl Wooster and Corbett Zone Change)**

A request has been made for a zoning map amendment from Single-Family Residential – 8 units per acre (SF-8) to Public Facility (PF). The ±43.13 acre site is composed of two parcels; one is located at the northeast corner of East Plumb Lane and Harvard Way and the other is located north of Villanova Drive, ±132 feet east of its intersection with Harvard Way. The site has the Master Plan land use designation of Public/Quasi-Public (PQP).

Those who wish to submit public comment relative to the above, may do so by submitting public comment through the online public comment form found at [Reno.Gov/PublicComment](http://Reno.Gov/PublicComment) or by email to [PublicComment@reno.gov](mailto:PublicComment@reno.gov). Comments received prior to 4:00 p.m. on the day preceding the meeting will be transcribed, provided to the City Council for review, and entered into the record. Comments received after 4:00 pm on the day preceding the meeting will be provided to the City Council for review prior to adjournment and entered into the record.

**All interested persons are invited to present testimony.**

MIKKI HUNTSMAN, CLERK AND CLERK OF THE RENO CITY COUNCIL



Nevada/Utah  
GANNETT

## Order Confirmation

Not an Invoice

Account Number:	1118454
Customer Name:	City of Reno - Legals
Customer Address:	City of Reno - Legals 1 E 1ST Street FL 2 Reno NV 89501
Contact Name:	Barbara Aufiero
Contact Phone:	
Contact Email:	AufieroB@reno.gov
PO Number:	LDC25-00038

Date:	04/03/2025
Order Number:	11201501
Prepayment Amount:	\$ 0.00

Column Count:	1.0000
Line Count:	80.0000
Height In Inches:	8.2800

Print

Product	#Insertions	Start - End	Category
RGJ Reno Gazette-Journal	1	04/1/2025 - 04/1/2025	Govt Public Notices
RGJ rgi.com	1	04/1/2025 - 04/1/2025	Govt Public Notices

As an incentive for customers, we provide a discount off the total order cost equal to the 3.99% service fee if you pay with Cash/Check/ACH. Pay by Cash/Check/ACH and save!

Total Cash Order Confirmation Amount Due	\$197.40
Tax Amount	\$0.00
Service Fee 3.99%	\$7.88
Cash/Check/ACH Discount	-\$7.88
Payment Amount by Cash/Check/ACH	\$197.40
Payment Amount by Credit Card	\$205.28

Order Confirmation Amount

\$197.40

Ad Preview

NOTICE OF PUBLIC

HEARINGS  
NOTICE IS HEREBY  
GIVEN that the City Council  
of the City of Reno will hold  
the below listed public hear-  
ing in the Council Chambers  
of the Reno City Hall, One  
East First Street, First  
Floor, on April 23, 2025,  
commencing at the time indi-  
cated.

10:00 a.m. – LDC25-00038  
(Arlington Office MPA &  
ZMA)

A request has been made  
for: 1) a Master Plan  
Amendment from Single-  
Family Neighborhood (SF)  
to Suburban Mixed-Use  
(SMU); and 2) a zoning map  
amendment from Single-  
Family Residential - 5 units  
per acre (SF-5) to Profes-  
sional Office (PO). The  
±0.31 acre parcel is located  
on the east side of South  
Arlington Avenue ±260 feet  
north of its intersection with  
West Plumb Lane within the  
Plumas Neighborhood Resi-  
dential Core Planning Area  
Overlay (PL).

10:00 a.m. – LDC25-00043  
(Earl Wooster and Corbett  
Zone Change)

A request has been made for  
a zoning map amendment  
from Single-Family Residen-  
tial 8 units per acre (SF-8)  
to Public Office (PO). The  
±4.13 acre site is composed  
of two parcels: one is located  
at the northeast corner of  
East Plumb Lane and  
Harvard Way and the other  
is located north of Villanova  
Drive, ±132 feet east of its  
intersection with Harvard  
Way. The site has the Master  
Plan land use designation of  
Public/Quasi-Public (PQP).

Those who wish to submit  
public comment relative to  
the above, may do so by  
submitting public comment  
through the online public  
comment form found at  
Reno.Gov/PublicComment or  
by email to PublicCom-  
ment@reno.gov. Comments  
received prior to 4:00 p.m.  
on the day preceding the  
meeting will be transcribed  
provided to the City Council  
for review, and entered into  
the record. Comments  
received after 4:00 pm on the  
day preceding the meeting  
will be provided to the City  
Council for review prior to  
adjournment and entered  
into the record.  
All interested persons are  
invited to present testi-  
mony.

MIRRI HUNTSMAN  
CLERK AND CLERK OF  
THE RENO CITY COUNCIL  
No.11201501 April 11, 2025



City of Reno - Legals  
1 E 1ST Street FL 2  
Reno, NV 89501  
USA

### Receipt

Account No.:	1118454
Receipt No.:	5657924
Receipt Date:	4/3/2025
Total Cash Amt:	\$ 197.40
Service Fee 3.99%:	\$ 7.88
Cash/Check/ACH Discount:	\$ 0.00
Paid Amount:	\$ 205.28

Date	Doc Type	Doc No.	Customer	Allocation type	Allocated
4/3/2025	Order	11201501	City of Reno - Legals	Opp	197.40
	Mastercard		8219		

Abbreviation	Document type
Ip	Invoice Payment
Pa, Opp	Payment allocation, Order Pre-payment

***Thank you for your payment!***



---

**Public Noticing Instructions for LDC25-00038 (Arlington Office MPA & ZMA)**

---

**From** Lauren Morris <MorrisL@reno.gov>

**Date** Thu 4/3/2025 10:32 AM

**To** jeff@benderengineering.com <jeff@benderengineering.com>

**Cc** City Clerk <CityClerk@reno.gov>; Jeff Foster <FosterJ@reno.gov>

 2 attachments (166 KB)

Public Noticing Instructions for LDC25-00038 (Arlington Office MPA & ZMA).docx; LDC25-00038 Posting Map.pdf;

Hello,

Attached you will find the posting location map and public noticing instructions for the above-mentioned case.

Signs need to be posted no later than Friday, April 11, 2025, at 5:00 p.m.

After the signs are posted, please submit photographic proof of posting via email to [cityclerk@reno.gov](mailto:cityclerk@reno.gov). All photographs need to be fully legible for the office to confirm the signs are correctly posted.

As mentioned in my voicemail, due to the property size, the City of Reno has printed the sign for you, and it can be picked up at the Reno City Clerk's Office (City Hall - 2<sup>nd</sup> Floor). The sign will need to be laminated prior to posting.

Should you have any questions, contact our office immediately at [cityclerk@reno.gov](mailto:cityclerk@reno.gov).

Best,  
Lauren



**Lauren Morris**

*Chief Deputy City Clerk*

City Clerk's Office

775-334-2030 (o) or 775-772-5745 (c)

[MorrisL@Reno.Gov](mailto:MorrisL@Reno.Gov)

1 E. First St., Reno, NV 89501

[Reno.Gov](http://Reno.Gov) | Connect with us: 

**Your case is scheduled for the April 23, 2025, Reno City Council Meeting at 10:00 AM.**

**The posting location map has been provided via email.**

The public notice sign(s) provided to you for case **LDC25-00038 (Arlington Office MPA & ZMA)** must be on site no later than **Friday, April 11, 2025, at 5:00 p.m.**

**Please submit photographic proof of posting to our office at 1 East First Street, 2<sup>nd</sup> Floor or via email to [cityclerk@reno.gov](mailto:cityclerk@reno.gov). Signs provided to you will be clear and legible. Signs must be laminated by you to be waterproof, prior to posting.**

RECEIVED

APR 11 2025

CITY CLERK

## PUBLIC NOTICE

A PUBLIC HEARING WILL BE HELD BY THE RENO CITY COUNCIL IN THE CITY COUNCIL CHAMBERS AT RENO CITY HALL, 1 EAST FIRST STREET, RENO, NEVADA.

HEARING DATE APRIL 23, 2025 HEARING TIME 10:00 AM

APPLICANT

JEFF BENDER

CASE NUMBER

LDC25-00038

PROJECT NAME

ARLINGTON OFFICE MPA & ZMA

DESCRIPTION

A request has been made for: 1) a Master Plan Amendment from Single-Family Neighborhood (SF) to Suburban Mixed-Use (SMU); and 2) a zoning map amendment from Single-Family Residential - 5 units per acre (SF-5) to Professional Office (PO). The 20.33 acre parcel is located on the east side of South Arlington Avenue 1260 feet north of its intersection with West Plum Lane within the Florida Neighborhood Residential Core Planning Area Overlay (PL).

Carter Williams - [WilliamsCA@Reno.Gov](mailto:WilliamsCA@Reno.Gov)

CITY OF RENO  
Development Services Department  
P.O. Box 1900  
Reno, NV 89505



The applicant shall remove this sign within 5 days after the appeal period for the public hearing has ended.



# PUBLIC NOTICE

A PUBLIC HEARING WILL BE HELD BY THE RENO CITY COUNCIL IN THE CITY COUNCIL CHAMBERS AT RENO CITY HALL, 1 EAST FIRST STREET, RENO, NEVADA.

**HEARING DATE**

APRIL 23, 2025

**HEARING TIME**

10:00 AM

**APPLICANT**

JEFF BENDER

**CASE NUMBER**

LDC25-00038

**PROJECT NAME**

ARLINGTON OFFICE MPA & ZMA

**DESCRIPTION**

A request has been made for: 1) a Master Plan Amendment from Single-Family Neighborhood (SF) to Suburban Mixed-Use (SMU); and 2) a zoning map amendment from Single-Family Residential - 5 units per acre (SF-5) to Professional Office (PO). The ±0.31 acre parcel is located on the east side of South Arlington Avenue ±260 feet north of its intersection with West Plumb Lane within the Plumas Neighborhood Residential Core Planning Area Overlay (PL).

Carter Williams - WilliamsCA@Reno.Gov

CITY OF RENO  
Development Services Department  
P.O. Box 1900  
Reno, NV 89505



The applicant shall remove this sign within 5 days after the appeal period for the public hearing has ended.











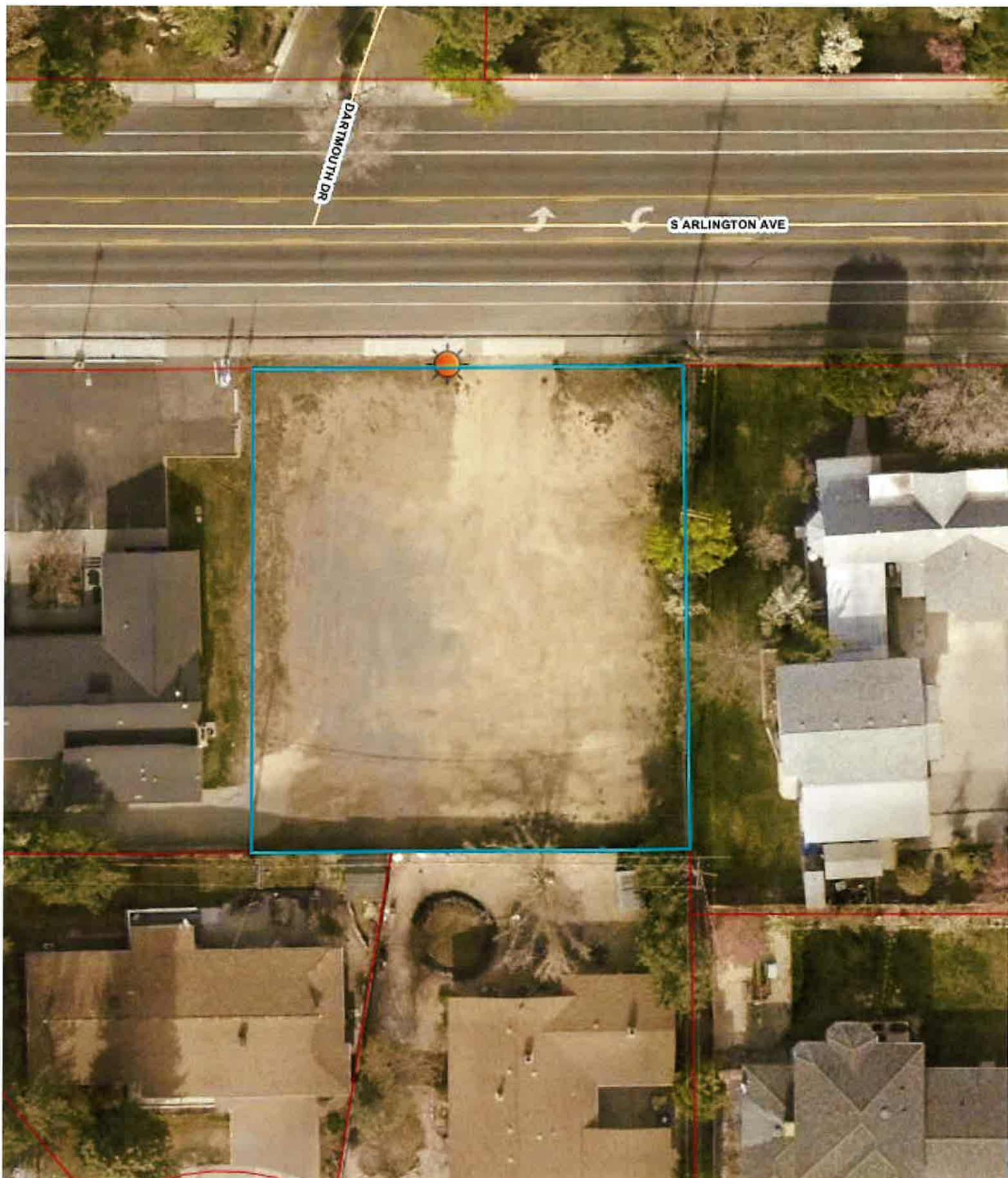

**AFFIDAVIT OF MAILING**

STATE OF NEVADA     )

:ss.

COUNTY OF WASHOE    )

Lauren Morris, being first duly sworn, deposes and says: That at all times hereinafter mentioned she was, and now is, the duly appointed City Clerk of the City of Reno, Washoe County, Nevada; that on the 11<sup>th</sup> day of April, 2025, she deposited in the United States Post Office at Reno, Nevada, copies of the attached postcard "Notice of Public Hearing" on which postage was fully prepaid, addressed to the property owners shown opposite their names, said noticing being marked "Exhibit A" and made a part hereof; that there is a regular communication by mail between the place of mailing and the place addressed; that said attached list contains the names and addresses of all owners of land in Case No. LDC 25-0030 (Arlington Office MPA & ZMA) who are required to be notified by law.

James Li Chief Deputy  
for CITY CLERK City Clerk

SUBSCRIBED and SWORN to before me this

11<sup>th</sup> day of APRIL, 2025.

Molly Rosen  
Notary Public in and for the County of Washoe,  
State of Nevada

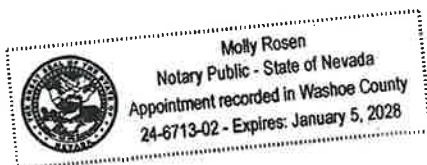



CITY OF RENO  
City Clerk  
PO Box 7  
Reno, Nevada 89504  
RETURN SERVICE REQUESTED

**IMPORTANT NOTICE ABOUT A  
PROJECT NEAR YOUR PROPERTY**

Your Parcel: 014-170-03

**Project Site Map**

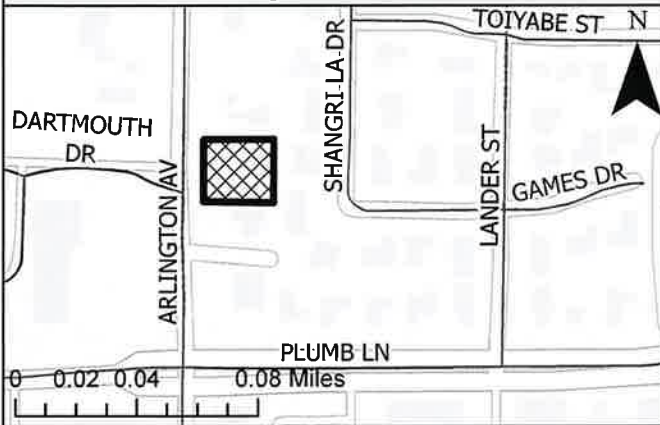

JOHN C & DAWN S CASTEL TRUST  
1501 S ARLINGTON AVE  
RENO, NV 89509



CITY OF RENO  
City Clerk  
PO Box 7  
Reno, Nevada 89504  
RETURN SERVICE REQUESTED

**IMPORTANT NOTICE ABOUT A  
PROJECT NEAR YOUR PROPERTY**

Your Parcel: 014-170-16

**Project Site Map**

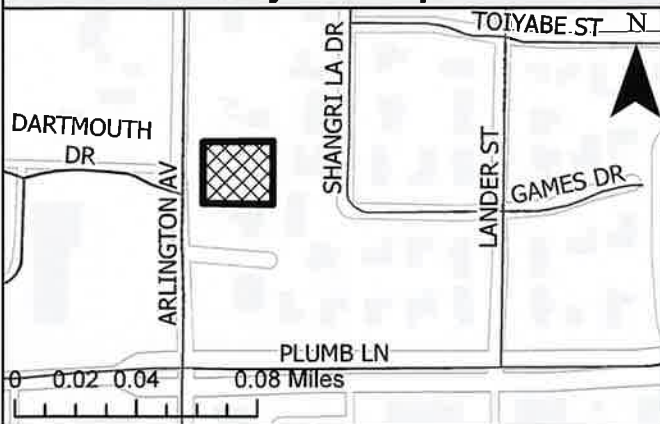

JOHN IV CALLAHAN  
450 THOROUGHbred CIR  
RENO, NV 89508



**NOTICE OF PUBLIC HEARING**

**Dear Property Owner:**

**YOU ARE HEREBY NOTIFIED** that the Reno City Council will hold a public hearing on **April 23, 2025, at 10:00 a.m.** in the Council Chambers of City Hall, One East First Street, First Floor, Reno, Nevada, to consider testimony for **LDC25-00038 (Arlington Office MPA & ZMA)**

**A request has been made for: 1) a Master Plan Amendment from Single-Family Neighborhood (SF) to Suburban Mixed-Use (SMU); and 2) a zoning map amendment from Single-Family Residential - 5 units per acre (SF-5) to Professional Office (PO). The ±0.31 acre parcel is located on the east side of South Arlington Avenue ±260 feet north of its intersection with West Plumb Lane within the Plumas Neighborhood Residential Core Planning Area Overlay (PL).**

As a property owner within **750 feet**, you are invited to present written or oral testimony relative to the above. If you have any questions, please call **Jeff Foster, Associate Planner, at (775) 393-4165.**

Those who wish to submit public comment relative to the above, may do so by submitting public comment through the online public comment form found at [Reno.Gov/PublicComment](http://Reno.Gov/PublicComment) or by email to [PublicComment@reno.gov](mailto:PublicComment@reno.gov). Comments received prior to 4:00 p.m. on the day preceding the meeting will be transcribed, provided to City Council for review, and entered into the record. Comments received after 4:00 pm on the day preceding the meeting will be provided to the City Council for review prior to adjournment and entered into the record.

**MIKKI HUNTSMAN, CITY CLERK AND CLERK OF THE CITY COUNCIL OF THE CITY OF RENO**

**NOTICE OF PUBLIC HEARING**

**Dear Property Owner:**

**YOU ARE HEREBY NOTIFIED** that the Reno City Council will hold a public hearing on **April 23, 2025, at 10:00 a.m.** in the Council Chambers of City Hall, One East First Street, First Floor, Reno, Nevada, to consider testimony for **LDC25-00038 (Arlington Office MPA & ZMA)**

**A request has been made for: 1) a Master Plan Amendment from Single-Family Neighborhood (SF) to Suburban Mixed-Use (SMU); and 2) a zoning map amendment from Single-Family Residential - 5 units per acre (SF-5) to Professional Office (PO). The ±0.31 acre parcel is located on the east side of South Arlington Avenue ±260 feet north of its intersection with West Plumb Lane within the Plumas Neighborhood Residential Core Planning Area Overlay (PL).**

As a property owner within **750 feet**, you are invited to present written or oral testimony relative to the above. If you have any questions, please call **Jeff Foster, Associate Planner, at (775) 393-4165.**

Those who wish to submit public comment relative to the above, may do so by submitting public comment through the online public comment form found at [Reno.Gov/PublicComment](http://Reno.Gov/PublicComment) or by email to [PublicComment@reno.gov](mailto:PublicComment@reno.gov). Comments received prior to 4:00 p.m. on the day preceding the meeting will be transcribed, provided to City Council for review, and entered into the record. Comments received after 4:00 pm on the day preceding the meeting will be provided to the City Council for review prior to adjournment and entered into the record.

**MIKKI HUNTSMAN, CITY CLERK AND CLERK OF THE CITY COUNCIL OF THE CITY OF RENO**

# LDC25-00038\_4-2-25 Final List

APN	First Name	Last Name	Mailing 1	Mailing 2	City	State	Zip
014-170-03	JOHN C & DAWN S	CASTEL TRUST	1501 S ARLINGTON AVE		RENO	NV	89509
014-170-16	JOHN IV	CALLAHAN	450 THOROUGHbred CIR		RENO	NV	89508
014-170-17	ANNA	PANORSKA et al	1695 S ARLINGTON AVE		RENO	NV	89509
014-170-19		A&C TRUST	888 MOUNT ROSE ST		RENO	NV	89509
014-170-23	MARK D	LEHMANN LIVING TRUST	825 ARLINGTON CT		RENO	NV	89509
014-170-24	EDWARD D & DEBRA J S	HORAN COMMUNITY PROPERTY TRUST	829 ARLINGTON CT		RENO	NV	89509
014-170-25		DBR FAMILY TRUST	835 ARLINGTON CT		RENO	NV	89509
014-170-26	THOMAS R & SANDRA L	WALTER	839 ARLINGTON CT		RENO	NV	89509
014-170-27		ARLINGTON COURT HOMEOWNER'S ASSOCIATION	C/O ARLINGTON COURT HOA		RENO	NV	89509
014-170-30	MICHAEL A & CHRISTINE A	DIXON	839 ARLINGTON CT		RENO	NV	89509
014-170-31		BURR FAMILY TRUST	815 ARLINGTON CT		RENO	NV	89509
014-180-01	RYAN D & ANNA C	COSTELLA	1715 S ARLINGTON AVE		RENO	NV	89509
014-180-04	ROWAN & TAMMY L	SAGE	845 DARTMOUTH DR		RENO	NV	89509
014-180-05	JON & JEAN L	HARRISON	875 DARTMOUTH DR		RENO	NV	89509
014-180-18		FIFTYFIFTY LLC	2050 SIERRA SAGE LN	SERIES 1420 DARTMOUTH DR	RENO	NV	89509
014-180-19		HAEFNER-GUMFOR Y TRUST	1400 DARTMOUTH DR		RENO	NV	89509
014-180-20		STASIEWICZ LIVING TRUST	1380 DARTMOUTH DR		RENO	NV	89509
014-180-21	MICHAEL A & CAROL A	ROMAN TRUST	1360 DARTMOUTH DR		RENO	NV	89509
014-180-32	WON H	CHUNG	1365 DARTMOUTH DR		RENO	NV	89509
014-180-33		SHAFF FAMILY TRUST	1385 DARTMOUTH DR		RENO	NV	89509
014-180-34	DAVID & JOYCE	HEATH FAMILY TRUST	17260 WINCHESTER CLUB DR		MEADOW VISTA	CA	95720
014-180-35	JOHN & REGINA A	KELIHER	1425 DARTMOUTH DR		RENO	NV	89509
014-180-38	MICHAEL & MARY	GRULLI FAMILY TRUST	805 DARTMOUTH DR		RENO	NV	89509
014-180-39		HUTCHENS FAMILY TRUST	801 DARTMOUTH DR		RENO	NV	89509
014-180-40		1885 SOUTH ARLINGTON LLC	6560 S MCCARRAN BLVD STE A		RENO	NV	89509
014-191-01		H&H PROPERTY LP	2295 HOMESTEAD PL		RENO	NV	89509

LDC25-00038 (Arlington Office MPA & ZMA)

APN	First Name	Last Name	Mailing 1	Mailing 2	City	State	Zip
014-191-02	SUSAN I	CHAMBERLAIN et al	760 SHANGRI-LA DR		RENO	NV	89509
014-191-06	VIKTOR	GANCHEV	3700 LAKESIDE DR # 100		RENO	NV	89509
014-191-07		KALEZIC FAMILY TRUST	2109 CORTE RICARDO		LEASANTO	CA	94566
014-191-08	MUOI & MARC	MULRY	1680 S ARLINGTON AVE		RENO	NV	89509
014-191-10		ROSENBLOOM & WOODS FAMILY TRUST	1653 SHANGRI-LA DR		RENO	NV	89509
014-191-11	BRANDON & SKYE	TAYLOR	1663 SHANGRI-LA DR		RENO	NV	89509
014-191-12	PAUL	TOME0	1673 SHANGRI-LA DR		RENO	NV	89509
014-191-13	STANLEY M	COHEN et al	1683 SHANGRI-LA DR		RENO	NV	89509
014-192-09	MIRIAM A	KRANTON TRUST	1575 LANDER ST		RENO	NV	89509
014-192-10	DIEGO & CARLA D M	NOVOA	1605 LANDER ST		RENO	NV	89509
014-192-11	JASON P	BARNES	1627 LANDER ST		RENO	NV	89509
014-192-12	BENJAMIN P	LILLIG et al	1647 LANDER ST		RENO	NV	89509
014-192-13	MICHAEL	WETTERAU	1655 LANDER ST		RENO	NV	89509
014-192-14	LAURA S	SPECTOR	1667 LANDER ST		RENO	NV	89509
014-192-15	M BRADFORD	SNYDER	1675 LANDER ST		RENO	NV	89509
014-192-16		MILKE FAMILY TRUST et al	1695 LANDER ST		RENO	NV	89509
014-192-17		WARE HOUSE ONE LLC	735 TOIYABE ST		RENO	NV	895096
014-192-18	DIANA	KOETHER	1675 SHANGRI-LA DR		RENO	NV	89509
014-192-19	GARRETT R	BELL et al	1665 SHANGRI-LA DR		RENO	NV	89509
014-192-20		CANDI CANE PROPERTIES LLC	4485 MOUNTAINGATE DR	ATTN CANDI PEEK MGR	RENO	NV	89519
014-192-21	TRACIE L	TOMLINSON LIVING TRUST	PO BOX 20245		RENO	NV	89515
014-192-22	MICHAEL N	GOOCH et al	1625 SHANGRI-LA DR		RENO	NV	89509
014-192-23	LEO W	KNUF FAMILY TRUST	1047 MANOR DR		RENO	NV	89509
014-192-24	JAMES V	CATHEY FAMILY TRUST	755 SHANGRI-LA DR		RENO	NV	89509
014-192-25	MERYL B & ERIK	BURKE	775 SHANGRI-LA DR		RENO	NV	89509
014-192-27	JASMIN S	VAUGHT	5425 E BROADWAY BLVD 174	C/O JASMIN VAUGHT	TUCSON	AZ	85711
014-192-28	KACI	STRICKLAND	795 SHANGRI-LA DR		RENO	NV	89509
014-192-29	JOSEPH	STRICKLAND	793 SHANGRI-LA DR		RENO	NV	89509
014-194-01		YAXLEY FAMILY LIVING TRUST 1B	4320 TERRA GRANADA DR #		WALNUT CREEK	CA	94595
014-194-02	ARTHUR H & DOLORES	NEWTON	1070 AKARD DR		RENO	NV	89503
014-194-24	JAMES G	STEGMAIER et al	1285 BARING BLVD # 271		SPARKS	NV	89434
014-194-25	CHRISTOPHER	ORBERG	2993 RUSTIC MANOR CIR		RENO	NV	89509

APN	First Name	Last Name	Mailing 1	Mailing 2	City	State	Zip
014-194-26	SUSAN L	FRANKENBERG	521 MODOC AVE		RENO	NV	89509
014-194-27	KATHY JO	COOPER LIVING TRUST	1650 LANDER ST		RENO	NV	89509
014-201-03	PAUL A	LUCAS	1701 SHANGRI-LA DR		RENO	NV	89509
014-201-04		BD INVESTMENTS LLC	PO BOX 11770		RENO	NV	89510
014-201-06	ALICE J	DYE et al	1795 LANDER ST		RENO	NV	89509
014-201-07		POLK CALLAGHAN FAMILY LIVING TRUST	473 GAMES DR		RENO	NV	89509
014-201-08	CHRISTIAN T	EBERHARDT et al	1780 SHANGRI-LA DR		RENO	NV	89509
014-201-27		POTTER FAMILY TRUST	1725 LANDER ST		RENO	NV	89509
014-201-28	TODD & LORI	SMITH FAMILY TRUST	1750 SHANGRI-LA DR		RENO	NV	89509
014-202-01	JAYME	LOWE	530 MODOC AVE		RENO	NV	89509
014-202-02		GEORGESON FAMILY TRUST et al	4280 MUIRWOOD CIR		RENO	NV	89509
014-202-04	C JAMES & SHAREN	al SEQUEIRA FAMILY TRUST	826 PONY EXPRESS TRL		DAYTON	NV	89403
014-202-05	JEROME R & K W	DURKIN	1607 WATT ST		RENO	NV	89509
014-202-09		HALL FAMILY TRUST	1690 MEADOWVIEW LN		RENO	NV	89509
014-202-10	DEVON M	MENDEZ et al	511 TOIYABE ST		RENO	NV	89509
014-202-11	BARBARA L	GUZMAN	2995 EAGLE ST		WASHOE VALLEY	NV	89704
014-202-12	IVY	GUILD et al	535 TOIYABE ST		RENO	NV	89509
014-202-13	MATTHEW S	BAKER et al	545 TOIYABE ST		RENO	NV	89509
014-202-14	DAVID G JR	KRETCHMAN et al	1690 LANDER ST		RENO	NV	89509
014-203-01		SLOAN FAMILY TRUST	5340 WILDWOOD DR		RENO	NV	89511
014-203-02		GILBERT FAMILY TRUST	50 ROBIN PL		RENO	NV	89509
014-203-03	ELIZABETH J	FORES et al	540 TOIYABE ST		RENO	NV	89509
014-203-04	BOUNYO L	YU et al	530 TOIYABE ST		RENO	NV	89509
014-203-05	EMMA	BACHARACH	510 TOIYABE ST		RENO	NV	89509
014-203-06	EVE L	HALL LIVING TRUST	500 TOIYABE ST		RENO	NV	89509
014-203-20	JOSEPH	HOEL	8 LANDERS ST UNIT 103		SAN FRANCISCO	CA	94114
014-203-21		ALLEN LIVING TRUST	449 W PLUMB LN		RENO	NV	89509
014-203-22	LANCE & JOYCE M	LEHIGH	1890 LANDER ST		RENO	NV	89509
014-203-23	ALI	BEHZAD	1240 MARSH AVE		RENO	NV	89509
014-203-24		HANNAH FAMILY TRUST	450 GAMES DR		RENO	NV	89509
014-203-25	JOSHUA	FUSS et al	446 GAMES DR		RENO	NV	89509

APN	First Name	Last Name	Mailing 1	Mailing 2	City	State	Zip
014-203-26	HARVEY W	LAMBERT TRUST	445 GAMES DR		RENO	NV	89509
014-203-27	GABRIEL F & IDA M	PERRY INTERVIVOS TRUST	101 RACHEL LN		YORKTOWN	VA	23692-4
014-203-28	PETER V	RISSONE et al	3480 NOWLIN LN		SPARKS	NV	89431
014-203-29	BARRY S & TONYA	WARDELL	1750 LANDER ST		RENO	NV	89509
014-203-32		FIFTEENTH STREET LLC	333 HOLCOMB AVE STE 300	C/O DICKSON PROPERTY MANAGEMENT	RENO	NV	89502
014-204-01	SHANNON & CHRISTIAN	HYNES	1698 SHANGRI-LA DR		RENO	NV	89509
014-204-02		FRANCIS LIVING TRUST	1710 SHANGRI-LA DR		RENO	NV	89509
014-204-04	MARC G & LAURIE J	WARREN	175 RIVERBROOK CT		RENO	NV	89519
014-204-05		SIMON FAMILY SURVIVOR'S TRUST	1795 SHANGRI-LA DR		RENO	NV	89509
014-204-06		EGAN FAMILY TRUST	480 GAMES DR		RENO	NV	89509
014-204-07	RICHARD S	PARRINO	476 GAMES DR		RENO	NV	89509
014-204-08	DOMINIC	LUCIA et al	470 GAMES DR		RENO	NV	89509
014-204-09	GEORGE JR & ARLENE	SUMMERHILL FAMILY TRUST	2120 DANT BLVD		RENO	NV	89509
014-204-10	JESSE P	MAHR et al	1895 LANDER ST		RENO	NV	89509
014-204-11	FLORENCE R	CORIZ	473 W PLUMB LN		RENO	NV	89509
014-204-12		MCCORKLE FARMS INC	2470 COUNTRY RD WW		GLENN	CA	95943
014-204-13	DAVID & YENI M	CASAS	485 W PLUMB LN		RENO	NV	89509
014-204-14	WILLIAM E	CARROLL	491 W PLUMB LN		RENO	NV	89509
014-204-15		GO BLUE WATER LLC	1820 S ARLINGTON AVE		RENO	NV	89509
014-204-16		DURANT BENDER FAMILY TRUST	10037 E RIVER ST		TRUCKEE	CA	96161
014-204-18		GRABA PROPERTIES LLC	1720 S ARLINGTON AVE		RENO	NV	89509
014-204-19		GRANATA BATTEAUW FAMILY TRUST	1720 S ARLINGTON AVE		RENO	NV	89509
014-204-20	JOHN M & LINDA A	LITTLE	1764 S ARLINGTON AVE		RENO	NV	89509
014-300-00		OWNERS OF CONDOMINIUM PM 2506	COMMON AREA		NONE	NV	00000
014-300-01		HAWC LLC	3640 PLUMAS ST		RENO	NV	89509
014-300-03		SFG CAPITAL LLC	700 EL CAMINO DEL MAR		SAN FRANCISCO	CA	94121
019-022-22	DREW L	CORTRIGHT	182 DIAMOND ST		SAN FRANCISCO	CA	94114
019-023-16		BEBOUT FAMILY TRUST	1070 GOLCONDA DR		RENO	NV	89509



APN	First Name	Last Name	Mailing 1	Mailing 2	City	State	Zip
019-023-20		BELLE MEADE PROPERTIES LLC	757 SKYLINE BLVD		RENO	NV	89509
019-023-33	H SIDNEY	ROBINSON TRUST	602 ALLEY OOP		RENO	NV	89509
019-023-34	MARILYN	HARPER	612 ALLEY OOP		RENO	NV	89509
019-023-35	VINCENT E	GOICOECHEA TRUST et al	622 ALLEY OOP		RENO	NV	89509
019-023-36	KRIS	NELSON	632 ALLEY OOP		RENO	NV	89509
019-023-37	KRISZTINA	DOMBOVARI	550 W PLUMB LN STE B507		RENO	NV	89509
019-023-38	MICHAEL A	SHEPPARD et al	44-014 NOHOKAI PL		KANEHOE	HI	96744
019-023-41		JOSEFS VIENNA BAKERY & CAFE	9480 BALDACC I RD		RENO	NV	89521
019-033-10	PETER R	BOOTH	921 COUNTRY ESTATES CIR		RENO	NV	89511
019-033-11	ISAAC	CONDE et al	1155 YATES LN		RENO	NV	89509
019-033-12		AMICAL HOLDINGS LLC	1155 S ROCK BLVD # 400		RENO	NV	89502
019-033-14	JOSEPH	LLEWELLYN LIVING TRUST	755 HILLCREST DR		RENO	NV	89509
019-033-19		GOPINATH FAMILY TRUST	375 CHEVY CHASE ST		RENO	NV	89509
019-033-47	STACIA	BLETCHER-HOOFT TRUST et al	3007 OREANA DR		RENO	NV	89509
019-033-50		550 W PLUMB LLC	1475 TERMINAL WAY STE A	C/O NCS	RENO	NV	89502
019-033-51		RENO RISING LLC	333 HOLCOMB AVE # 300	C/O DCG MANAGEMENT INC	RENO	NV	89502
019-033-54		AURORA PROPERTIES LLC	123 LITTLEFIELD RD		MONTEREY	CA	93940
019-033-55		500 WEST PLUMB LANE LLC	500 W PLUMB LN STE A	ATTN: PATRICK TRAVIS ADLINGTON	RENO	NV	89509
019-033-58	LAWRENCE	MONTGOMERY et al	2040 S ARLINGTON AVE		RENO	NV	89509
019-033-60		DOG VALLEY PARTNERS LLC	510 W PLUMB LN STE A		RENO	NV	89509
019-033-61		BRISTLECONE PROPERTIES LLC	510 W PLUMB LN STE B		RENO	NV	89509
019-033-62		BRISTLECONE PROPERTIES LLC et al	510 W PLUMB LN STE B		RENO	NV	89509
019-033-63		HARDWOOD ENTERPRISES LLC	548 W PLUMB LN STE B		RENO	NV	89509
019-033-64		ELBEE LLC	3260 ARGO WAY		RENO	NV	89509
019-510-01		540 W PLUMB LANE MAINT ASSN	3545 AIRWAY DR STE 113		RENO	NV	89511-1
019-511-01		MALLARD INVESTMENTS LLC	3545 AIRWAY DR STE 113	C/O COMMERCIAL PROJECT MANAGEMENT	RENO	NV	89511
019-512-04		TOTW LLC	540 W PLUMB LN STE 200		RENO	NV	89509
019-512-06		CHEBURASHKA LLC	811 JEFFREY CT		INCLINE VILLAGE	NV	89451
App/Agent	Jeff	Bender	10037 E River St		Truckee	CA	96161

APN	First Name	Last Name	Mailing 1	Mailing 2	City	State	Zip
Owner	Yvette	Durant	1825 Watt St	Trustee Marcel J Durant Family Trust	Reno	NV	89509
Ward 2 NAB	Mimi	Fuji-Strickler	835 Huffaker Estates Cir		Reno	NV	89511
Ward 2 NAB	Donna	Keats	2265 Sunrise Dr		Reno	NV	89509
Ward 2 NAB	Stacey	Shinn	4932 Meadow Springs Dr		Reno	NV	89509
Ward 2 NAB	Stan	Dowdy	2700 Plumas St #302		Reno	NV	89509
Ward 2 NAB	David	Titzel	2170 Humboldt St		Reno	NV	89509
Ward 2 NAB	Audrey	Keller	720 Marewood Trail		Reno	NV	89511
Ward 2 NAB	Hal	Taylor	2251 W Lakeridge Shores		Reno	NV	89519
Ward 2 NAB	Patrick	Fisher	6400 Bonde Farms Lane		Reno	NV	89511
Ward 2 NAB	Roman	Schomberg	660 Caspian Ct		Reno	NV	89521
Ward 2 NAB	Sean	McCoy	1785 Sandpoint Circle		Reno	NV	89509
Ward 2 NAB	Kristen	Montan	3095 Lakeside Dr. #302		Reno	NV	89509
Ward 2 NAB	James	Cashell	4847 Lakeridge Terrace W		Reno	NV	89509
Ward 2 NAB	Michael	Ginsburg	4690 Sommerville Way		Reno	NV	89519

## Report Totals

Count: 160

Date Exported: 4/2/2025 8:30 AM

PIN (Count): 160

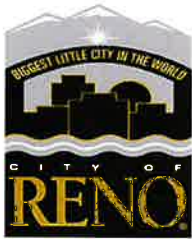

# CITY OF RENO PRINT ORDER FORM

Job Name : LDC25-00038 (ARLINGTON OFFICE MPA & ZMA)

## Contact Information (required fields):

Name: LAUREN MORRIS

Date File is Available: 4/3/2025

Dept/Division: CITY CLERKS OFFICE

Date Order Due: 4/8/2025

Contact Phone #: 775-334-2030

Contact Email: CITYCLERK@RENO.GOV

0371-7400-6000-

PRODUCTION

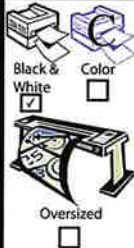

Copies Sides Page Size

160

SS

DS

8.5 X 11

8.5 X 14

11 X 17

Paper Type & Color:

Paper Color: Blue

Paper Weight:

Paper Choices*			
Pastel	Available Sizes & Weights	Prights (letter size only)	Available Weights
Blue	Letter, Legal, & Cardstock	Cosmic Orange	24 lb & cardstock
Green	Letter, Legal, & Cardstock	Gamma Green	24 lb
Ivory	Letter, Legal, & Cardstock	Lift-Off Lemon	24 lb
Yellow	Letter, Cardstock	Lunar Blue	24 lb & cardstock
Pink	Letter, Legal	Planetary Purple	24 lb
Goldenrod	Letter, Legal	Pulsar Pink	24 lb
Buff	Letter	Re-Entry Red	24 lb & cardstock
Lilac	Letter	Solar Yellow	24 lb & cardstock
Salmon	Letter	Terra Green	24 lb & cardstock

\* Other paper options are available, please specify in Special Instructions

Collated

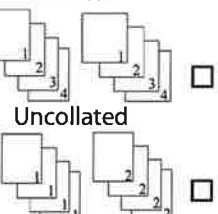

Uncollated

Binding



COIL BINDING



COMB BINDING



WIRE BINDING

Binding:

☐ Comb Bind

☐ Coil Bind

☐ Tape Bind

Binding color (pick one): navy

☐ Front cover:

☐ Clear

☐ Regency

☐ Cardstock

Color: navy

☐ Back cover:

☐ Clear

☐ Regency

☐ Cardstock

Color: navy

☐ 3-ring Binder

Size:

Color: navy



VELO BINDING



TAPE BINDING



PERFECT BINDING

FINISHING

Laminate/  
Mount

Laminating



☐ Glossy  
☐ Matte

Pouch Size

8.5 X 11

8.5 X 14

11 X 17

Mounting



☐ Foam

Carbonless paper:

☐ 2-part

☐ Color

☐ 3-part

☐ BW

☐ 4-part

Finish

STAPLING

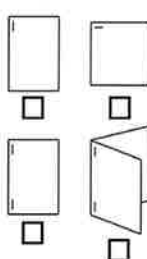

FOLDING

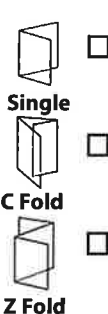

CUTTING

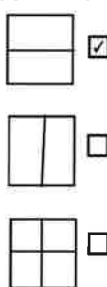

DRILLING PADS

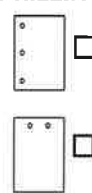

How many pads?

Pages per pad:

SHRINKWRAP



TABS



Tab Font

Tab Text

1. \_\_\_\_\_
2. \_\_\_\_\_
3. \_\_\_\_\_
4. \_\_\_\_\_
5. \_\_\_\_\_
6. \_\_\_\_\_
7. \_\_\_\_\_
8. \_\_\_\_\_
9. \_\_\_\_\_
10. \_\_\_\_\_

## Special Instructions

BLUE POSTCARDS - DELIVERED TO RENO CITY HALL, 2ND FLOOR CLERKS OFFICE BY TUESDAY, APRIL 8, 2025, AT 10 AM.

THANK YOU!