

John Fleming

artistic approach / process



Community Input Survey

- What do you love about the area?
- What makes the area unique?
- Important themes:
- Striking elements for public art:

6 out of 9 said the **Truckee River**.

Truckee River

64% said the **Outdoor Environment — The River**

82% **Story-telling**, 73% **Vivid color**, 40% **Repurposed Materials**.

We started our float at Mayberry Park, along with a whole menagerie of others — Rafters, kayaks, a dozen people in tubes. The river pick up speed near Whitewater Park. Kayakers and surfers played in the standing waves and eddies.



The community could write their own stories... in vivid color... and repurposed materials.

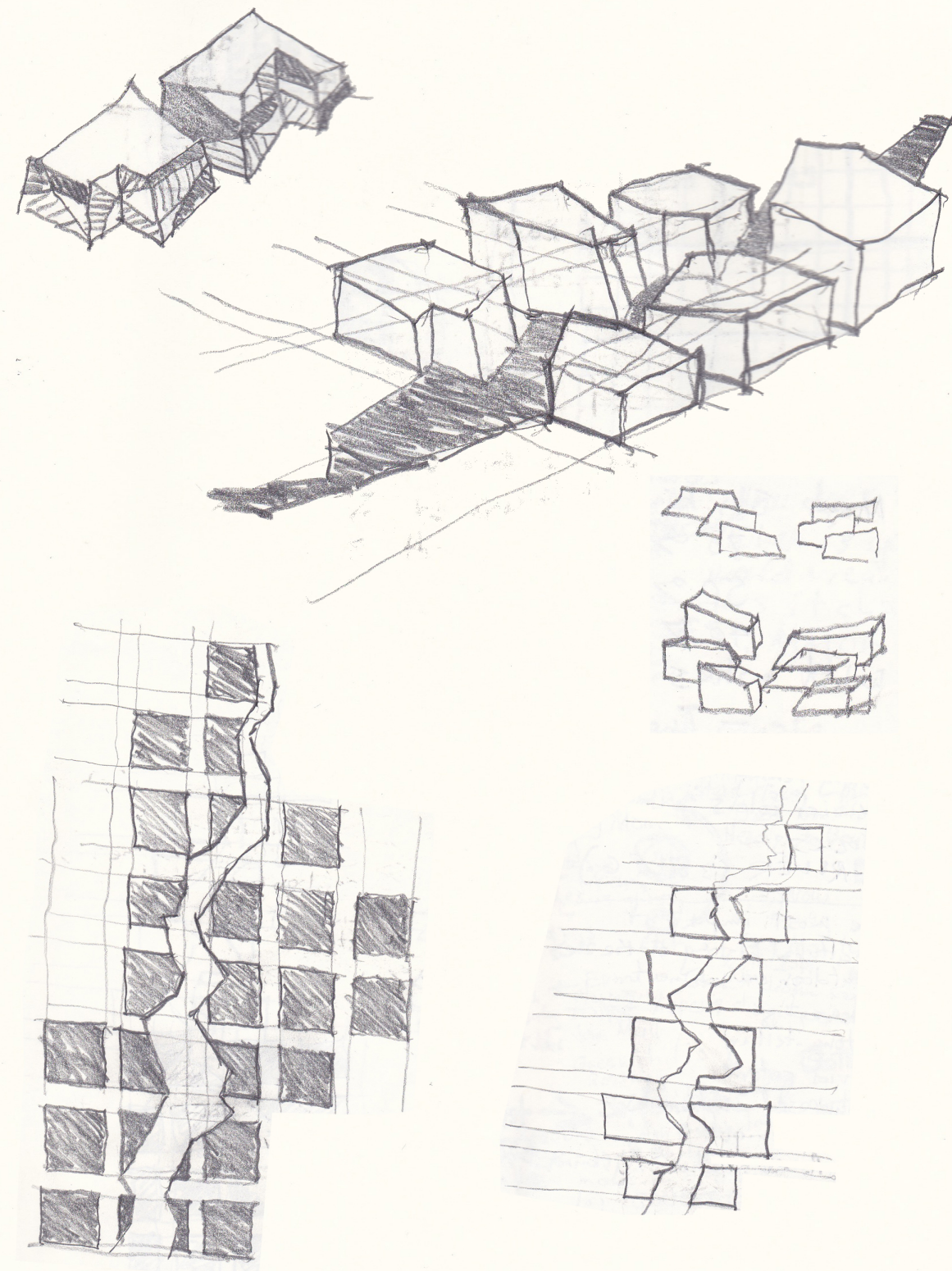

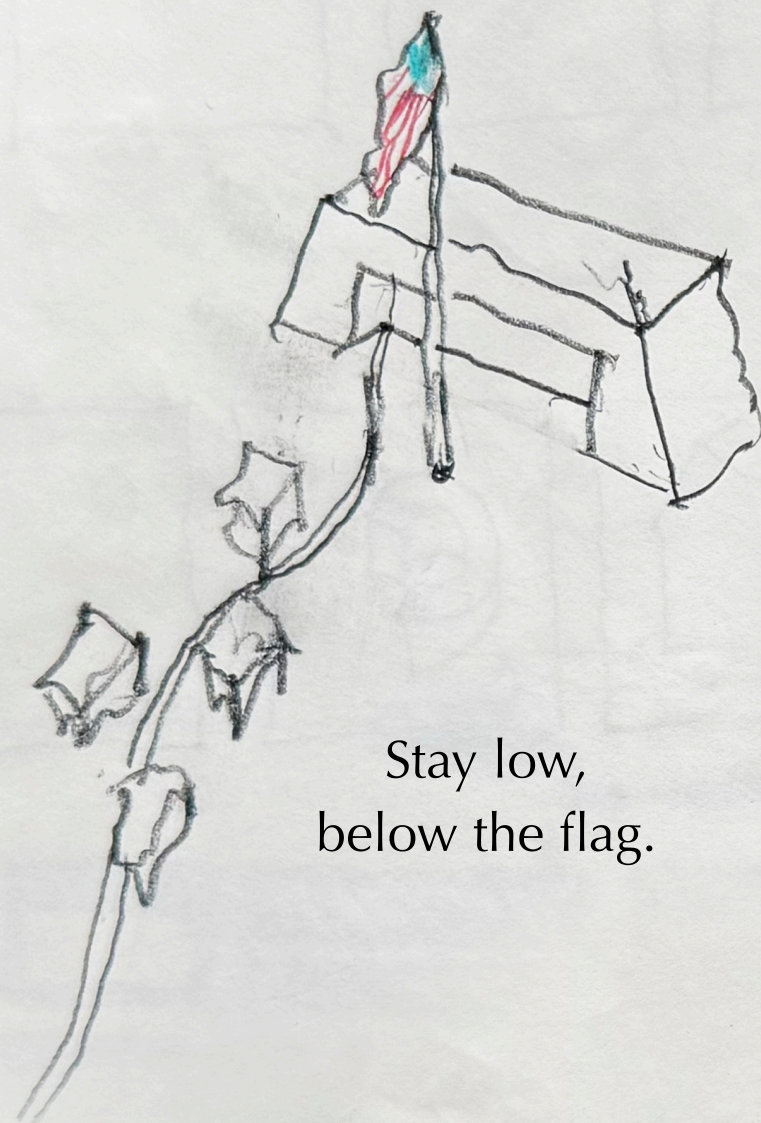

Stay low,
below the flag.

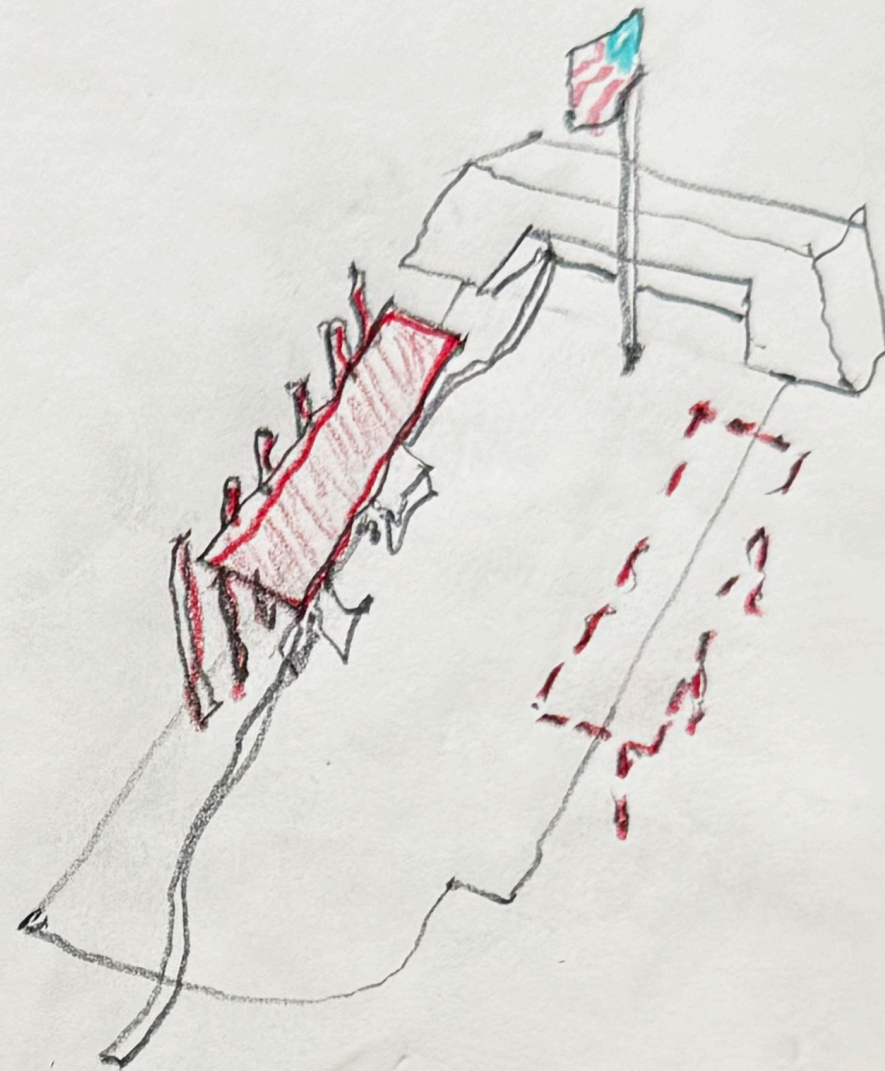

Art offering shade? A place to sit?

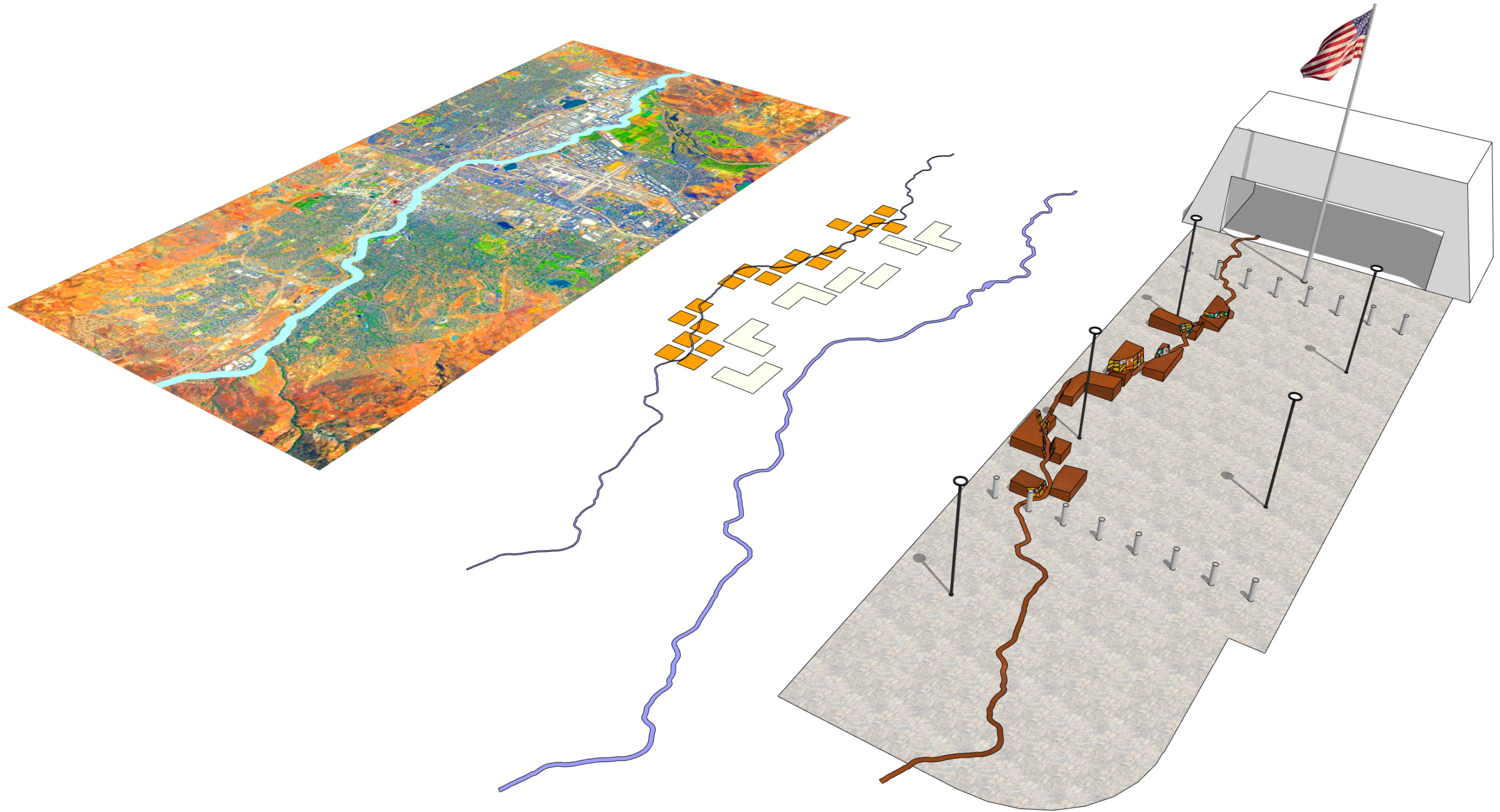

The *Truckee River* — Seems like an *idea* we all share.



at at Mayberry Park. We drifted past families picnicking on the banks, anglers casting their lines. We caught up with fellow paddler