

NOTICE OF PUBLIC HEARINGS

NOTICE IS HEREBY GIVEN that the City Council of the City of Reno will hold the below listed public hearing in the Council Chambers of the Reno City Hall, One East First Street, First Floor, on **May 7, 2025**, commencing at the time indicated.

10:00 a.m. – LDC25-00037 (Rancharra Planned Unit Development Master Plan Amendment & Handbook Amendment)

A request has been made for: 1) a Master Plan amendment from Parks, Greenways, and Open Space (PGOS) to Single-Family Neighborhood (SF); and, 2) an amendment to the Rancharra Planned Unit Development (PUD) Handbook to: a) change a ± 7.2 acre portion of the land use plan from Equestrian Center to Single-Family in order to create Village 8; b) reduce the total number of units from 722 to 469 units; c) modify the objectives of the PUD by removing all references to “equestrian” and “riding facilities”; and d) update the Flexibility section to reflect current RMC processes and other miscellaneous updates to reflect current RMC references. The ± 6.0 acre Master Plan Amendment site is located west of the intersection of Falabella Way and Silver Charm Way, east of Bartley Ranch Regional Park. The ± 140 acre PUD is generally located on the northwest corner of Kietzke Lane and Del Monte Lane. The PUD has Master Plan land use designations of PGOS, Single-Family Neighborhood (SF), Large-Lot Neighborhood (LL), and Suburban Mixed-Use (SMU).

Those who wish to submit public comment relative to the above, may do so by submitting public comment through the online public comment form found at Reno.Gov/PublicComment or by email to PublicComment@reno.gov. Comments received prior to 4:00 p.m. on the day preceding the meeting will be transcribed, provided to the City Council for review, and entered into the record. Comments received after 4:00 pm on the day preceding the meeting will be provided to the City Council for review prior to adjournment and entered into the record.

All interested persons are invited to present testimony.

MIKKI HUNTSMAN, CLERK AND CLERK OF THE RENO CITY COUNCIL



Order Confirmation

Not an Invoice

Account Number:	1118454
Customer Name:	City of Reno - Legals
Customer Address:	City of Reno - Legals 1 E 1ST Street FL 2 Reno NV 89501
Contact Name:	Lauren Morris
Contact Phone:	
Contact Email:	MorrisL@reno.gov
PO Number:	LDC25-00037

Date:	04/17/2025
Order Number:	11239669
Prepayment Amount:	\$ 0.00

Column Count:	1.0000
Line Count:	86.0000
Height in Inches:	8.9000

Print

Product	#Insertions	Start - End	Category
RGJ Reno Gazette-Journal	1	04/25/2025 - 04/25/2025	Govt Public Notices
RGJ rgi.com	1	04/25/2025 - 04/25/2025	Govt Public Notices

As an incentive for customers, we provide a discount off the total order cost equal to the 3.99% service fee if you pay with Cash/Check/ACH. Pay by Cash/Check/ACH and save!

Total Cash Order Confirmation Amount Due	\$211.08
Tax Amount	\$0.00
Service Fee 3.99%	\$8.42
Cash/Check/ACH Discount	-\$8.42
Payment Amount by Cash/Check/ACH	\$211.08
Payment Amount by Credit Card	\$219.50

Order Confirmation Amount

\$211.08

Ad Preview

NOTICE OF PUBLIC

HEARINGS

NOTICE IS HEREBY GIVEN that the City Council of the City of Reno will hold the below listed public hearing in the Council Chambers of the Reno City Hall, One East Street, 5th Floor, on May 7, 2025, commencing at the time indicated.

10:00 a.m. - 1:00 p.m.
Ranchorch Planned Unit Development Master Plan Amendment & Handbook

A request has been made for: 1) a Master Plan amendment from Parks, Greenways, and Open Space (PGOS) to Single-Family Neighborhood (SF); and, 2) on amendment to the Ranchorch Planned Unit Development (PUD) Handbook to: a) change a ±72 acre portion of the land use plan from Equestrian Center to Single-Family in order to create Village 8; b) reduce the total number of units from 172 to 69 units; c) modify the existing PUD by removing all references to "equestrian" and "riding facilities"; and d) update the Flexibility section to reflect current RMC processes and other miscellaneous updates to reflect current RMC references. The Amendment site is located west of the intersection of Faldabella Way and Silver Charm Way, east of Bartley Ranch Regional Park. The ±140 acre PUD is generally located on the northwest corner of Kestrel Lane and Del Monte Lane. The PUD has Master Plan land use designations of PGOS, Single-Family Neighborhood (SF), Large-Lot Neighborhood (LL), and Suburban Mixed-Use (SMU). To submit public comment relative to the above, may do so by submitting public comment through the online public comment form found at Reno.gov/PublicComment or by email to PublicComment@reno.gov. Comments received after 4:00 pm on the day preceding the meeting will be provided to the City Council for review prior to adjournment and entered into the record. Comments received after 4:00 pm on the day preceding the meeting will be provided to the City Council for review prior to adjournment and entered into the record. All interested persons are invited to present testimony.

HUNTSMAN, MIKE
CLERK AND CLERK OF THE RENO CITY COUNCIL
No. 123669 April 25, 2025



City of Reno - Legals
1 E 1ST Street FL 2
Reno, NV 89501
USA

Receipt	
Account No.:	1118454
Receipt No.:	5681098
Receipt Date:	4/17/2025
Total Cash Amt:	\$ 211.08
Service Fee 3.99%:	\$ 8.42
Cash/Check/ACH Discount:	\$ 0.00
Paid Amount:	\$ 219.50

Date	Doc Type	Doc No.	Customer	Allocation type	Allocated
4/17/2025	Order	11239669	City of Reno - Legals	Opp	211.08
	Mastercard		8219		

Abbreviation	Document type
Ip	Invoice Payment
Pa, Opp	Payment allocation, Order Pre-payment

Thank you for your payment!

Thank you for your planning application submittal. The following information is to be populated into the interactive form for public notice as required by Reno Municipal Code. The form will produce a PDF version of the Public Notice sign for you to print and post at the project proposal location. If you have any questions concerning this process, please contact (775) 334-2030.

To get started go to:

<https://www.reno.gov/government/departments/development-services/planning-and-engineering-applications>

Select the “**Other Resources**” dropdown and select the applicable form for **Public Hearing Notice – City Council**

Your case is scheduled for the May 7, 2025, City Council Meeting at 10:00 AM.

Please enter the meeting date and time, case number, case name and planner’s name into the corresponding fields. Also, you must input the Applicant’s name as listed on the application.

CASE NO: LDC25-00037

CASE NAME: RANCHARRAH PUD HANDBOOK AMENDMENT & MPA

PLANNER: LEAH PICCOTTI

Please copy and paste the below project description into the DESCRIPTION field:

A request has been made for: 1) a Master Plan amendment from Parks, Greenways, and Open Space (PGOS) to Single-Family Neighborhood (SF); and, 2) an amendment to the RancharraH Planned Unit Development (PUD) Handbook to: a) change a ±7.2 acre portion of the land use plan from Equestrian Center to Single-Family in order to create Village 8; b) reduce the total number of units from 722 to 469 units; c) modify the objectives of the PUD by removing all references to “equestrian” and “riding facilities”; and d) update the Flexibility section to reflect current RMC processes and other miscellaneous updates to reflect current RMC references. The ±6.0 acre Master Plan Amendment site is located west of the intersection of Falabella Way and Silver Charm Way, east of Bartley Ranch Regional Park. The ±140 acre PUD is generally located on the northwest corner of Kietzke Lane and Del Monte Lane. The PUD has Master Plan land use designations of PGOS, Single-Family Neighborhood (SF), Large-Lot Neighborhood (LL), and Suburban Mixed-Use (SMU).

Those who wish to submit public comment relative to the above, may do so by submitting public comment through the online public comment form found at Reno.Gov/PublicComment or by email to PublicComment@reno.gov. Comments received prior to 4:00 p.m. on the day preceding the meeting will be transcribed, provided to City Council for review, and entered into the record. Comments received after 4:00 pm on the day preceding the meeting will be provided to the City Council for review prior to adjournment, and entered into the record.

*Once you have populated all required fields, please download the form and review it to ensure the posting notice information is complete and correct. This may be printed at a sign shop or copy center of your choosing. Please note that the format is **36 inches wide by 48 inches tall** and must be printed on astrobright yellow paper.*

Maps of number of postings and posting locations have been provided via email.

*The public notice sign(s) must be on-site no later than **Friday, April 25, 2025, at 5:00 p.m.***

Please submit legible photographic proof of posting to our office at 1 East First Street, 2nd Floor or via email to cityclerk@reno.gov. Signs must be clear and legible.

RECEIVED

APR 25 2025

CITY CLERK

PUBLIC NOTICE

A PUBLIC HEARING WILL BE HELD BY THE RENO CITY COUNCIL
IN THE CITY COUNCIL CHAMBERS AT RENO CITY HALL, 1 EAST
FIRST STREET, RENO, NEVADA.

HEARING DATE & TIME: WEDNESDAY May 7, 2025 at 10:00 AM

APPLICANT: Wood Rodgers, Inc.

CASE NUMBER: LDC25-00037

PROJECT NAME: RANCHARRAH PUD HANDBOOK AMENDMENT & MPA

DESCRIPTION: A request has been made for: 1) a Master Plan amendment from Parks, Greenways, and Open Space (PGOS) to Single-Family Neighborhood (SF); and, 2) an amendment to the Rancharran Planned Unit Development (PUD) Handbook to: a) change a 27.2 acre portion of the land use plan from Equestrian Center to Single-Family in order to create Village B; b) reduce the total number of units from 722 to 469 units; c) modify the objectives of the PUD by removing all references to "equestrian" and "riding facilities"; and d) update the Flexibility section to reflect current RMC processes and other miscellaneous updates to reflect current RMC references. The 16.0 acre Master Plan Amendment site is located west of the intersection of Falabella Way and Silver Charm Way, east of Bartley Ranch Regional Park. The 140 acre PUD is generally located on the northwest corner of Kietzke Lane and Del Monte Lane. The PUD has Master Plan land use designations of PGOS, Single-Family Neighborhood (SF), Large-Lot Neighborhood (LL), and Suburban Mixed-Use (SMU).

Those who wish to submit public comment relative to the above, may do so by submitting public comment through the online public comment form found at Reno.Gov/PublicComment or by email to PublicComments@reno.gov. Comments received prior to 4:00 p.m. on the day preceding the meeting will be transcribed, provided to City Council for review, and entered into the record. Comments received after 4:00 p.m. on the day preceding the meeting will be provided to the City Council for review prior to adjournment, and entered into the record.

Leah Piccotti - 334-2178
CITY OF RENO
Development Services Department
P.O. Box 1950
Reno, NV 89505

The applicant shall provide this sign within 5 days
after the approval period for the public hearing has expired.



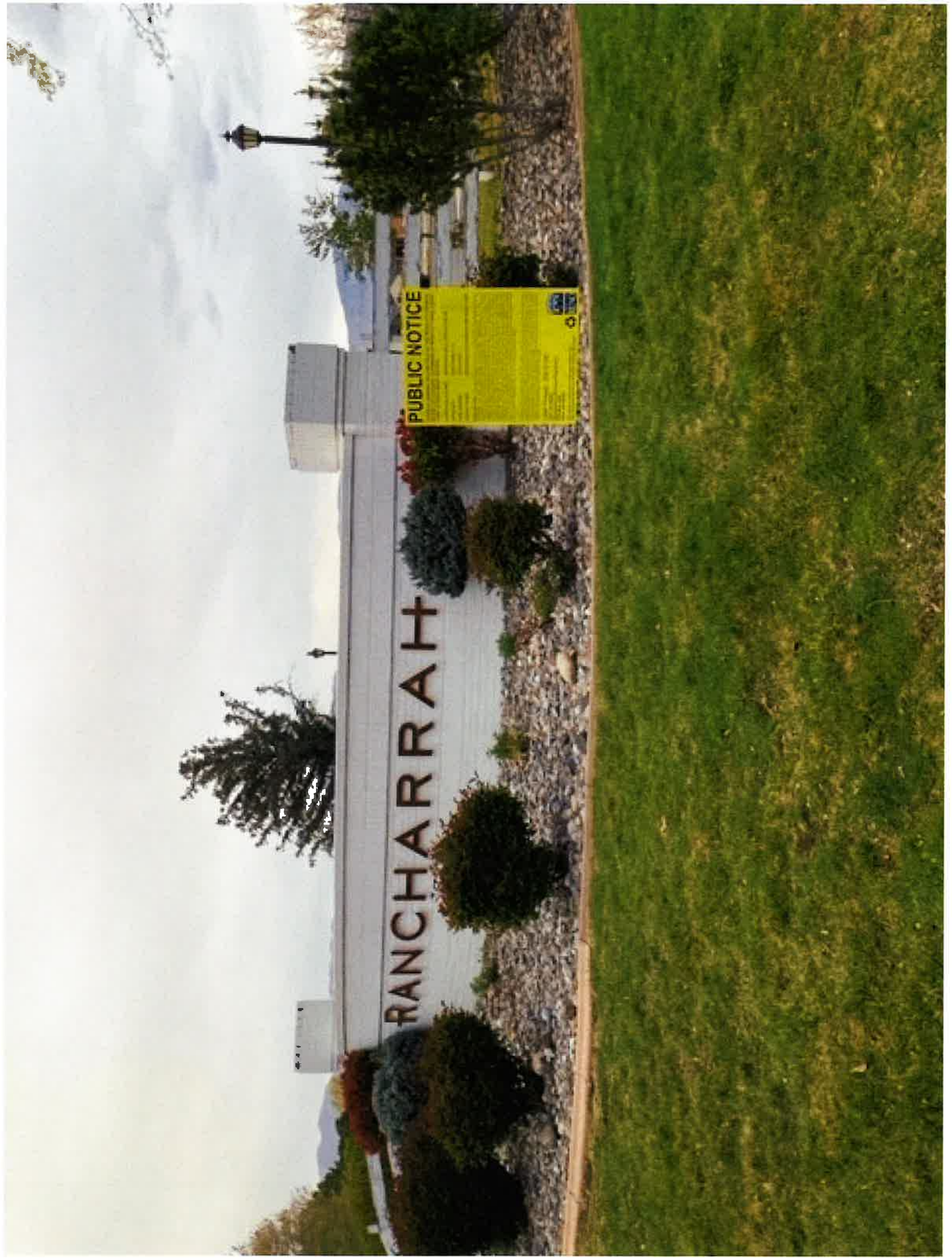

PUBLIC NOTICE

A PUBLIC HEARING WILL BE HELD BY THE RENO CITY COUNCIL
IN THE CITY COUNCIL CHAMBERS AT RENO CITY HALL, 1 EAST
FIRST STREET, RENO, NEVADA.

HEARING DATE & TIME: WEDNESDAY May 7, 2025 at 10:00 AM

APPLICANT: Wood Rodgers, Inc.

CASE NUMBER: LDC25-00037

PROJECT NAME: RANCHARRAH PUD HANDBOOK AMENDMENT & MPA

DESCRIPTION: A request has been made for: 1) a Master Plan amendment from Parks, Greenways, and Open Space (PGOS) to Single-Family Neighborhood (SF); and, 2) an amendment to the Rancharrah Planned Unit Development (PUD) Handbook to: a) change a 17.2 acre portion of the land use plan from Equestrian Center to Single-Family in order to create Village 8; b) reduce the total number of units from 722 to 469 units; c) modify the objectives of the PUD by removing all references to "equestrian" and "riding facilities"; and d) update the Flexibility section to reflect current RMC processes and other miscellaneous updates to reflect current RMC references. The 16.0 acre Master Plan Amendment site is located west of the intersection of Felabella Way and Silver Charm Way, east of Bartley Ranch Regional Park. The 146-acre PUD is generally located on the northwest corner of Kietzke Lane and Del Monte Lane. The PUD has Master Plan land use designations of PGOS, Single-Family Neighborhood (SF), Large-Lot Neighborhood (LL), and Suburban Mixed-Use (SMU).

Those who wish to submit public comment relative to the above, may do so by submitting public comment through the online public comment form found at Reno.Gov/PublicComment or by email to PublicComment@reno.gov. Comments received prior to 4:00 p.m. on the day preceding the meeting will be transcribed, provided to City Council for review, and entered into the record. Comments received after 4:00 pm on the day preceding the meeting will be provided to the City Council for review prior to adjournment, and entered into the record.

Leah Piccotti - 334-2178

CITY OF RENO
Development Services Department
P.O. Box 1900
Reno, NV 89505

The applicant shall remove this sign within 5 days
after the appeal period for the public hearing has ended.



PUBLIC NOTICE

A PUBLIC HEARING WILL BE HELD BY THE RENO CITY COUNCIL
IN THE CITY COUNCIL CHAMBERS AT RENO CITY HALL, 1 EAST
FIRST STREET, RENO, NEVADA.

HEARING DATE & TIME: WEDNESDAY May 7, 2025 at 10:00 AM

APPLICANT: Wood Rodgers, Inc.

CASE NUMBER: LDC25-00037

PROJECT NAME: RANCHARRAH PUD HANDBOOK AMENDMENT & MPA

DESCRIPTION: A request has been made for: 1) a Master Plan amendment from Parks, Greenways, and Open Space (PGOS) to Single-Family Neighborhood (SF); and, 2) an amendment to the Rancharrah Planned Unit Development (PUD) Handbook to: a) change a 17.2 acre portion of the land use plan from Equestrian Center to Single-Family in order to create Village B; b) reduce the total number of units from 722 to 469 units; c) modify the objectives of the PUD by removing all references to "equestrian" and "riding facilities"; and d) update the Flexibility section to reflect current RMC processes and other miscellaneous updates to reflect current RMC references. The 26.0 acre Master Plan Amendment site is located west of the intersection of Faliobella Way and Silver Charm Way, east of Bartley Ranch Regional Park. The ±140 acre PUD is generally located on the northwest corner of Kietzke Lane and Del Monte Lane. The PUD has Master Plan land use designations of PGOS, Single-Family Neighborhood (SF), Large-Lot Neighborhood (LL), and Suburban Mixed-Use (SMU).

Those who wish to submit public comment relative to the above, may do so by submitting public comment through the online public comment form found at RenoGov/PublicComment or by email to PublicComment@reno.gov. Comments received prior to 4:00 p.m. on the day preceding the meeting will be transcribed, provided to City Council for review, and entered into the record. Comments received after 4:00 p.m. on the day preceding the meeting will be provided to the City Council for review prior to adjournment, and entered into the record.

Leah Piccotti - 334-2178

CITY OF RENO
Development Services Department
P.O. Box 1900
Reno, NV 89505

The applicant shall remove this sign within 5 days
after the appeal period for the public hearing has expired.



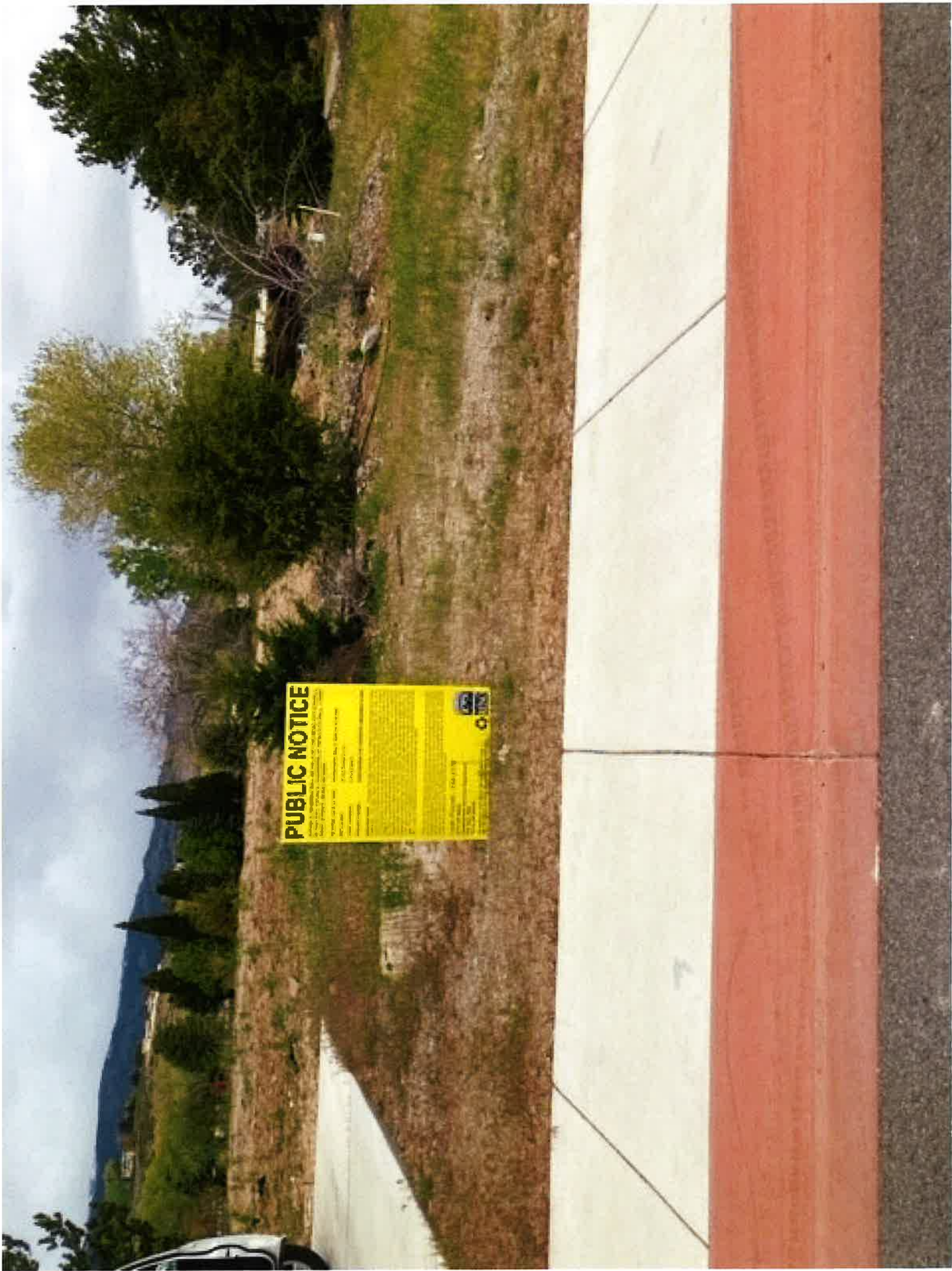

PUBLIC NOTICE

Notice is hereby given that the Board of Directors of the City of [City Name] will hold a public hearing on [Date] at [Time] in the [Location] to consider the proposed [Project Name] and to receive public comments on the same. The proposed project is located at [Address]. The project is described in the attached [Document Name]. The public hearing is open to all interested parties. Any person wishing to comment on the proposed project should appear at the public hearing and make their comments known to the Board of Directors. The Board of Directors will make a decision on the proposed project at the public hearing. The decision will be final and binding on the City of [City Name].

City of [City Name]
Board of Directors
[Address]
[City, State, Zip]
[Phone Number]
[Email Address]

Site Posting Location

Rancharrah PUD Amendment & Master Plan Amendment

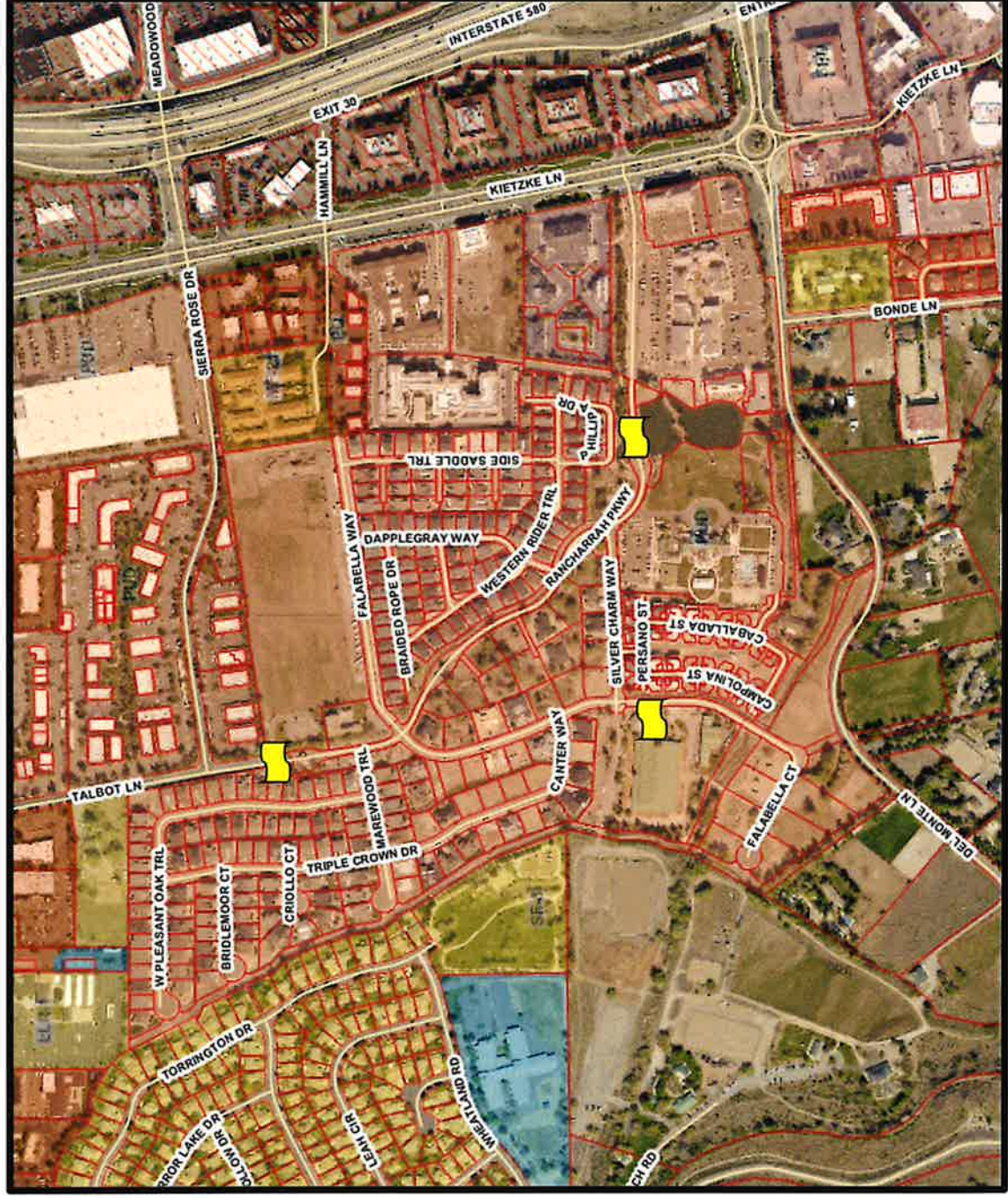

AFFIDAVIT OF MAILING

STATE OF NEVADA)

:ss.

COUNTY OF WASHOE)

Mikki Huntsman, being first duly sworn, deposes and says: That at all times hereinafter mentioned she was, and now is, the duly appointed City Clerk of the City of Reno, Washoe County, Nevada; that on the 25th day of April, 2025, she deposited in the United States Post Office at Reno, Nevada, copies of the attached postcard "Notice of Public Hearing" on which postage was fully prepaid, addressed to the property owners shown opposite their names, said noticing being marked "Exhibit A" and made a part hereof; that there is a regular communication by mail between the place of mailing and the place addressed; that said attached list contains the names and addresses of all owners of land in Case No. LDC25-00037 (Ranchosah PUD Handbook Amendment & MPA) who are required to be notified by law.

CITY CLERK

SUBSCRIBED and SWORN to before me this

25th day of APRIL, 2025.

Notary Public in and for the County of Washoe,
State of Nevada

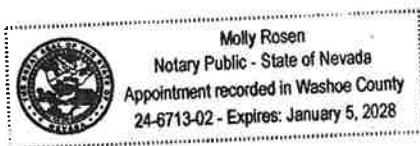



CITY OF RENO
City Clerk
PO Box 7
Reno, Nevada 89504
RETURN SERVICE REQUESTED

**IMPORTANT NOTICE ABOUT A
PROJECT NEAR YOUR PROPERTY**

Your Parcel: 040-081-62

Project Site Map



RENO CITY OF
C/O PROPERTY MANAGEMENT
PO BOX 1900
RENO, NV 89505



CITY OF RENO
City Clerk
PO Box 7
Reno, Nevada 89504
RETURN SERVICE REQUESTED

**IMPORTANT NOTICE ABOUT A
PROJECT NEAR YOUR PROPERTY**

Your Parcel: 040-081-50

Project Site Map



WASHOE COUNTY SCHOOL DISTRICT BOARD
ATTN BUSINESS/CFO
PO BOX 30425
RENO, NV 89520

NOTICE OF PUBLIC HEARING

Dear Property Owner:

YOU ARE HEREBY NOTIFIED that the Reno City Council will hold a public hearing on **May 7, 2025, at 10:00 a.m.** in the Council Chambers of City Hall, One East First Street, First Floor, Reno, Nevada, to consider testimony for **LDC25-00037 (Rancharrah Planned Unit Development Master Plan Amendment & Handbook Amendment)**

A request has been made for: 1) a Master Plan amendment from Parks, Greenways, and Open Space (PGOS) to Single-Family Neighborhood (SF); and, 2) an amendment to the Rancharrah Planned Unit Development (PUD) Handbook to: a) change a ±7.2 acre portion of the land use plan from Equestrian Center to Single-Family in order to create Village 8; b) reduce the total number of units from 722 to 469 units; c) modify the objectives of the PUD by removing all references to “equestrian” and “riding facilities”; and d) update the Flexibility section to reflect current RMC processes and other miscellaneous updates to reflect current RMC references. The ±6.0 acre Master Plan Amendment site is located west of the intersection of Falabella Way and Silver Charm Way, east of Bartley Ranch Regional Park. The ±140 acre PUD is generally located on the northwest corner of Kietzke Lane and Del Monte Lane. The PUD has Master Plan land use designations of PGOS, Single-Family Neighborhood (SF), Large-Lot Neighborhood (LL), and Suburban Mixed-Use (SMU).

As a property owner within **750 feet**, you are invited to present written or oral testimony relative to the above. If you have any questions, please call **Leah Piccotti, Associate Planner, at (775) 334-2178.**

Those who wish to submit public comment relative to the above, may do so by submitting public comment through the online public comment form found at Reno.Gov/PublicComment or by email to PublicComment@reno.gov. Comments received prior to 4:00 p.m. on the day preceding the meeting will be transcribed, provided to City Council for review, and entered into the record. Comments received after 4:00 pm on the day preceding the meeting will be provided to the City Council for review prior to adjournment and entered into the record.

MIKKI HUNTSMAN, CITY CLERK AND CLERK OF THE CITY COUNCIL OF THE CITY OF RENO

NOTICE OF PUBLIC HEARING

Dear Property Owner:

YOU ARE HEREBY NOTIFIED that the Reno City Council will hold a public hearing on **May 7, 2025, at 10:00 a.m.** in the Council Chambers of City Hall, One East First Street, First Floor, Reno, Nevada, to consider testimony for **LDC25-00037 (Rancharrah Planned Unit Development Master Plan Amendment & Handbook Amendment)**

A request has been made for: 1) a Master Plan amendment from Parks, Greenways, and Open Space (PGOS) to Single-Family Neighborhood (SF); and, 2) an amendment to the Rancharrah Planned Unit Development (PUD) Handbook to: a) change a ±7.2 acre portion of the land use plan from Equestrian Center to Single-Family in order to create Village 8; b) reduce the total number of units from 722 to 469 units; c) modify the objectives of the PUD by removing all references to “equestrian” and “riding facilities”; and d) update the Flexibility section to reflect current RMC processes and other miscellaneous updates to reflect current RMC references. The ±6.0 acre Master Plan Amendment site is located west of the intersection of Falabella Way and Silver Charm Way, east of Bartley Ranch Regional Park. The ±140 acre PUD is generally located on the northwest corner of Kietzke Lane and Del Monte Lane. The PUD has Master Plan land use designations of PGOS, Single-Family Neighborhood (SF), Large-Lot Neighborhood (LL), and Suburban Mixed-Use (SMU).

As a property owner within **750 feet**, you are invited to present written or oral testimony relative to the above. If you have any questions, please call **Leah Piccotti, Associate Planner, at (775) 334-2178.**

Those who wish to submit public comment relative to the above, may do so by submitting public comment through the online public comment form found at Reno.Gov/PublicComment or by email to PublicComment@reno.gov. Comments received prior to 4:00 p.m. on the day preceding the meeting will be transcribed, provided to City Council for review, and entered into the record. Comments received after 4:00 pm on the day preceding the meeting will be provided to the City Council for review prior to adjournment and entered into the record.

MIKKI HUNTSMAN, CITY CLERK AND CLERK OF THE CITY COUNCIL OF THE CITY OF RENO

LDC25-00037 Final List

APN	First Name	Last Name	Mailing 1	Mailing 2	City	State	Zip
040-081-50		WASHOE COUNTY SCHOOL DISTRICT BOARD	PO BOX 30425	ATTN BUSINESS/CFO	RENO	NV	89520
040-081-62		RENO CITY OF	PO BOX 1900	C/O PROPERTY MANAGEMENT	RENO	NV	89505
040-134-02		STATE OF NEVADA	515 E MUSSER ST STE 102	ATTN BUILDINGS & GROUNDS SECTION	CARSON CITY	NV	89701
040-134-03	STEPHEN D & LOUISE M	HALL LIVING TRUST et al	14457 BIG BASIN WAY		SARATOGA	CA	95070
040-135-01	PARVIZ & SHAHLA	BANAFSHE et al	3652 S VIRGINIA ST STE C7		RENO	NV	89502
040-135-06		555 HAMMILL LLC	1333 SECOND ST STE 650		SANTA MONICA	CA	90401
040-135-08		RJ & CS LLC	501 HAMMILL LN		RENO	NV	89511
040-135-09		O'GARA PARTNERS	18124 WEDGE PKWY # 1009		RENO	NV	89511-8
040-135-10	FRANK S & PATRICIA K	ULCH	2137 CIELO VISTA DR		SPARKS	NV	89441
040-135-12		MARANATHA WAY LLC	3283 MARANATHA RD	513 HAMMILL LN SERIES	WASHOE VALLEY	NV	89704
040-135-13		BAR W LLC	4150 LONGKNIFE RD		RENO	NV	89519
040-135-14		GM LLC	525 HAMMILL LN		RENO	NV	89511
040-135-15	JAMES W & EARLENE	FORSYTHE TRUST	2660 LAKERIDGE SHORES W		RENO	NV	89519
040-142-06		NEVDEX OFFICE PARK LLC	5310 KIETZKE LN STE 205		RENO	NV	89511
040-142-07		NEVDEX OFFICE PARK 5340 LLC	5310 KIETZKE LN STE 205		RENO	NV	89511-2
040-142-08		NEVDEX OFFICE PARK 5370 LLC	5310 KIETZKE LN STE 205		RENO	NV	89511
040-142-09		NEVDEX OFFICE PARK 5390 LLC	5310 KIETZKE LN STE 205		RENO	NV	89511
040-151-02	BRUCE & LANDESS	WITMER FAMILY TRUST	1605 DEL MONTE LN		RENO	NV	89511
040-151-03		PREMIER TRUST INC FBO BRUCE WITMER IRA	1605 DEL MONTE LN		RENO	NV	89511
040-151-04		WASHOE COUNTY	1605 DEL MONTE LN		RENO	NV	89512
040-152-05	MICHAEL & ANNE M	MCHARGUE	1250 DEL MONTE LN	ATTN PARKS & UTILITIES	RENO	NV	89511

LDC25-00037 (Ranchman PUD Handbook Amendment E, MPA)

APN	First Name	Last Name	Mailing 1	Mailing 2	City	State	Zip
040-152-06		DEMAREST II FAMILY TRUST	PO BOX 6177		INCLINE VILLAGE	NV	89450
040-152-07		TERAMO FAMILY TRUST	6460 BROOKVIEW CIR		RENO	NV	89519-7
040-152-09	KEAN K	CHIN et al	114 BRIDLEMOOR CT		RENO	NV	89511
040-152-10		MYER FAMILY TRUST	PO BOX 70247		RENO	NV	89570
	JOHN W & SUSAN A		1350 DEL MONTE LN		RENO	NV	89511
040-152-13		HARGROVE FAMILY TRUST					
040-152-17		OLIVER FAMILY TRUST	1550 DEL MONTE LN		RENO	NV	89511
040-152-22	C B	MADDOX FAMILY TRUST	PO BOX 70577		RENO	NV	89570
040-152-24		MILLER FAMILY TRUST	1580 DEL MONTE LN		RENO	NV	89511
040-152-26	BRIAN D & DAWN L	NORMAN	880 DEL MONTE LN		RENO	NV	89511
040-162-31		UNITARIAN UNIVERSALIST FELLOWSHIP NORTHERN NV	780 DEL MONTE LN		RENO	NV	89511
040-162-64		5411 KIETZKE LLC	5310 KIETZKE LN # 205		RENO	NV	89511
040-162-79		KIETZKE 5420 LLC	1475 TERMINAL WAY STE A	C/O NCS	RENO	NV	89502
	ANDREW M & MARY C	VESCO	943 LEAH CIR		RENO	NV	89511
040-181-01							
040-181-02		MGK PROPERTIES LLC SERIES I	480 GENOVESE LN		RENO	NV	89511
040-181-03	CAROL M	VOLLMER-JOHNSON	947 LEAH CIR		RENO	NV	89511
040-181-04	JAMES M	SOLAEGUI	949 LEAH CIR		RENO	NV	89511
040-181-05	STEPHEN & LAUREN	GIBBS	951 LEAH CIR		RENO	NV	89511
040-181-06	AINA K	TRODDEN	953 LEAH CIR		RENO	NV	89511
040-181-07		PERSON WALSH FAMILY 2019 TRUST	955 LEAH CIR		RENO	NV	89511
	STEVEN II & MARIE-THERESE	KISH	957 LEAH CIR		RENO	NV	89511
040-181-08							
040-181-12	ADAM M & ERIN E	SUMMERS	965 LEAH CIR		RENO	NV	89511
040-181-13	EDWIN R	PERALTA et al	967 LEAH CIR		RENO	NV	89511
040-181-14	ALLEN & HEATHER	TRYON 2008 LIVING TRUST	969 LEAH CIR		RENO	NV	89511
040-181-15	HELEN C	TEZAK TRUST	971 LEAH CIR		RENO	NV	89511
040-181-31	RICHARD & JUDITH	MAUS LIVING TRUST	961 LEAH CIR		RENO	NV	89511
040-181-32	LOIS L	HUMPHREY et al	963 LEAH CIR		RENO	NV	89511
040-181-33	ELIZABETH	SPENCER 2015 LIVING TRUST	2340 BLUE CANYON CT		RENO	NV	89523
040-181-34		CURATOLO-CHAUVEL TRUST	6123 TORRINGTON DR		RENO	NV	89511
040-181-35	PETER & JUSTINE	ANDERSON	6125 TORRINGTON DR		RENO	NV	89511

APN	First Name	Last Name	Mailing 1	Mailing 2	City	State	Zip
040-181-36	RENEE P	MILLER et al	6127 TORRINGTON DR		RENO	NV	89511
040-181-37	CHARLES T & ROBIN S	BRATLAND 2013 LIVING TRUST	6129 TORRINGTON DR		RENO	NV	89511
040-181-38		CLIFFORD FAMILY TRUST	6131 TORRINGTON DR		RENO	NV	89511
040-181-39		FOSNAUGH LIVING TRUST	6133 TORRINGTON DR		RENO	NV	89511
040-181-40	JEFFREY R	GRANT	6135 TORRINGTON DR		RENO	NV	89511
040-181-41	AMBER L	MOLINO et al	6137 TORRINGTON DR		RENO	NV	89511
040-181-42	JOSEPH A & COLLEEN R	SAIZ	6139 TORRINGTON DR		RENO	NV	89511
040-182-10	TERESA L W & STEPHEN C		6085 SUNRISE MEADOWS LOOP		RENO	NV	89519
040-182-11	BRUCE D & KATHY L	MAPLES RECTOR	968 LEAH CIR		RENO	NV	89511
040-182-12	NATALIE N	YANG	966 LEAH CIR		RENO	NV	89511
040-182-13	JILLIAN L	MOLETTIERE	1467 MANHATTAN BEACH BLVD # 5	ANHATTAN BEACH	CA	90266	
040-182-14	JOHN & VIRGINIA	JUETT	960 LEAH CIR		RENO	NV	89511
040-182-15	ANNETTE M	WILLIAMS LIVING TRUST	956 LEAH CIR		RENO	NV	89511
040-182-17	THEODORE	REVIGLIO SEPARATE PROP TRUST	4825 ROCK WREN CIR		RENO	NV	89509
040-182-18	ALLISON D	GEISE et al	948 LEAH CIR		RENO	NV	89511
040-182-19	VALERIE M	KILGORE	946 LEAH CIR		RENO	NV	89511
040-182-20	ERIC K	KRONAWETTER	944 LEAH CIR		RENO	NV	89511
040-182-21	MAUREEN L	MCKISSICK	945 WHEATLAND CT		RENO	NV	89511
040-182-22	RICHMOND	BREEN SEPARATE PROP TRUST	947 WHEATLAND CT		RENO	NV	89511
040-182-23		KLU PROPERTIES LLC	2595 SHARON WAY		RENO	NV	89509
040-182-24	DANIEL	STEWART	953 WHEATLAND CT		RENO	NV	89511
040-182-25	JAMES	RALEIGH	959 WHEATLAND CT		RENO	NV	89511
040-182-26	JOSEPH G	ALFERS et al	961 WHEATLAND CT		RENO	NV	89511
040-182-27	CHRIS R	BURKE	969 WHEATLAND CT		RENO	NV	89511
040-182-34		TOMKAT PROPERTIES LLC SERIES 1	12635 SILVER WOLF RD		RENO	NV	89511
040-183-01		OTT FAMILY TRUST	6142 TORRINGTON DR		RENO	NV	89511
040-183-02	DIANE L	MACDONALD-COULSON et al	3170 COVENT GARDEN DR		RENO	NV	89509
040-183-03	NOLAN & ALEXA	YOUNG	6136 TORRINGTON DR		RENO	NV	89511

APN	First Name	Last Name	Mailing 1	Mailing 2	City	State	Zip
040-183-04		LHN COUGAR LLC	1410 GREG ST STE 403	C/O LEWIS MANAGEMENT CORP		NV	89431
040-183-05	THOMAS E	ORR	6132 TORRINGTON DR	SPARKS		NV	89511
040-183-06	SARAH & STEVEN M	HOWARD	6130 TORRINGTON DR	RENO	NV	89511	
040-183-07	JAMES C	GIUDICI	6128 TORRINGTON DR	RENO	NV	89511	
040-183-08	NANCY L	TOY	6126 TORRINGTON DR	RENO	NV	89511	
040-183-09	KEITH D	HANSON	6124 TORRINGTON DR	RENO	NV	89511	
040-421-06	JANET B	LAZARUS	986 RIDGEVIEW DR	RENO	NV	89511	
040-421-07	KRISTINA E	MCCABE	984 RIDGEVIEW DR	RENO	NV	89511	
040-421-08		RAGSDALE FAMILY TRUST	1015 COUNTRY ESTATES CIR	RENO	NV	89511	
040-421-09	THOMAS E & MARINA M	YOUNG	980 RIDGEVIEW DR	RENO	NV	89511	
040-421-10	NICHOLAS C	BELANGER	978 RIDGEVIEW DR	RENO	NV	89511	
040-421-11	JIA	JINGXIAN	1106 IVY CT	RENO	NV	89511	
040-421-14	WILLIAM E & MICHELLE L	MCANDREWS FAMILY TRUST	974 RIDGEVIEW DR	RENO	NV	89511	
040-421-15	DAVID & PRISCILLA	DOUCET LIVING TRUST	972 RIDGEVIEW DR	RENO	NV	89511	
040-421-18	HALEY	CLARK et al	968 RIDGEVIEW DR	RENO	NV	89511	
040-421-19	MICHELLE	RICHARDS LIVING TRUST	964 RIDGEVIEW DR	RENO	NV	89511	
040-421-20	ANTHONY T	ZIMMERMAN	960 RIDGEVIEW DR	RENO	NV	89511	
040-422-01	SHAWN	STODDARD et al	971 RIDGEVIEW DR	RENO	NV	89511	
040-422-02		MORT LIVING TRUST	973 MIRROR LAKE DR	RENO	NV	89511	
040-422-03		GILMAN FAMILY TRUST	974 MIRROR LAKE DR	RENO	NV	89511	
040-422-04	CORA	ROBEY LIVING TRUST	977 MIRROR LAKE DR	RENO	NV	89511	
040-422-05	CHARLES	GRUBER et al	979 MIRROR LAKE DR	RENO	NV	89511	
040-422-06		JJG PROPERTIES LLC	4873 RAMCREEK TRL	RENO	NV	89519	
040-422-07		DERBY LIVING TRUST	983 MIRROR LAKE DR	RENO	NV	89511	
040-422-08	JOSEPH & CAROLYN	DOYCICH LIVING TRUST	985 MIRROR LAKE DR	RENO	NV	89511	
040-422-09	JAMES E & KAREN S	BENNETT FAMILY TRUST	987 MIRROR LAKE DR	RENO	NV	89511	
040-422-10	BARBARA K	SPRING	989 MIRROR LAKE DR	RENO	NV	89511	
040-422-11	MARK A	ROBERTSON et al	991 MIRROR LAKE DR	RENO	NV	89511	
040-422-12	PAUL S	CURTIS SEPARATE PROPERTY TRUST	2191 SANTA YNEZ AVE	SAN LUIS OBISPO	CA	93405	

APN	First Name	Last Name	Mailing 1	Mailing 2	City	State	Zip
040-422-13	DONALD E & PATRICIA A	WEIR et al	PO BOX 10840		RENO	NV	89510
040-422-14	JUSTIN	SMITH	6066 STONECREEK DR		RENO	NV	89511
040-423-01	DARIO O	DELGADO	996 MIRROR LAKE CT		RENO	NV	89511
040-423-02		JUSSEN LIVING TRUST	2197 TIVOLI LN		SPARKS	NV	89434
040-423-03		MILLER LIVING TRUST	992 MIRROR LAKE CT		RENO	NV	89511
040-423-04		BRENDLE-BROWN FAMILY TRUST			RENO	NV	89511
040-423-05		WONG 1999 FAMILY TRUST	990 MIRROR LAKE CT				
			988 MIRROR LAKE CT		RENO	NV	89511
040-423-06	KATHRYN M & KENDALL	MARSH	981 QUAIL HOLLOW DR		RENO	NV	89511
040-423-07	THOMAS III & CATHERINE	DUTTON	983 QUAIL HOLLOW DR		RENO	NV	89511
040-423-08	CYNTHIA A	ZAKREVSKY TRUST	985 QUAIL HOLLOW DR		RENO	NV	89511
040-423-09	D JOSEPH & LOUISE M	DOUCET 1989 TRUST	6124 GREENBROOK DR		RENO	NV	89511
040-423-10	GORDON Y C	CHING TRUST et al	7 LAIMI RD		HONOLULU	HI	96817
	JOHN C & SHAWN B	ERICKSON	6070 STONECREEK DR		RENO	NV	89511
040-423-17		KIRKHAM FAMILY TRUST	6600 TWIN CITIES RD		ELK GROVE	CA	95757
040-424-15		BUDHECHA FAMILY TRUST	988 QUAIL HOLLOW DR		RENO	NV	89511
040-424-16	JOSEPH M JR	STUART et al	986 QUAIL HOLLOW DR		RENO	NV	89511
040-424-17	DAVID A & DEBBIE M	YOUNGBERG	984 QUAIL HOLLOW DR		RENO	NV	89511
040-424-18	JACQUELINE L G	MCINTIRE	982 QUAIL HOLLOW DR		RENO	NV	89511
040-424-19	JESSICA E	THOMPSON	976 MIRROR LAKE DR		RENO	NV	89511
040-424-20	DAVID	RAMIREZ et al	970 MIRROR LAKE DR		RENO	NV	89511
040-424-22		D&G LIVING TRUST	979 RIDGEVIEW DR		RENO	NV	89511
040-424-23	JEREMY & HARMONY	STEINGREBE	981 RIDGEVIEW DR		RENO	NV	89511
040-424-24	MATTHEW A	JEANOS et al	983 RIDGEVIEW DR		RENO	NV	89511
040-424-25	ME THI	JAMES 2010 TRUST	8000 MEADOW VISTA DR		RENO	NV	89511
040-424-26	SHITA G	YENENH	987 RIDGEVIEW DR		RENO	NV	89511
040-424-27	A MICHAEL & DOMINIQUE B	KINSLEY	6120 TORRINGTON DR		RENO	NV	89511
040-432-03	FRANK K	BUST YOUR BUTTS TRUST	6090 TORRINGTON DR		RENO	NV	89511
040-433-02		HARNAGEL LIVING TRUST	PO BOX 71268		RENO	NV	89570

APN	First Name	Last Name	Mailing 1	Mailing 2	City	State	Zip
040-433-04		HUFFMAN LIVING TRUST	6086 TORRINGTON DR		RENO	NV	89511
040-433-05	DAVID	MOORE	6084 TORRINGTON DR		RENO	NV	89511
040-433-06	TT	ESPERANZA LIVING TRUST	6082 TORRINGTON DR		RENO	NV	89511
040-433-07		DEPUTY LIVING TRUST	6080 TORRINGTON DR		RENO	NV	89511
	DAWSON & AUDREY	HECK TRUST	6078 TORRINGTON DR		RENO	NV	89511
040-433-08	MICHAEL J & EDYTHE L	MELVIN	6076 TORRINGTON DR		RENO	NV	89511
040-433-09	ROBERT D & GIGI H	CHISEL	6074 TORRINGTON DR		RENO	NV	89511
040-433-10	MERI K	WEST TRUST	6072 TORRINGTON DR		RENO	NV	89511
040-433-11	GAYLENE & TIMOTHY E	BALL	6070 TORRINGTON DR		RENO	NV	89511
040-433-12		ASR 2024 TRUST	3301 S VIRGINIA ST		RENO	NV	89502
040-433-13		RAITS FAMILY TRUST	6066 TORRINGTON DR		RENO	NV	89511
040-433-14	KATHRYN G	BAKER	6064 TORRINGTON DR		RENO	NV	89511
040-433-15	CHAD & SHANNON K	HARTLEY	6062 TORRINGTON DR		RENO	NV	89511
040-433-16	REBEKAH	MENES	6060 TORRINGTON DR		RENO	NV	89511
040-433-17		ZUCCO FAMILY 2021 TRUST	6058 TORRINGTON DR		RENO	NV	89511
040-433-18	JOEL D & SARAH A	BATES	6056 TORRINGTON DR		RENO	NV	89511
040-433-19	SYDNEY S	CALDERON	6096 TORRINGTON DR		RENO	NV	89511
040-434-01	DON	HILTON	6062 STONECREEK DR		RENO	NV	89511
040-434-02	CARYN L	RUBIN TRUST	6060 STONECREEK DR		RENO	NV	89511
040-434-03		CISAR FAMILY TRUST	6057 TORRINGTON DR		RENO	NV	89511
	PETER A & DEBRA L A	SAVAGE et al	6059 TORRINGTON DR		RENO	NV	89511
040-434-04		GARDNER FAMILY TRUST	6061 TORRINGTON DR		RENO	NV	89511
040-434-05		MALMED II LLC	2209 WHITE SANDS DR		RENO	NV	89511
040-434-06					SOUTH LAKE TAHOE	CA	96150
040-434-07		JUNELL LIVING TRUST	6067 TORRINGTON DR		RENO	NV	89511
040-434-08	JOSEPH R	LAWRENCE et al	6069 TORRINGTON DR		RENO	NV	89511
040-434-09	CINDY L & EDWARD M	THOMAS	6071 TORRINGTON DR		RENO	NV	89511
040-434-10	MINH D	NGUYEN	221 EL DORADO DR		PACIFICA	CA	94044
040-434-11	OLIVIA M	SWANER TRUST	6075 TORRINGTON DR		RENO	NV	89511

APN	First Name	Last Name	Mailing 1	Mailing 2	City	State	Zip
040-434-12	MARK S	NOVACEK et al	6079 TORRINGTON DR		RENO	NV	89511
040-434-13	JOSEPH R & CLAUDIA S	ROBERTS	6081 TORRINGTON DR		RENO	NV	89511
040-434-14	MARTIN L JR	MURRAY	6083 TORRINGTON DR		RENO	NV	89511
040-434-15		STUMPF FAMILY TRUST	6085 TORRINGTON DR		RENO	NV	89511
040-434-16		LYONS FAMILY TRUST	6087 TORRINGTON DR		RENO	NV	89511
040-434-17	NIGEL F & EMILY C	TEEKASINGH	6089 TORRINGTON DR		RENO	NV	89511
040-434-18	ROBERT A & WHITNEY K	MAIDENS	963 RIDGEVIEW DR		RENO	NV	89511
040-434-19	TYRONE J	COFFEY	969 RIDGEVIEW DR		RENO	NV	89511
040-880-01		6630-C MCCARRAN LLC	6590 S MCCARRAN BLVD STE A	C/O AVISON YOUNG	RENO	NV	89509
040-880-02		6630-B MCCARRAN LLC	6590 S MCCARRAN BLVD STE A	C/O AVISON YOUNG	RENO	NV	89509
040-880-05		LUZON INVESTORS LLC	6590 S MCCARRAN BLVD STE A	C/O AVISON YOUNG	RENO	NV	89509
040-880-06		SINDLINGER CAPITAL LLC	8975 DOUBLE DIAMOND PKWY STE A13		RENO	NV	89521
040-880-07		JEFFREY'S PROPERTIES	6850 S MCCARRAN BLVD STE 1		RENO	NV	89509
040-880-08		TS MANAGEMENT GROUP INC	6800 S MCCARRAN BLVD		RENO	NV	89509
040-880-13		6630-A MCCARRAN LLC	6590 S MCCARRAN BLVD STE A	C/O AVISON YOUNG	RENO	NV	89509
040-880-14	LEO W	KNUF FAMILY TRUST	1047 MANOR DR		RENO	NV	89509
040-880-15		MOJO PROPERTIES LLC	6800 S MCCARRAN BLVD		RENO	NV	89509
040-880-16		SOUTH RENO BAPTIST CHURCH TRUST	6780 S MCCARRAN BLVD		RENO	NV	89509
040-880-20		CN REALTY GROUP LLC	6770 S MCCARRAN BLVD		RENO	NV	89509
040-880-21		MOJO PROPERTIES LLC SERIES D	6800 S MCCARRAN BLVD		RENO	NV	89509
040-880-22		MOJO PROPERTIES LLC	6790 CHESTERFIELD		RENO	NV	89523
040-880-24		RENO LAKERIDGE LLC	940 EMMETT AVE STE 200	C/O VILLAGE PROPERTIES	BELMONT	CA	94002
040-880-25					RENO	NV	89509
040-890-04		QUAIL COURT BUSINESS PARK 6490 S MCCARRAN BLVD BLDG E MAINTENANCE ASSO			RENO	NV	89511
040-900-23		ROSSER FAMILY TRUST	1175 DEL MONTE LN		NEWPORT BEACH	CA	92660
040-900-24		SHP VI RANCHARRAH JV LLC	5000 BIRCH ST STE 400		RENO	NV	89509
040-900-25		DRAGON I LLC	1000 DARTMOUTH DR		COTTSDAL	AZ	85251
040-900-24		RANCHARRAH SR DEVELOPMENT LLC	6710 E CAMELBACK RD STE 100				

APN	First Name	Last Name	Mailing 1	Mailing 2	City	State	Zip
040-910-01	LAIF E & CARA	MEIDELL TRUST	570 HAMMILL LN		RENO	NV	89511
040-910-02		KIENER FAMILY 2005 TRUST	530 HAMMILL LN		RENO	NV	89511
040-910-03		TRONDHEIM MANAGEMENT II LLC	570 HAMILL LN		RENO	NV	89511
040-910-04		QUAIL VILLAGE II MAINT ASSOC	570 HAMMILL LN	C/O CARA MEIDELL	RENO	NV	89511
040-910-05		TRONDHEIM MANAGEMENT LLC	570 HAMMILL LN		RENO	NV	89511
040-910-06		MEIDELL FAMILY TRUST	14220 POWDER RIVER CT		RENO	NV	89511
040-910-07		STANDERFER & GRIFFIN LLC	590 HAMMILL LN		RENO	NV	89511
040-910-08		QUAIL VILLAGE II MAINT ASSOC	5285 COGNAC CT	C/O ROBERT L DELETT	RENO	NV	89511
040-920-01			6490 S MCCARRAN BLVD BLDG E		RENO	NV	89509
040-920-02		QUAIL CORNERS I LLC	13300 ARROWSPRINGS DR	C/O RIBEIRO CORP	RENO	NV	89511
040-920-06		WFP1 LLC	2420 MOUNTAIN SPIRIT TRL		RENO	NV	89523
040-920-07	STEPHEN C	MOLLATH FAMILY TRUST	6560 S MCCARRAN BLVD STE A		RENO	NV	89509-6
040-920-08		MOLLATH TRUST	6490 S MCCARRAN BLVD BLDG E	C/O RIBEIRO COMPANY	RENO	NV	89509
040-920-10		LANE HEALTHCARE LLC	8095 MEADOW VISTA DR		RENO	NV	89511
040-920-11		GAROL FAMILY TRUST	2435 TRAILS END LN		RENO	NV	89511
040-920-12		POLESELLI 2000 FAMILY TRUST	6566 S MCCARRAN BLVD STE A		RENO	NV	89509
040-920-14		RJ LLC	PO BOX 5247		RENO	NV	89513
040-920-18		ALEXIS RAE LLC			RENO	NV	89511
040-920-19		SANDHILL INVESTMENT PROPERTIES LLC	925 MAPLE CREEK CT		RENO	NV	89511
040-920-20	MICHAEL & PAM	DOBROWSKI JOINT TRUST	PO BOX 17975		LAS VEGAS	NV	89144
040-920-22		NEVADA STATE DEVELOPMENT CORP	1551 DESERT CROSSING CT				
			600 S LAS VEGAS BLVD STE 400	C/O THORNDAL ARMSTRONG DELK	LAS VEGAS	NV	89101
040-920-23		QUAIL CORNERS ONE					
		RENOWN HEALTH INC	1155 MILL ST MS Z5	ATTN ACCOUNTS PAYABLE	RENO	NV	89502
040-920-24	JOSEPH F & CHARLENE		6580 S MCCARRAN BLVD STE D1	C/O SIERRA PODIATRY ASSOC	RENO	NV	89509-6
		KNEDEGEN					
040-920-26		HUTNUT LLC	1441 PULLMAN DR		SPARKS	NV	89434
040-920-28		QUAIL CORNERS MAINTENANCE ASSN	6490 S MCCARRAN BLVD BLDG E		RENO	NV	89509

APN	First Name	Last Name	Mailing 1	Mailing 2	City	State	Zip
040-920-29		SALTERN INVESTMENTS	6542 S MCCARRAN BLVD STE A		RENO	NV	89509
040-920-30		6542 PAIVA LLC	6542 S MCCARRAN BLVD STE B	C/O DANIEL P GRUBIC	RENO	NV	89509
040-920-31		GYSEN FAMILY TRUST	1400 STONEGATE CT		RDNERVIL	NV	89410
040-920-32		BOLTON FAMILY TRUST	PO BOX 4199		INCLINE VILLAGE	NV	89450
040-920-33		TAMARISK INVESTMENTS LLC	6580 S MCCARRAN BLVD STE B	C/O MELISSA AMARAL	RENO	NV	89509
040-920-34		JVG PROPERTIES LLC	2745 SPINNAKER DR		RENO	NV	89519
040-941-01		ACTERRA LLC	PO BOX 6539		RDNERVIL	NV	89460
040-941-03		EDWARDS & VON RAVENSBURG PROF LLC	695 SIERRA ROSE DR		RENO	NV	89511
040-941-04		CNM QUAIL INC	1475 TERMINAL WAY STE A	C/O NEVADA COMMERCIAL SERVICES	RENO	NV	89502
040-941-05		689 SIERRA ROSE LLC	6490 S MCCARRAN BLVD BLDG E		RENO	NV	89509
040-941-07	AUDREY	GRIVA FAMILY TRUST	5600 HACIENDA RANCH RD	C/O FRANCES LANE	PALMDALE	CA	93551
040-941-08		LEE HANCOCK CONSTRUCTION INC	610 DISCOVERY BAY BLVD		DISCOVERY BAY	CA	94505
040-941-11		PENN-HAWK PROPERTIES LLC	681 SIERRA ROSE DR		RENO	NV	89511
040-941-12		CITY CREEK RENO LLC	PO BOX 750		RENO	NV	89504
040-941-13		LIAL ENTERPRISE LLC	4265 ROSS DR	C/O ALAIN KOVALTCHOUK	RENO	NV	89519
040-941-15		SOILS ORGANIC SOLUTION INC	5750 LONE HORSE DR		RENO	NV	89502
040-941-17		QUAIL CORNERS SOUTH LLC	6490 S MCCARRAN BLVD BLDG E	ATTN ATHA KERR	RENO	NV	89509
040-941-21		JOE DOG DOG FOOD LLC	635 SIERRA ROSE DR STE A		RENO	NV	89511
040-941-23	TOMAS G	DEBRUIN et al	631 SIERRA ROSE DR STE A		RENO	NV	89511
040-941-25		BUS FAMILY TRUST	4285 MEADOWGATE TRL		RENO	NV	89519
040-941-28		RCI PROPERTIES LLC	590 EUREKA AVE	C/O RENO DIAGNOSTIC CENTERS- ACCT PAYABLE	RENO	NV	89512
040-941-36		601 SIERRA ROSE LLC	2445 FARETTO LN		RENO	NV	89511
040-941-38		EISSMANN FAMILY TRUST	13400 FIELDCREEK LN		RENO	NV	89511
040-941-39		BP PROPERTY LTD	605 SIERRA ROSE DR # 4		RENO	NV	89511
040-941-41		QUAIL CORNERS SOUTH MAINTENANCE ASSOC	6490 S MCCARRAN BLVD BLDG E		RENO	NV	89509
040-942-01		YI RANCHES LP	PO BOX 707		REEDLEY	CA	93654
040-942-06		CONKEY & WILSON LTD	620 SIERRA ROSE DR		RENO	NV	89511

APN	First Name	Last Name	Mailing 1	Mailing 2	City	State	Zip
040-942-21		PROVASI 1986 LIVING FAMILY TRUST	3325 PRESCOTT WAY		RENO	NV	89509
040-942-24		SHJ HOLDING COMPANY LLC	22 STATE ROUTE 208		ERINGTON	NV	89447
040-942-25		TEAM RAMAN LLC	3865 ASPEN HALLOW		RENO	NV	89511
040-942-28		660 SIERRA ROSE LLC	6490 S MCCARRAN BLVD BLDG E		RENO	NV	89509-6
040-942-29		QUAIL CORNERS SOUTH-PHASE 3 MAINT ASSN	6490 S MCCARRAN BLVD BLDG E		RENO	NV	89509
040-942-31		NEVADA CENTER FOR DERMATOLOGY LLC	650 SIERRA ROSE DR STE A		RENO	NV	89511
040-942-32		NEVADA CENTRE LLC	4827 ELKCREEK TRL		RENO	NV	89519
040-942-33		QUAIL CORNERS SOUTH-PHASE 3 MAINTENANCE ASSN OWNERS OF PM 4454 & 4804	6490 S MCCARRAN BLVD BLDG 4 COMMON AREA		RENO	NV	89502
040-943-00					NONE	NV	00000
040-943-02	RUPAL V	SHAH et al	4130 RIDGE DR		LOOMIS	CA	95650
040-943-03		QUAIL CORNERS SOUTH BLDG 6490 S MCCARRAN BLVD BLDG N LLC E			RENO	NV	89509
040-943-04		SIERRA WEIGHT LOSS SOLUTIONS LLC	10585 CLAIM JUMPER LN		RENO	NV	89521
040-943-05		ROSE OF THE SIERRA LLC	12745 SILVER WOLF RD		RENO	NV	89511
040-944-02	JACK S & JOANNA T	ROSS FAMILY TRUST	10329 S PENASQUITOS CT		SPARKS	NV	89441
040-944-03		CHILKUR LLC	PO BOX 9		CARSON CITY	NV	89702
040-944-04		MEADOW CREEK MANAGEMENT LLC	645 SIERRA ROSE DR STE 205		RENO	NV	89511
040-951-05		6490 MCCARRAN D1 & D2 LLC	6490 S MCCARRAN BLVD BLDG E		RENO	NV	89509
040-951-06		MCCARRAN QUAIL PARK BLDG 6490 S MCCARRAN BLVD BLDG A B & C LLC E			RENO	NV	89509
040-951-08		RS EAGLE FEDERAL WAY LLC et al	1000 LOWE'S BLVD	C/O LOWE'S COMPANIES INC MAIL CODE ZETA	OORESVILL	NC	28117
040-952-11		MIDDLEMAS-MEADOWOOD LLC et al	142 S SANTA CRUZ AVE STE A	C/O PREFERRED COMMUNITY MGT INC/GIBSON	LOS GATOS	CA	95030-6
040-961-01		FIRST INDEPENDENT BANK OF NEVADA	PO BOX 11100		RENO	NV	89510

APN	First Name	Last Name	Mailing 1	Mailing 2	City	State	Zip
040-961-02		RENO C P LLC	5345 KIETZKE LN STE 100	C/O ALLIANCE	RENO	NV	89511
040-961-03		SUNSHINE INDUSTRIAL LLC	5371 KIETZKE LN		RENO	NV	89511
040-961-05		FABER STREET PROPERTIES LLC	1565 TACOMA	C/O FRANK C PARCELL	REDWOOD CITY	CA	94063
040-971-05		MV II LLC	5421 KIETZKE LN STE 200		RENO	NV	89511
040-971-06		AL-MOR PLATINUM LLC	3150 ALMADEN EXPY STE 103		SAN JOSE	CA	95118
040-972-07					LAS VEGAS	NV	89146-6
040-972-12		MOUNTAINVIEW CORP CTR OWN ASSC	3311 S RAINBOW BLVD STE 225				
226-051-01		RENO HOSPITALITY LLC	PO BOX 847		CARLSBAD	CA	92018
226-051-04		BONDE FARMS HOA	1675 ROBB DR # 5		RENO	NV	89523
226-051-05		HSU FAMILY TRUST	6412 BONDE FARMS LN		RENO	NV	89511
226-051-12		ENDRES FAMILY TRUST	6418 BONDE FARMS LN		RENO	NV	89511
226-051-15	ANDREA	NOLAN	6409 BONDE FARMS LN		RENO	NV	89511
226-051-16		FISHER FAMILY TRUST	6400 BONDE FARMS LN		RENO	NV	89511
226-061-06	TRYGVE	LOKEN FAMILY TRUST	6406 BONDE FARMS LN		RENO	NV	89511
226-061-16		RANCHARRAH COMMUNITY ASSOCIATION	6001 TALBOT LN		RENO	NV	89509
226-061-21		RANCHARRAH HOLDINGS LLC	6001 TALBOT LN		RENO	NV	89509
226-061-22	HAKELA L	FELTON 1997 IRREVOCABLE TRUST	3470 GS RICHARDS BLVD		CARSON CITY	NV	89703
226-071-02	JUDITH A	CLUB AT RANCHARRAH LLC	6100 RANCHARRAH PKWY		RENO	NV	89511
226-071-03		BUCKINGHAM TRUST	6124 S PLEASANT OAK TRL		RENO	NV	89511
226-071-04		WULF DAUGHERTY TRUST	6122 S PLEASANT OAK TRL		RENO	NV	89511
226-071-05	DONALD G	PARSONS	6120 S PLEASANT OAK TRL		RENO	NV	89511
226-071-06		RESNIK FAMILY TRUST	6118 S PLEASANT OAK TRL		RENO	NV	89511
226-071-07	GEORGE K	BABA et al	6116 S PLEASANT OAK TRL		RENO	NV	89511
226-071-08		HADDAD FAMILY TRUST	6114 S PLEASANT OAK TRL		RENO	NV	89511
226-071-09	PRESTON & PAMELA	THISTLE LIVING TRUST	6112 S PLEASANT OAK TRL		RENO	NV	89511
226-071-10	MARSHALL E & ANGIE	TOLBERT	6110 S PLEASANT OAK TRL		RENO	NV	89509
226-071-11	CONNIE M	BAUTER FAMILY TRUST	6108 S PLEASANT OAK TRL		RENO	NV	89511
226-071-12	THOMAS W & BARBARA B	KLING TRUST	6106 S PLEASANT OAK TRL		RENO	NV	89511
		SMITH TRUST	6104 S PLEASANT OAK TRL		RENO	NV	89511

APN	First Name	Last Name	Mailing 1	Mailing 2	City	State	Zip
226-071-13	DOUGLAS M & CATHERINE E	PAYNE	31 SOUTHAMPTON CT		NEWPORT BEACH	CA	92660-4
226-071-14		REED FAMILY TRUST	6100 S PLEASANT OAK TRL		RENO	NV	89511
226-071-16	ALVIR	NAVIN et al	774 MAYS BLVD # 10-680		INCLINE VILLAGE	NV	89451
226-071-17	HENRY A & ARDIS J	MOHRSCHLADT	6501 E EL MARO CIR		PARADISE VALLEY	AZ	85253
226-071-18		SIERRA INVESTMENTS I LLC	2710 ALASTOR WAY		RENO	NV	89521
226-071-19		VIJAI SINHA & TAI-PENG LEE LIVING TRUST	401 ROSEMONT DR		SANTA CLARA	CA	95051
226-071-20	KEVIN P	MORGAN TRUST	709 W PLEASANT OAK TRL		RENO	NV	89511
226-071-21	GIOVANNI	COGLITORE et al	9601 LANE GARRETT DR		RENO	NV	89511
226-071-22	ANTHONY & TAKESHA	COOPER	713 W PLEASANT OAK TRL		RENO	NV	89511
226-071-23	DAVE & HOPE	JENSEN 1997 TRUST	715 W PLEASANT OAK TRL		RENO	NV	89511
226-071-24	JEFFREY F	SPRINGMAN et al	717 W PLEASANT OAK TRL		RENO	NV	89511
226-071-25	BRITNI & KEVIN	JOHNSON	5925 LAKE GENEVA CT		RENO	NV	89511
226-071-26	MARK & CATHERINE	MAYNARD	721 W PLEASANT OAK TRL		RENO	NV	89511
226-071-27	EDWIN JAN-JIN & JENNIFER CHANG	HSU	723 W PLEASANT OAK TRL		RENO	NV	89511
226-071-28		ROBERTS FAMILY EXEMPTION TRUST	725 W PLEASANT OAK TRL		RENO	NV	89511
226-071-29	BRADLEY	LONE WOLVES FAMILY 2020 TRUST	727 W PLEASANT OAK TRL		RENO	NV	89511
226-072-01		ONELOA LLC SERIES IV	65 BEAR MOUNTAIN PL		RENO	NV	89519
226-072-02		CHRISTENSEN FAMILY TRUST	722 W PLEASANT OAK TRL		RENO	NV	89511
226-072-03	JONATHAN & TRICIA	CHINN TRUST	9681 GISLER DR		UNTINGTO BEACH	CA	92646
226-072-04	ROBERT W & LINDSAY R	PETRICCA	76121 VIA SATURNIA		INDIAN WELLS	CA	92210-7
226-072-05		GOVIND FAMILY TRUST	716 W PLEASANT OAK TRL		RENO	NV	89511
226-072-06	JAMES S & BRENDA L	GIBSON	5096 BORDEAUX CT		RENO	NV	89511
226-072-07	CAROLYN S	KELLY TRUST	PO BOX 6294		INCLINE VILLAGE	NV	89450
226-072-08	RYAN D	MILKEN	105 BRIDLEMOOR CT		RENO	NV	89511
226-072-09	THOMAS S	DEREGT TRUST	107 BRIDLEMOOR CT		RENO	NV	89511
226-072-10		YOSHIMURA LIVING TRUST	109 BRIDLEMOOR CT		RENO	NV	89511

APN	First Name	Last Name	Mailing 1	Mailing 2	City	State	Zip
226-072-11		JOHNSTON FAMILY TRUST	111 BRIDLEMOOR CT		RENO	NV	89511
	RICHARD & LOU ANN	CARLSTROM	11 MOMROW TERR		MENANDS	NV	12204
226-072-12					RENO	NV	89511
226-072-13	PETA & JAMES	ROSS FAMILY TRUST	115 BRIDLEMOOR CT		RENO	NV	89511
226-072-14	BEJAL & JUSMIN	PATEL	117 BRIDLEMOOR CT		RENO	NV	89511
226-073-01	YU J	MIAO et al	114 BRIDLEMOOR CT		RENO	NV	89511
226-073-02		WELLS TRUST	110 BRIDLEMOOR CT		RENO	NV	89511
226-073-03	PATRICK K F	LAM et al	16500 SANBORN RD		SARATOGA	CA	95070
226-073-04	LILLIAN	WONG	106 BRIDLEMOOR CT		RENO	NV	89511
			2614 MATRINO CIR		ENDERSON	NV	89052
226-073-05	KENNETH R & CELESE M	BELL 2009 TRUST			RENO	NV	89511
226-073-06	THOMAS M	DOBRY LIVING TRUST et al	205 CRIOLLO CT		RENO	NV	89511
226-073-07		PETERSEN TRUST	207 CRIOLLO CT		RENO	NV	89511
226-073-08	ANDREW B	GADDIS	16735 ROUGE CT		RENO	NV	89511
226-073-09		MACDONALD FAMILY 1998 TRUST	213 CRIOLLO CT		RENO	NV	89511
226-073-10	DANIEL & ALEXIA	PORTILLO 2016 TRUST	210 CRIOLLO CT		RENO	NV	89511
226-073-11		DWC TRUST	208 CRIOLLO CT		RENO	NV	89511
226-073-12	CHRIS & KRISTINA	CARDEN	206 CRIOLLO CT		RENO	NV	89511
226-073-13	JOHN & KATHRYN	MADDALON FAMILY TRUST	200 CRIOLLO CT		RENO	NV	89511
226-073-14		DBB HOLDINGS INC	PO BOX 18087		RENO	NV	89511
226-073-15		SHACKNV LLC	3653 SPIRIT BLIFF CT		RENO	NV	89511
226-073-16		MALIBU55 INC	309 MAREWOOD CT		RENO	NV	89511
226-074-01		STOLLMAYER FAMILY TRUST	9106 WILD SKIES WAY		RENO	NV	89523-9
			725 MAREWOOD TRL		RENO	NV	89511
226-074-02	WALTER C & STEPHANIE J	RUNDIN 2018 LIVING TRUST	6122 TRIPLE CROWN DR		RENO	NV	89511
226-074-03	COLIN J	BURNS	13042 FLINT DR		SANTA ANA	CA	92705
226-074-04		DLKC INVESTMENTS LLC			RENO	NV	89511
226-074-05	SHANE	GRAHN	6118 TRIPLE CROWN DR		SAFETY HARBOR	FL	34695
226-074-06	JACK & KERRY	MOORE	506 CREEKSIDE CT		RENO	NV	89511
226-074-07	LORI J & FREDERICK H	SAVIDGE	6114 TRIPLE CROWN DR		RENO	NV	89511
226-074-08		WHITTAKER FAMILY TRUST	6112 TRIPLE CROWN DR		RENO	NV	89511
226-074-09	ERIC W	SNYDER	6110 TRIPLE CROWN DR		RENO	NV	89511
226-074-10		RCH TRIPLE C LLC	2928 FOREST AVE		BERKELEY	CA	94705

APN	First Name	Last Name	Mailing 1	Mailing 2	City	State	Zip
226-074-11		SVITENKO FAMILY TRUST	6106 TRIPLE CROWN DR		RENO	NV	89511
226-074-12	LINDSAY	GAMBIT	54 EVVIE CT		ENDERSON	NV	89012
226-074-13		MRPS HOLDINGS II LLC	1250 4TH ST FL 5		SANTA MONICA	CA	90401
226-074-14		LATIGO MT LLC	9101 ALTA DR STE 107		LAS VEGAS	NV	89145
226-074-15		RAS FAMILY TRUST	5513 WESTERN RIDER TRL		RENO	NV	89511
226-074-16	MANI	SALAMAT et al	17197 STILLWOOD LN		FAIRHOPE	AL	36532
226-074-17		OLECHOWSKI FAMILY TRUST	6107 S PLEASANT OAK TRL		RENO	NV	89511
226-074-18	CHRISTINE C H	DUEKER	1226 OAKVIEW CT		ANOKA	MIN	55303
226-074-19		BURT FAMILY TRUST	6111 S PLEASANT OAK TRL		RENO	NV	89511
226-074-20		HOWARD K H LEUNG & ELLEN W Y LIU 1999 TRUST			RENO	NV	89511
226-074-21	LUKE & CHRISTINE	BRAUD	6113 S PLEASANT OAK TRL		RENO	NV	89511
226-074-22		DECOTA FAMILY TRUST	6115 S PLEASANT OAK TRL		RENO	NV	89511
226-074-23	DENISE	MCLAUGHLAN LIVING TRUST	6117 S PLEASANT OAK TRL		INCLINE VILLAGE	NV	89450
			PO BOX 4724				
226-074-24	DAVID & JULIE	WONG TRUST	6121 S PLEASANT OAK TRL		RENO	NV	89511
226-074-25	CATHERINE E	KAUFER 2023 TRUST	721 MAREWOOD TRL		RENO	NV	89511
226-081-01		MARKHAM FAMILY 2022 TRUST	306 MAREWOOD CT		RENO	NV	89511
226-081-02		MORAN TRUST	300 MAREWOOD CT		RENO	NV	89511
			PO BOX 18127		RENO	NV	89511
226-081-03	GERALD W & FABIOLO A	BAUGHMAN	6145 TRIPLE CROWN DR		RENO	NV	89511
226-081-04	ROGER R	REINKE TRUST	31527 SUNNY BANKS CT		FULSHEAR	TX	77441
226-081-05		DESIMONI TRUST	348 JAMES MCIVER		TRUCKEE	CA	96161
226-081-06	TERRANCE & BEVERLY	RUST FAMILY TRUST	6157 TRIPLE CROWN DR		RENO	NV	89511
226-081-07		KROMER FAMILY TRUST	3690 SUMMIT DR		POCATELLO	ID	83201
226-081-08	LYNN W & TAMARA	KENDELL	6165 TRIPLE CROWN DR		RENO	NV	89511
226-081-09	JAMES R	COLGAN FAMILY TRUST	730 CANTER WAY		RENO	NV	89511
226-081-10		RENO CANTER WAY LLC	728 CANTER WAY		RENO	NV	89511
226-081-11		SKOW/MILLER TRUST	855 MAESTRO DR STE C		RENO	NV	89511
226-081-12		VCH NEVADA LLC			RENO	NV	89511
226-081-13	GUILA D	TURVILLE LIVING TRUST	PO BOX 7097		RENO	NV	89510
				C/O JOHN DERMODY VENTURES ATTN: TONI	RENO	NV	89511
226-082-01		JELINEK FAMILY TRUST	6131 FALABELLA WAY		RENO	NV	89511
226-082-02		IACONIS CAGE TRUST	6135 FALABELLA WAY		RENO	NV	89511

APN	First Name	Last Name	Mailing 1	Mailing 2	City	State	Zip
226-082-04		TOMAC FAMILY TRUST	4445 JUNIPER TRL		RENO	NV	89519
226-082-05	RAJEEV	DEWAN LIVING TRUST	3064 GARIBALDI DR		ROSEVILLE	CA	95747
226-082-06	DAVID & JENNIFER	LEE	6147 FALABELLA WAY		RENO	NV	89511-8
226-082-07		LARIAT BUILDERS LLC	11575 VERAZE DR		RENO	NV	89521
			6155 FALABELLA WAY		RENO	NV	89511
226-082-08	ROBERT C & CHRISTINE M	KAHN LIVING TRUST					
226-082-09	DEAN & STACEY	RICHARDS	2153 JARROD CT		SIMI VALLEY	CA	93063
226-082-10		BERNARD FAMILY TRUST	2500 E LAKERIDGE SHORES		RENO	NV	89519
	MICHAEL K & ALICE E	MCQUONE	7150 SUNRIVER CT		RENO	NV	89523
226-082-12							
226-082-13		GAGNE TRUST	6144 TRIPLE CROWN DR		RENO	NV	89511
226-082-14	MICHAEL C	DERMODY TRUST	4795 CAUGLIN PKWY STE 100		RENO	NV	89519
226-082-15	LESLIE A	DUNN LIVING TRUST	726 MAREWOOD TRL		RENO	NV	89511
226-082-16	YUJIE	MIAO	114 BRIDLEMOOR CT		RENO	NV	89511
226-082-17	KEAN	CHIN et al	114 BRIDLEMOOR CT		RENO	NV	89511
226-082-18							
		KELLER FAMILY TRUST	59 DAMONTE RANCH PKWY # B-215		RENO	NV	89511
226-082-19		R & G TRUST	718 MAREWOOD TRL		RENO	NV	89511
226-091-01		ALONGI FAMILY TRUST	6136 FALABELLA WAY		RENO	NV	89511
226-091-02			11100 SANTA MONICA BLVD STE 1150			CA	90025
		14TH GREEN DRIVE LLC			C/O ET CONSULTANTS - DEBORAH LUTZ MGR	LOS ANGELES	
226-091-03		BEAM FAMILY TRUST	6144 FALABELLA WAY		RENO	NV	89511
226-091-04		BROWN FAMILY LIVING TRUST	6152 FALABELLA WAY		RENO	NV	89511
226-091-05	JON & JOANNE	THOMAS LIVING TRUST	3148 VISTA FAVOLOSO		RENO	NV	89519
226-091-06		AUTUMN IRREVOCABLE TRUST	9101 ALTA DR UNIT 107		LAS VEGAS	NV	89145
226-091-07		BOUTTE MANAGEMENT TRUST	575 LAKESHORE BLVD		INCLINE VILLAGE	NV	89451
226-091-09	PAMELA S	DOLAN FAMILY TRUST	617 SILVER CHARM WAY		RENO	NV	89511
226-091-10	MICHELE C	BROWN 2009 TRUST	340 STOCKTON ST # 1702		SAN FRANCISCO	CA	94108
226-091-11		RANCHARAH MT LLC	9101 ALTA DR # 107		LAS VEGAS	NV	89145
226-091-13		LANDAUER SEPARATE PROPERTY TRUST			RENO	NV	89519
226-091-14	JEFFREY K SCOTT W	FITZPATRICK	4843 ELKCREEK TRL		RENO	NV	89511
226-091-15		JORDAN TRUST	6113 RANCHARAH PKWY 6107 RANCHARAH PKWY		RENO	NV	89511

APN	First Name	Last Name	Mailing 1	Mailing 2	City	State	Zip
226-091-16	PATRICK	NOVAK TRUST	5150 MAE ANNE AVE STE 405 PMB 3018		RENO	NV	89523
226-091-18		BLAYLOCK FAMILY TRUST	748 SOUTH MEADOWS PKWY UNIT A9-338		RENO	NV	89521
226-091-19	DAVID B	CLARK	220 AVENUE I		REDONDO BEACH	CA	90277
226-091-20	PATRICK	NOVAK TRUST	5150 MAE ANN AVE		RENO	NV	89523
226-091-22		RH CUSTOM LLC	600 S ARLINGTON AVE STE 100	C/O MICHAEL MARDIAN	RENO	NV	89509
226-091-23	MICHAEL J	ANDERSON et al	4282 QUEEN AVE S		INNEAPOLI	MIN	55410
226-101-01		COX MCELHINNEY FAMILY TRUST			RENO	NV	89511
226-101-02	LANCE J & JOANNE R	EKLUND FAMILY TRUST	645 BRAIDED ROPE DR		RENO	NV	89511-8
226-101-03		WEBSTER & CURRY LIVING TRUST	641 BRAIDED ROPE DR		RENO	NV	89511
226-101-04		STEPHEN R SMOLAK & JANET L PARRY-SMOLAK FAMILY TRUST	637 BRAIDED ROPE DR		RENO	NV	89511
226-101-05		ALDRICH LIVING TRUST	633 BRAIDED ROPE DR		RENO	NV	89511
226-101-06	PHILIP & KIM	RICH	629 BRAIDED ROPE DR		RENO	NV	89511
226-101-07		ADCOCK/LACHTMAN FAMILY TRUST	6835 WINDY HILL WAY		RENO	NV	89519
226-101-08	BRAD & SUSAN	HOGAN TRUST	4790 CAUGHLIN PKWY # 125		RENO	NV	89511
226-101-09	MICHAEL P	GRATZ et al	617 BRAIDED ROPE DR		RENO	NV	89511
226-101-10		IBANEZ FAMILY TRUST	613 BRAIDED ROPE DR		RENO	NV	89511
226-101-11	ALEX & LUDMILA	POLOVINIKIN	8830 CHAMBRAY RD		ELK GROVE	CA	95624
226-101-12		FLYNN FAMILY TRUST	1334 QUAIL CREEK CIR		SAN JOSE	CA	95120
226-101-14	LINDA S	RUTLEDGE TRUST	11224 PASEO DORADO		PORTER RANCH	CA	91326
226-101-15	CLAUDIA & DAVE	THOMPSON			RENO	NV	89511
226-101-16		GISKO FAMILY TRUST	5533 WESTERN RIDER TRL		LENBROOK	NV	89413
226-101-17		ACKER LIVING TRUST	PO BOX 382		RENO	NV	89511
226-101-18	DONALD C & WANDA	DUNBAR	1155 W HUFFAKER LN		RENO	NV	89511
226-101-19	LYNN A	MARTIN TRUST	5521 WESTERN RIDER TRL		RENO	NV	89511
226-101-20	CARYN COE	SWOBE LIVING TRUST	5517 WESTERN RIDER TRL		RENO	NV	89511
226-101-21	CHRISTI	MATTEONI TRUST	2000 BAY HILL DR		LAS VEGAS	NV	89117
226-101-22		BROWN SURVIVORS TRUST	5509 WESTERN RIDER TRL		RENO	NV	89511
			5505 WESTERN RIDER TRL		RENO	NV	89511
			1013 HARRINGTON WAY		ARMICHAEL	CA	95608

APN	First Name	Last Name	Mailing 1	Mailing 2	City	State	Zip
226-101-23							
		RANCHARRAH COMMUNITY ASSOCIATION	9190 DOUBLE DIAMOND PKWY C/O THE MANAGEMENT TRUST	STE 112 - RENO	RENO	NV	89521
226-102-01	JOHN M & YVETTE M	CHRISTENSEN	5500 DAPPLEGRAY WAY		RENO	NV	89511
226-102-02	KENT & HIMANI	WILLIAMS	5506 DAPPLEGRAY WAY		RENO	NV	89511
226-102-03	FRANK & JOANNE	CELECIA	5512 DAPPLEGRAY WAY		RENO	NV	89511
226-102-04		SMITH FAMILY TRUST	5518 DAPPLEGRAY WAY		RENO	NV	89511
226-102-05	AMY	SCHOEN et al	5524 DAPPLEGRAY WAY		RENO	NV	89511
226-102-06		HECOX/MCKISSON TRUST	1155 MERRILL ST # 308		MENLO PARK	CA	94025
226-102-07	CATHERINE A	CARDWELL et al	5536 DAPPLEGRAY WAY		RENO	NV	89511
226-102-08	FRANCIS P & KAREN A S	NOTZ	5542 DAPPLEGRAY WAY		RENO	NV	89511
226-102-09	FABIO G	REGINATO FAMILY TRUST	5548 DAPPLEGRAY WAY		RENO	NV	89511
226-102-10	S R	NEIL LIVING TRUST	18124 WEDGE PKWY # 508		RENO	NV	89511
226-102-11	SUZANNE	FULLER FAMILY TRUST	5560 DAPPLEGRAY WAY		RENO	NV	89511
226-103-01	BRENDA	SCOLARI	5557 DAPPLEGRAY WAY		RENO	NV	89511
226-103-02	NINAD	BHAMBURDEKAR et al	5545 DAPPLEGRAY WAY		RENO	NV	89511
226-103-03	DENNIS C & SHIRLEY A	GRAY	5530 WESTERN RIDER TRL		RENO	NV	89511
226-103-04	DAVID & DONNA	HUMPHREYS FAMILY TRUST	5526 WESTERN RIDER TRL		RENO	NV	89511
226-103-05		SELLS FAMILY 2006 TRUST	5520 WESTERN RIDER TRL		RENO	NV	89511
226-103-06					RENO	NV	89521
		RANCHARRAH COMMUNITY ASSOCIATION	10509 PROFESSIONAL CIR STE C/O ASSOCIA SIERRA NORTH	200			
226-103-07		ELLIOTT FAMILY TRUST	624 CAMARGUE TRL		RENO	NV	89511
	GARY P & ELIZABETH		620 CAMARGUE TRL		RENO	NV	89511
226-103-08		HEMBREE et al			RENO	NV	89511
226-103-09	EUGENE	MCCABE TRUST	5535 DAPPLEGRAY WAY		RENO	NV	89511
226-104-01	LAURA K	PASEK	611 CAMARGUE TRL		RENO	NV	89511
	TRAVIS & CHRISTINA		13375 ROCK CROSSING DR		RENO	NV	89511
226-104-02		BRANDT			RENO	NV	89511
226-104-03	LESLIE	BERGE	619 CAMARGUE TRL		RENO	NV	89511
226-104-04	KATHLEEN	MILES TRUST	523 S PLYMOUTH CT # 401		CHICAGO	IL	60605
226-104-05	GEORGE	PHIRIPIDIS et al	627 CAMARGUE TRL		RENO	NV	89511
226-104-08	LORI M	JOHNSON LIVING TRUST	622 BRAIDED ROPE DR		RENO	NV	89511

APN	First Name	Last Name	Mailing 1	Mailing 2	City	State	Zip
226-104-09	KATHARINE & ANTONY	THOMAS	4660 ABERFELDY RD		RENO	NV	89519-0
226-104-10	ANGAD S & CHEENU S	SANDHU	10350 GREY HAWK TRL		RENO	NV	89511
226-104-11	TRANG T	NGUYEN	610 BRAIDED ROPE DR		RENO	NV	89511
226-104-12		PRESTON FAMILY TRUST	606 BRAIDED ROPE DR		RENO	NV	89511
226-104-13	CHRISTINE A	SPEED TRUST	602 BRAIDED ROPE DR		RENO	NV	89511
226-111-01	GAIL G	KOESTER	5540 WESTERN RIDER TRL		RENO	NV	89511
226-111-02	JUAN M	TISCARENO	5544 WESTERN RIDER TRL		RENO	NV	89511
226-111-03	ANIL K & HIMABINDU	RAYIDI	5548 WESTERN RIDER TRL		RENO	NV	89511
226-111-04	JOSHUA	BRANCO et al	5554 WESTERN RIDER TRL		RENO	NV	89511
226-111-05	MAX S & DANA D	IANTORNO	5560 WESTERN RIDER TRL		RENO	NV	89511
226-111-06		EVANS 2005 FAMILY TRUST	5566 WESTERN RIDER TRL		RENO	NV	89511
226-112-01	DEBORAH & MICHAEL	BRIZ	5570 WESTERN RIDER TRL		RENO	NV	89511
226-112-02	JAMES B & HEATHER A	ROBERTSON	5574 WESTERN RIDER TRL		RENO	NV	89511
226-112-03	DANNY	NIKOLAI	11542 COLLETT AVE		GRANADA HILLS	CA	91344
226-112-05		ST JEOR FAMILY TRUST	5401 CREMELLO WAY		RENO	NV	89511
226-112-07		ALLISON FAMILY TRUST	5410 CREMELLO WAY		RENO	NV	89511
226-112-10	RICHARD G III & MARGARET A	WATSON	5424 PHILLIPA DR		RENO	NV	89511
226-112-11	MARILYN	TURVILLE TRUST	5428 PHILLIPA DR		RENO	NV	89511
226-112-13	FRANCI	FREE 2020 TRUST et al	1570 LINDA VISTA DR		RENO	NV	89511
226-112-14	RYAN	KOCH et al	5563 WESTERN RIDER TRL		RENO	NV	89511
226-112-15		GREEN TREES TRUST	5559 WESTERN RIDER TRL		RENO	NV	89511
226-112-16	LAWRENCE W & CATHY	STEWART TRUST	5555 WESTERN RIDER TRL		RENO	NV	89511
226-112-17		DODGE LIVING TRUST	5549 WESTERN RIDER TRL		RENO	NV	89511
226-112-18		MCCLUNG TRUST	5545 WESTERN RIDER TRL		RENO	NV	89511
226-112-19	JAMES & DONNA J	DUNSEATH	5541 WESTERN RIDER TRL		RENO	NV	89511
226-112-20	LANA	LITTLE	5404 CREMELLO WAY		RENO	NV	89511
226-112-23		SMITH LIVING TRUST	15870 EDMUND DR		LOS GATOS	CA	95032
226-112-24		TOLL SOUTH RENO LLC	1140 N TOWN CENTER DR STE 250		LAS VEGAS	NV	89144-0

APN	First Name	Last Name	Mailing 1	Mailing 2	City	State	Zip
226-112-25	ANAND	BHEEMAN	5420 PHILLIPA DR		RENO	NV	89511
226-113-01		ROTH TORGAN FAMILY LIVING TRUST	5429 PHILLIPA DR		RENO	NV	89511
226-113-02	SHERRI L & ANTONIO C	ESCOBAR	5425 PHILLIPA DR		RENO	NV	89511
226-113-03	JACOB E	OELSNER et al	115 W SMITH ST		SEATTLE	WA	98119-2
226-113-04	JAMES & ROBIN	BERES TRUST	1079 SAWMILL RD		INCLINE VILLAGE	NV	89451
226-113-05	PHYLLIS E	SASAKI LIVING TRUST	5435 PHILLIPA DR		RENO	NV	89511
226-113-06	NANCY	PODEWILS-BABA et al	6116 S PLEASANT OAK TRL		RENO	NV	89511
226-113-07		DKBK EMPIRE LLC	5485 KIETZKE LN		RENO	NV	89511
226-113-08		RANCHARRAH COMMUNITY ASSOCIATION	947 DOUBLE DIAMOND PKWY STE 17		RENO	NV	89521
226-121-03		NSE CROW LLC	1250 4TH ST FL 5		SANTA MONICA	CA	90401
226-121-06		RENO MAIN LLC	10580 N MCCARRAN BLVD STE 115 399		RENO	NV	89503
226-121-09		RANCHARRAH ESTATES 7 MT LLC	9101 ALTA DR UNIT 107		LAS VEGAS	NV	89145
226-121-10		LYON-NCA DEVCO LLC	4901 BIRCH ST		NEWPORT BEACH	CA	92660
226-121-11		TK421 2023 TRUST	PO BOX 2670		RENO	NV	89505
226-121-16	THOMAS S	DOLAN TRUST	PO BOX 10677		RENO	NV	89511
226-121-17		BAUGHMAN FAMILY TRUST	PO BOX 18127		RENO	NV	89511
226-121-20		NSE LARK LLC	1250 4TH ST FL 5		SANTA MONICA	CA	90401
226-131-02		SAN SEVAINE PROPERTIES LLC	2069 PASEO LUCINDA		SAN DIMAS	CA	91773
226-131-03	DANNY & LINDA	DANELL LIVING TRUST	4728 12TH AVE		HANFORD	CA	93230
226-131-06		TDC VILLAGE LLC	550 W PLUMB LN		RENO	NV	89509
226-131-07		EG RENO 2 LLC	18124 WEDGE PKWY # 1002		RENO	NV	89511
226-141-01	GERALD & KERRI	HANSEN FAMILY TRUST	740 DEL MONTE LN # 16		RENO	NV	89511-7
226-141-04		ACA INVESTMENTS & MANAGEMENT LLC	PO BOX 19293	DEL MONTE #15 SERIES	RENO	NV	89511
226-151-01	JUSTIN L & AMY L T	HORVATH	5400 SIDE SADDLE TRL		RENO	NV	89511
226-151-02	AARON T	WICKSTROM LIVING TRUST	5406 SIDE SADDLE TRL		RENO	NV	89511
226-151-03	DEANNE	SWARTZ	5412 SIDE SADDLE TRL		RENO	NV	89511

APN	First Name	Last Name	Mailing 1	Mailing 2	City	State	Zip
226-151-04	CARMEL	ALLEGO-FITHIAN et al	5454 SIDE SADDLE TRL		RENO	NV	89511
226-151-05	RAUL & PAOLA	HERESI	5424 SIDE SADDLE TRL		RENO	NV	89511
226-151-06	JOHN & KELLY	MANZANARES et al	5430 SIDE SADDLE TRL		RENO	NV	89511
226-151-07	JESIKA & DAVID	HARRELL	5436 SIDE SADDLE TRL		RENO	NV	89511
226-151-08	AMIT & JYOTI	KATARIA et al	513 CYPRESS POINT DR		DAYTON	NV	89403-8
226-151-09		BEEAMAN FAMILY TRUST	5448 SIDE SADDLE TRL		RENO	NV	89511
226-151-11		SYNDERESIS TRUST	5460 SIDE SADDLE TRL		RENO	NV	89511
226-151-12		CASTELLANO-CHEUNG LIVING TRUST	5464 SIDE SADDLE TRL		RENO	NV	89511
226-152-01		BOTANICAL BENEFIT TRUST	5469 SIDE SADDLE TRL		RENO	NV	89511
226-152-02	KEAN K	CHIN et al	5465 SIDE SADDLE TRL		RENO	NV	89511
226-152-03		LONGYEAR FAMILY 2024 TRUST	5461 SIDE SADDLE TRL		RENO	NV	89511
226-152-04		MELLOW FAMILY 1993 TRUST	5457 SIDE SADDLE TRL		RENO	NV	89511
226-152-05	KEGAN	PETERSON	5453 SIDE SADDLE TRL		RENO	NV	89511
226-152-06					LAS VEGAS	NV	89120
226-152-07		RANCHARRAH ESTATE 2023 LLC	3087 E WARM SPRINGS RD STE 100		RENO	NV	89511
226-152-08	COLE H	MARCUS KO & HELEN KO FAMILY LIVING TRUST	5445 SIDE SADDLE TRL 3945 LAMAY CIR		RENO	NV	89511
226-152-09	MADISON L & COREY E	ZANKOWSKI	5437 SIDE SADDLE TRL		RENO	NV	89511
226-152-10	RYAN & CATALINA	COBB FAMILY TRUST	5433 SIDE SADDLE TRL		RENO	NV	89511
226-152-11		CARDWELL FAMILY TRUST	5429 SIDE SADDLE TRL	ATTN: TATIANA CARDWELL	RENO	NV	89511
226-152-12	CHEN	YOUNG et al	5425 SIDE SADDLE TRL		RENO	NV	89511
226-152-13	MATTHEW	HALVORSON	5421 SIDE SADDLE TRL		RENO	NV	89511
226-152-14	ANDREW	HALVORSON	5417 SIDE SADDLE TRL		RENO	NV	89511
226-152-15	YUJIE	MIAO et al	114 BRIDLEMOOR CT		RENO	NV	89511
226-152-16	SIMON	HOSIE et al	1077 TICONDEROGA DR		UNNVYALE	CA	94087
226-152-17	BRETT A & LINDA S	WOLFF FAMILY TRUST	5405 SIDE SADDLE TRL		RENO	NV	89511
226-152-18		SMITH FAMILY TRUST	5401 SIDE SADDLE TRL		RENO	NV	89511
226-152-19					RENO	NV	89521
226-160-01		RANCHARRAH COMMUNITY ASSN	10509 PROFESSIONAL CIR STE C/O ASSOCIA SIERRA NORTH 200		NEWPORT BEACH	CA	92660
226-162-01		RANCHARRAH-RENO VILLAGE D PARTNERS LLC BREEDING FAMILY TRUST	4901 BIRCH ST 18 PERSANO ST		RENO	NV	89511

APN	First Name	Last Name	Mailing 1	Mailing 2	City	State	Zip
226-162-02		LITHGOW FAMILY TRUST	20 PERSANO ST		RENO	NV	89511
226-162-03	RANDALL & KRISTIN	ZUCKERMAN	16 PERSANO ST		RENO	NV	89511
226-162-04	D WAYNE	JAUER et al	14 PERSANO ST		RENO	NV	89511
226-162-05	CAREY T & JOHANNES D	SERFONTEIN	10 PERSANO STREET		RENO	NV	89511
226-162-06	DENNIS & SALLY	RAHLVES 1982 FAMILY TRUST	634 W 2ND ST		RENO	NV	89503
226-162-07	MICHELLE D	KLING	2109 THOMAS JEFFERSON DR		RENO	NV	89509
226-162-08	JAMES & MARY P	HAWKINS 18 FAMILY TRUST	6939 N CACTUS WREN CT		PARADISE VALLEY	AZ	85253
226-162-09		BAUGHMAN LIVING TRUST	PO BOX 18127		RENO	NV	89511
226-162-10		TK421 2023 TRUST	100 W LIBERTY ST FL 10	C/O MCDONALD CARANO ATTN: ROBERT ARMSTRONG	RENO	NV	89501
226-162-11	DAVID O & MIRANDA	ROBERTS FAMILY TRUST	67 CABALLADA ST		RENO	NV	89511
226-162-12	JAMES W & EARLENE	FORSYTHE TRUST	65 CABALLADA ST		RENO	NV	89511
226-162-13		QTIP TRUST	68 CABALLADA ST		RENO	NV	89511
226-162-14		MAKAHIKI HOU TRUST	66 CABALLADA ST		RENO	NV	89511
226-162-15	JANET B	FLYNN et al	70 CABALLADA ST		RENO	NV	89511
226-162-16	JORGEN A & DORIS	ERTING	72 CABALLADA ST		RENO	NV	89511
226-162-17		BAUMGARDNER FAMILY TRUST	69 CABALLADA ST		RENO	NV	89511
226-162-18		LOVAS TRUST	71 CABALLADA ST		RENO	NV	89511
226-162-19		FREITAS FAMILY TRUST	38 CAMPOLINA ST		RENO	NV	89511
226-162-20	INDIA	VANNINI	40 CAMPOLINA ST		RENO	NV	89511
226-162-22	KATHLEEN A	ZIMMERMAN LIVING TRUST et al	41 CAMPOLINA ST		RENO	NV	89511
226-162-23		FLOCCHINI LIVING TRUST	36 CAMPOLINA ST		RENO	NV	89509
226-162-24		G & M FAMILY TRUST	34 CAMPOLINA ST		RENO	NV	89511
226-162-25	THEODORE B	BERNDT FAMILY TRUST	37 CAMPOLINA ST		RENO	NV	89511
226-162-26		REDFERN FAMILY 2005 TRUST	35 CAMPOLINA ST		RENO	NV	89511
226-162-27	DANIEL J	NIKOLAI et al	11542 COLLETT AVE		GRANADA HILLS	CA	91344
226-162-29	DANIEL P & SUZANNE S	OSTER	2455 DUBLIN CT		RENO	NV	89509-3
226-162-30		SWALL FAMILY TRUST	32 CAMPOLINA ST		RENO	NV	89511
226-163-01		KERRIGAN FAMILY LIVING TRUST	75 CABALLADA ST		RENO	NV	89511

APN	First Name	Last Name	Mailing 1	Mailing 2	City	State	Zip
226-163-02	H & K	MCMURRAY 2000 TRUST	73 CABALLADA ST		RENO	NV	89511
226-163-03	KAMA J & MICHAEL A	BEST	76 CABALLADA ST		RENO	NV	89511
226-163-04	JOHN & CORINNE	KIEFER JOINT TRUST	74 CABALLADA ST		RENO	NV	89511
226-163-29		PROVIDENCE TRUST	200 S VIRGINIA ST STE 400	C/O DUNHAM TRUST CO	RENO	NV	89501
226-163-31	BRIAN & NANCY	KENNEDY LIVING TRUST	4790 CAUGHLIN PKWY # 501		RENO	NV	89519
226-171-03		SIERRA ORAL SURGERY PARTNERS LLC	255 GLENDALE AVE STE 3		SPARKS	NV	89431
226-171-05		YETIS LLC	900 SCHELLBOURNE ST		RENO	NV	89511
Agent		Wood Rodgers	1361 Corporate Blvd	ATTN: Andy Durling	RENO	NV	89502
NV			901 S. Stewart Street, Ste 5003	Division of Lands	Carson City	NV	89701
US-01		State of Nevada			Santa Ana	CA	92701
		United States of America Dept of Housing and Urban Development		Attn: Ramiro Delgado			
US-02		United States of America	34 Civic Center Plaza	Bureau of Land Management	Carson City	NV	89701
Ward 2 NAB	Mimi	Fuji-Strickler	835 Huffaker Estates Cir		RENO	NV	89511
Ward 2 NAB	Donna	Keats	2265 Sunrise Dr		RENO	NV	89509
Ward 2 NAB	Stacey	Shinn	4932 Meadow Springs Dr		RENO	NV	89509
Ward 2 NAB	Stan	Dowdy	2700 Plumas St #302		RENO	NV	89509
Ward 2 NAB	David	Titzel	2170 Humboldt St		RENO	NV	89509
Ward 2 NAB	Audrey	Keller	720 Marewood Trail		RENO	NV	89511
Ward 2 NAB	Hal	Taylor	2251 W Lakeridge Shores		RENO	NV	89519
Ward 2 NAB	Patrick	Fisher	6400 Bonde Farms Lane		RENO	NV	89511
Ward 2 NAB	Roman	Schomberg	660 Caspian Ct		RENO	NV	89521
Ward 2 NAB	Sean	McCoy	1785 Sandpoint Circle		RENO	NV	89509
Ward 2 NAB	Kristen	Montan	3095 Lakeside Dr. #302		RENO	NV	89509
Ward 2 NAB	James	Cashell	4847 Lakeridge Terrace W		RENO	NV	89509
Ward 2 NAB	Michael	Ginsburg	4690 Sommerville Way		RENO	NV	89519
WC-01		Washoe County Public Works	1001 E 9th St		RENO	NV	89520
WC-02		Washoe County Comm. Dev.	1001 E 9th St	c/o Mojra Hauenstein	RENO	NV	89520
WC-03		Washoe County Treasurer	PO Box 30039		RENO	NV	89520
WC-04		Washoe Co Assessor's	1001 E 9th St		RENO	NV	89520

Report Totals

APN	First Name	Last Name	Mailing 1	Mailing 2	City	State	Zip
Count: 598							
Date Exported: 4/16/2025 8:14 AM							

PIN (Count): 598



CITY OF RENO PRINT ORDER FORM

Job Name : LDC25-00037 (Rancharrah PUD Handbook Amendment & MPA)

Contact Information (required fields):

Name: LAUREN MORRIS

Date File is Available: 4/17/2025

Dept/Division: CITY CLERKS OFFICE

Date Order Due: 4/22/2025

Contact Phone #: 775-334-2030

Contact Email: CITYCLERK@RENO.GOV

0371-7400-6000-

PRODUCTION

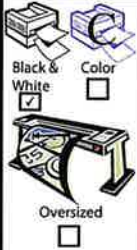

Copies

598

Sides

SS

DS

Page Size

8.5 X 11 ☐ 8.5 X 14 ☒ 11 X 17 ☐

Paper Type & Color:

Paper Color:

Blue

Paper Weight:

Pastel	Available Sizes & Weights	Prights (letter size only)	Available Weights
Blue	Letter, Legal, & Cardstock	Cosmic Orange	24 lb & cardstock
Green	Letter, Legal, & Cardstock	Gamma Green	24 lb
Ivory	Letter, Legal, & Cardstock	Life-Off Lemon	24 lb
Yellow	Letter, Cardstock	Lunar Blue	24 lb & cardstock
Pink	Letter, Legal	Planetary Purple	24 lb
Goldenrod	Letter, Legal	Pulsar Pink	24 lb
Buff	Letter	Re-Entry Red	24 lb & cardstock
Lilac	Letter	Solar Yellow	24 lb & cardstock
Salmon	Letter	Terra Green	24 lb & cardstock

* Other paper options are available, please specify in Special Instructions

Collated

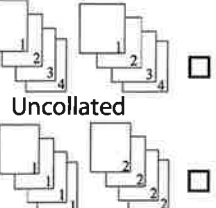

Uncollated

Binding



Binding:

☐ Comb Bind

☐ Coil Bind

☐ Tape Bind

Binding color (pick one): navy

☐ Front cover:

☐ Clear

☐ Regency

☐ Cardstock

Color: navy

☐ Back cover:

☐ Clear

☐ Regency

☐ Cardstock

Color: navy

☐ 3-ring Binder

Size:

Color: navy

FINISHING

Laminate/ Mount

Laminating



☐ Glossy
☐ Matte

Pouch Size

8.5 X 11 ☐ 8.5 X 14 ☐ 11 X 17 ☐

Mounting

MNT ☐ MNT & L ☐

☐ Foam

Carbonless paper:

☐ 2-part

☐ 3-part

☐ 4-part

☐ Color

☐ BW

Finish

STAPLING

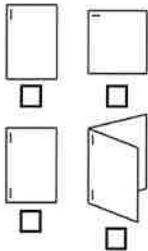

FOLDING

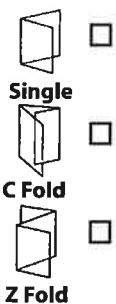

CUTTING

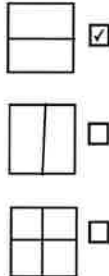

DRILLING

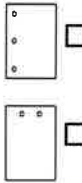

PADS

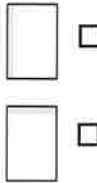

How many pads?

Pages per pad:

SHRINKWRAP



TABS



Tab Font

Tab Text

1. _____
2. _____
3. _____
4. _____
5. _____
6. _____
7. _____
8. _____
9. _____
10. _____

Special Instructions

BLUE POSTCARDS - DELIVERED TO RENO CITY HALL, 2ND FLOOR CLERKS OFFICE BY TUESDAY, APRIL 22, 2025, AT 10 AM.

THANK YOU!